

Excellent Integrated System Limited

Stocking Distributor

Click to view price, real time Inventory, Delivery & Lifecycle Information:

[Bel Fuse Inc.](#)
[937-SP-3026-4](#)

For any questions, you can email us directly:
sales@integrated-circuit.com

DATE	REV	ECN	APP'D. BY
2-1-06	D2	7460	JM
5-22-12	D3	9471	SMN
1-5-15	D4	10165	TRM

B

B

A

A

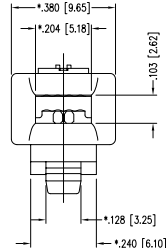
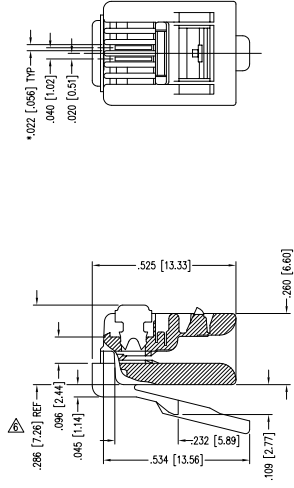
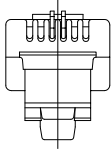

NOTES:
 1- PLUG KIT CONSISTS OF :
 PRE-INSERTED PLUG HOUSING
 2- MATERIALS :
 FRONT HOUSING PLASTIC : CLEAR POLYCARBONATE, UL 94-V0
 CONTACTS : PHOSPHOR BRONZE, SELECTIVE GOLD PLATING
 3- CONTACTS TERMINATE STRANDED CONDUCTORS UP
 TO .037 [.0.94] OUTSIDE DIAMETER OF INSULATION.
 4- FOR PRODUCT SPECIFICATION SEE PRO26-01.
 5- TOLERANCES COMPLY WITH F.C.C. DIMENSION REQUIREMENTS.
 Δ TERMINATED PLUG HEIGHT: .237 [.6.02] ±.005 [.0.13]

BULK	50 MICRO-INCHES [1.27um]	937-SP-3026-4
PACKAGE	CONTACT PLATING IN MATING AREA	PART NUMBER

THIRD ANGLE PROJECTION	 11118 Susquehanna Trail South Gen Rock, PA 17327-9199 (717) 235-7512 http://www.stewartconnector.com
DO NOT SCALE DRAWING DRAWING IS SUBJECT TO CHANGE WITHOUT NOTICE	
DIMENSIONS: INCHES (METRIC)	TITLE: TWO CONDUCTOR/SIX POSITION LINE CORD MODULE; DRN BY: KRL DATE: 2/1/06 APP'D BY: JM DATE: 2-1-06 DWG NO: CT300029 REV: D4



REV. 7/3/03