

## **Excellent Integrated System Limited**

Stocking Distributor

Click to view price, real time Inventory, Delivery & Lifecycle Information:

[Hirose Electric Co Ltd](#)  
[TM31P-TM-88P\(02\)](#)

For any questions, you can email us directly:

[sales@integrated-circuit.com](mailto:sales@integrated-circuit.com)

2013/08/14 00:35:46 ctanke

DRAWING FOR REFERENCE: This is subject to change without notice

APPLICABLE STANDARD		ANSI/TIA/EIA-568-B.2.10 CAT6a			
RATING	OPERATING TEMPERATURE RANGE	① -25 °C TO 60 °C	STORAGE TEMPERATURE RANGE	-25 °C TO 60 °C	
	VOLTAGE	125 V AC	OPERATING HUMIDITY RANGE	95 % MAX	
	CURRENT	1 A	APPLICABLE CABLE	—	
<b>SPECIFICATIONS</b>					
ITEM	TEST METHOD		REQUIREMENTS	QT	AT
<b>CONSTRUCTION</b>					
GENERAL EXAMINATION	VISUALLY AND BY MEASURING INSTRUMENT.		ACCORDING TO DRAWING.	X	X
MARKING	CONFIRMED VISUALLY.			X	X
① THE OPERATION TEMPERATURE INCLUDES THE TEMPERATURE RISE BY CURRENT CARRYING. ② TEMPERATURE RANGE FOR A CONNECTOR UNMATED. ③ USE UNDER THE CONDITION RECOMMENDED BY A CABLE MANUFACTURE.					
	COUNT	DESCRIPTION OF REVISIONS	DESIGNED	CHECKED	DATE
△					
REMARK			APPROVED	YH. ENAMI	09.06.02
			CHECKED	YH. ENAMI	09.06.02
			DESIGNED	MT. ITANO	09.06.02
Unless otherwise specified, refer to JIS C 5402.			DRAWN	MT. ITANO	09.06.02
Note QT:Qualification Test AT:Assurance Test X:Applicable Test			DRAWING NO.		ELC4-126868-02
<b>HRS</b>	SPECIFICATION SHEET		PART NO.	TM31P-TM-88P (02)	
	HIROSE ELECTRIC CO., LTD.		CODE NO.	CL222-4626-7-02	△ 1/1

2013/08/14 00:35:47 ctanke

DRAWING FOR REFERENCE: This is subject to change without notice

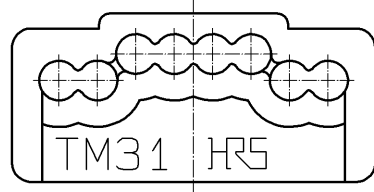
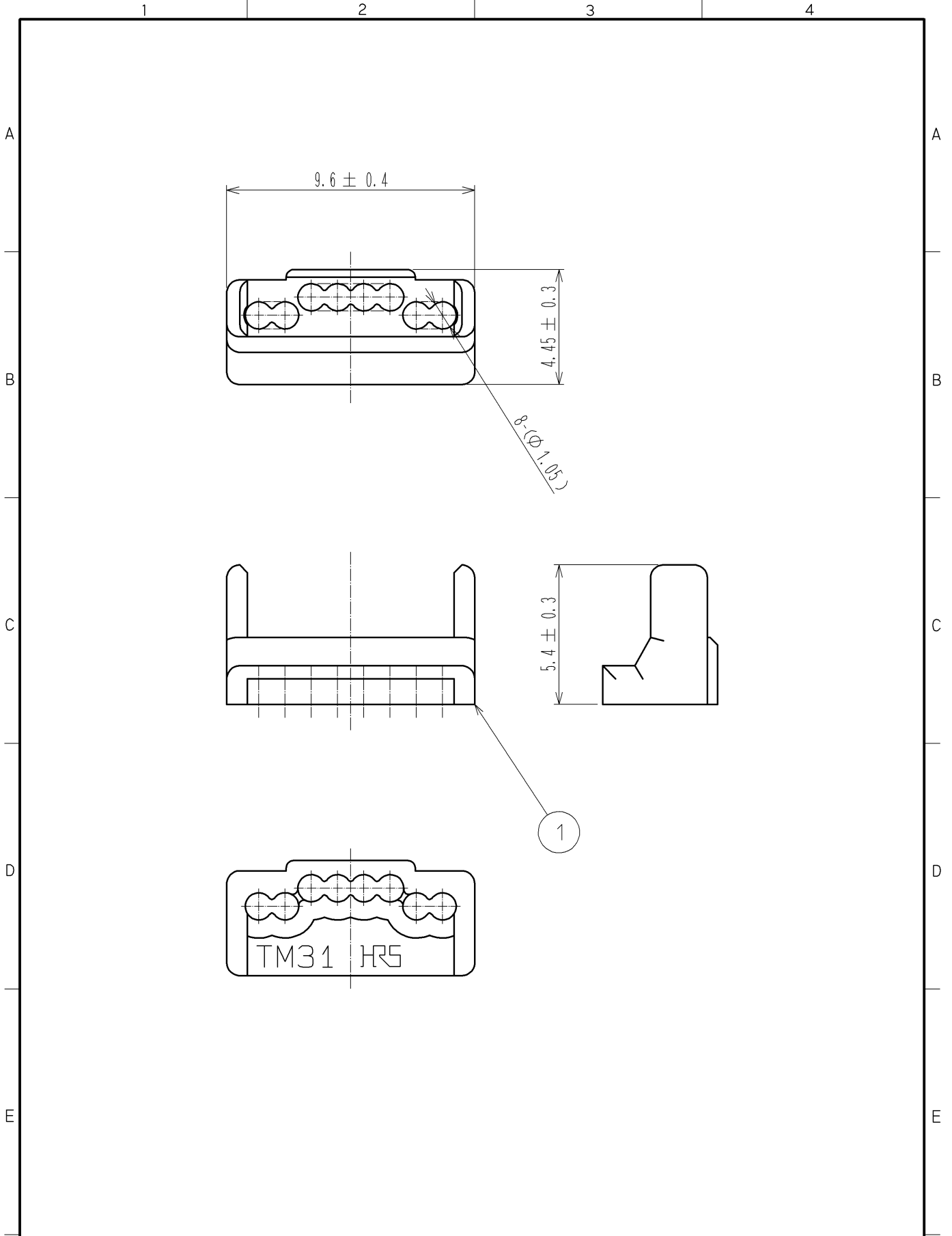

1	POLYCARBONATE	(YELLOW)UL94V-2					
NO.	MATERIAL	FINISH , REMARKS	NO.	MATERIAL	FINISH , REMARKS		

UNITS mm		SCALE 5 : 1	COUNT 	DESCRIPTION OF REVISIONS	DESIGNED	CHECKED	DATE
-------------	--	----------------	-----------	--------------------------	----------	---------	------

HIROSE ELECTRIC CO., LTD.	APPROVED : YH. ENAMI	09. 06. 02	DRAWING NO.	EDC3-126868-02
	CHECKED : YH. ENAMI	09. 06. 02	PART NO.	TM31P-TM-88P(02)
	DESIGNED : MT. ITANO	09. 06. 02	CODE	