

## **Excellent Integrated System Limited**

Stocking Distributor

Click to view price, real time Inventory, Delivery & Lifecycle Information:

[Hammond Manufacturing](#)  
[1591XXLSBK](#)

For any questions, you can email us directly:

[sales@integrated-circuit.com](mailto:sales@integrated-circuit.com)

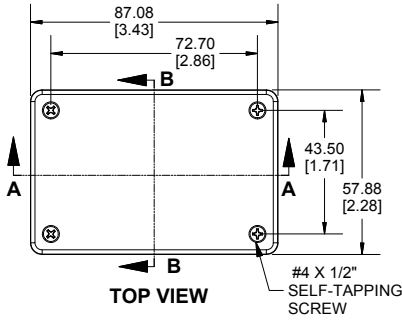

**TOP VIEW**

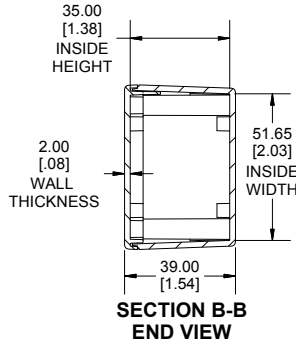

**SECTION B-B  
END VIEW**

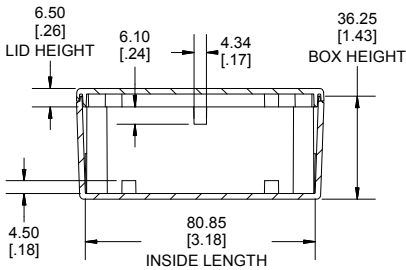
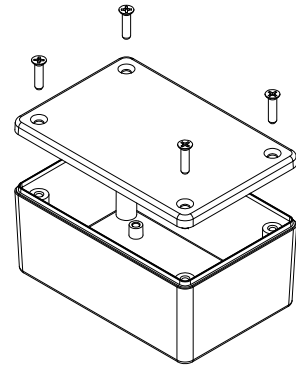

**SECTION A-A  
SIDE VIEW**

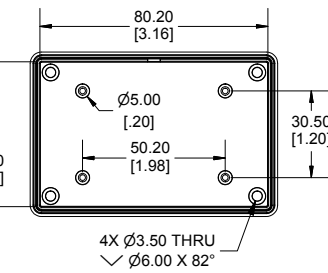
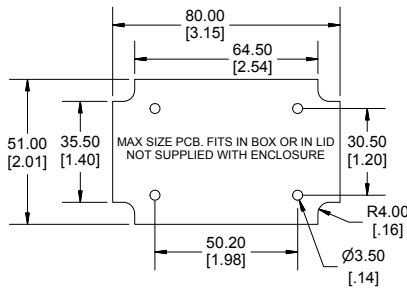

**INSIDE LID**

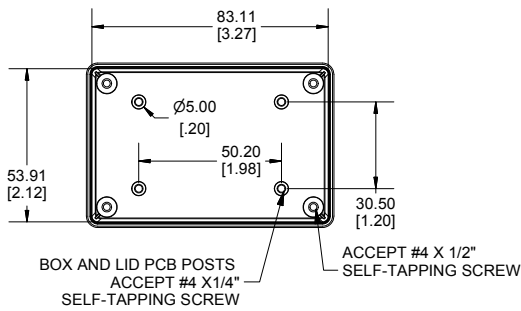

**INSIDE BOX**

Enclosures can be Factory Modified ( Milling, Drilling, Printing etc.)  
Contact Factory [mjm@hammondmfg.com](mailto:mjm@hammondmfg.com) for quotes  
Solid models of this enclosure available in STEP or IGES.  
(Part number and text placement/orientation on our products are subject to change, we do not recommend using them as a locating reference for modification purposes)

NOTE	
Purchased assembly includes box, lid and Enclosure molded from GPABS Plastic.	
Other materials / colours available consult factory.	
Recommended Torque : (35-43) Ozf.in / (25-30) cNm	

PART NUMBERS	
1591XXLS Enclosure	
Black Textured Enclosure	1591XXLSBK
ACCESSORIES	
Black Cover Screws #4 X 1/2" SelfTapping	1591TS100BK (Pkg 100)
Plated Cover Screws #4 X 1/2" SelfTapping	1591TS100 (Pkg 100)
P.C. Board Screws (#4 x 1/4" selfTapping (6.4mm))	1593ATS50 (Pkg 50)
	1593ATS100 (Pkg 100)



**HAMMOND  
MANUFACTURING.**  
**1591XXLS**  
www.hammondmfg.com

Dimensions:  
mm  
[inches]