

Excellent Integrated System Limited

Stocking Distributor

Click to view price, real time Inventory, Delivery & Lifecycle Information:

[Molex Connector Corporation](#)
[0039000126](#)

For any questions, you can email us directly:

sales@integrated-circuit.com

NOTES:

1. MATERIAL:
A. BRASS.
B. PHOS. BRONZE.
2. PLATING:
.000100/(.00254) MIN. TIN OVER .000050/(.00127) MIN. NICKEL (POST-PLATE).
3. PRODUCT SPECIFICATION: PS-5556-001, PS-5556-002, PS-5556-003
4. PACKAGING SPECIFICATION: PK-5558-001 FOR REELS
PK-5556-003 FOR LOOSE
5. MATES WITH TERMINAL: 5556 SERIES
6. TERMINAL IS FOR USE WITH MOLEX PLUG HOUSINGS 5559, 30068, AND 42475.
7. THE NUMBER OF SERRATIONS TO BE ONE FOR WIRE RANGE 22-28.
8. MEASURING POINT FOR PLATING THICKNESS.
9. WHEN TERMINALS ARE INSTALLED IN THE HOUSING THE WIRES ARE TO BE DRESSED IN SUCH A MANNER TO ALLOW THE TERMINALS TO FLOAT FREELY IN THE POCKET.
10. THIS TERMINAL IS DESIGNED FOR SINGLE WIRE CRIMPING.
11. PART CONFORMS TO CLASS "B" REQUIREMENTS OF COSMETIC SPECIFICATION PS-45499-002.

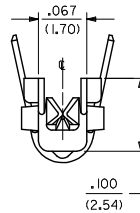
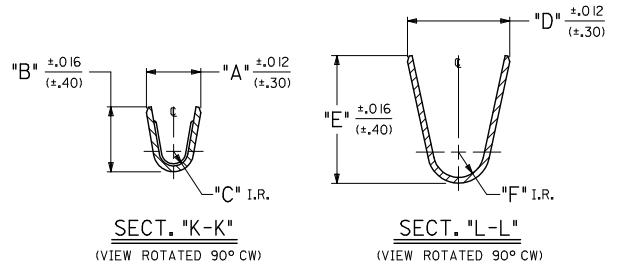
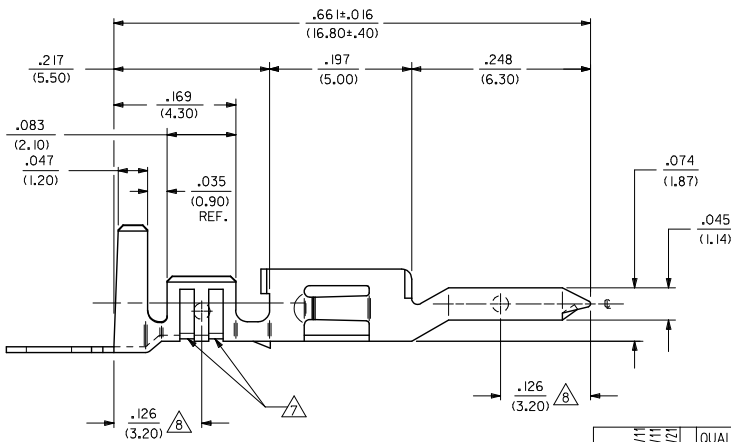
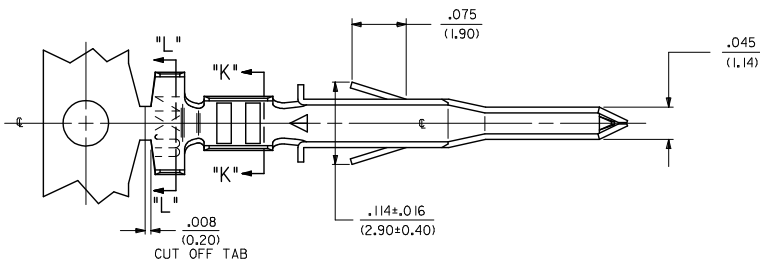

UPDATE NOTES EC NO: UCP2014-3293 DRAWING DATE: 2014/02/11 CHKD: BELL 2014/02/11 APPR: SMITH 2014/03/21	QUALITY SYMBOLS ∇=0 ∇=0 ∇=0	GENERAL TOLERANCES (UNLESS SPECIFIED)		DIMENSION STYLE IN/MM		SCALE	DESIGN UNITS INCH	THIRD ANGLE PROJECTION
		mm	INCH	DRAWN BY	DATE	TITLE		
		4 PLACES ±---	±---	NGUYEN	2014/02/11	MALE CRIMP TERMINAL WITH TIN-OVER-NICKEL PLATING. (MINI-FIT JR. SERIES) molex		
		3 PLACES ±---	±.010	CHECKED BY	DATE			
2 PLACES ±.25	±.015	GEP	1992/05/12					
1 PLACE ±.38	±---	APPROVED BY	DATE					
0 PLACE ±---	±---	FSMITH	2014/03/21	MATERIAL NO.	DOCUMENT NO.	SHEET NO.		
ANGULAR ±1/2°		DRAFT WHERE APPLICABLE MUST REMAIN WITHIN DIMENSIONS		SEE SHEET 2		SD-5558-*S*	1 OF 2	
THIS DRAWING CONTAINS INFORMATION THAT IS PROPRIETARY TO MOLEX INCORPORATED AND SHOULD NOT BE USED WITHOUT WRITTEN PERMISSION								

PART NO.	ENG. NO.	FORM	MAT'L	WIRE GAGE	RANGE OF INSULATION DIA.	QUANTITY PER REEL (FORMED)	DIM. "A"	DIM. "B"	DIM. "C"	DIM. "D"	DIM. "E"	DIM. "F"			
39-00-0120	5558-S	CHAIN	A	18-24 GA.	.051-.122 (1.30-3.10)	4,000	.075 (1.90)	.091 (2.30)	.020 (.50)	.142 (3.60)	.177 (4.50)	.035 (.90)			
39-00-0121	5558-SL	LOOSE					22-28 GA.	.035-.071 (.90-1.80)	6,000	.071 (1.80)	.065 (1.65)	.016 (.40)	.091 (2.30)	.091 (2.30)	.024 (.60)
39-00-0122	5558-S2	CHAIN								16 GA.	.122 MAX. (3.10)	4,000	.091 (2.30)	.106 (2.70)	.024 (.60)
39-00-0123	5558-S2L	LOOSE		18-24 GA.	.051-.122 (1.30-3.10)	4,000	.075 (1.90)	.091 (2.30)	.020 (.50)				.142 (3.60)	.177 (4.50)	.035 (.90)
39-00-0124	5558-S3	CHAIN					22-28 GA.	.035-.071 (.90-1.80)	6,000				.071 (1.80)	.065 (1.65)	.016 (.40)
39-00-0125	5558-S3L	LOOSE		16 GA.	.122 MAX. (3.10)	4,000				.091 (2.30)	.106 (2.70)	.024 (.60)	.142 (3.60)	.177 (4.50)	.035 (.90)
39-00-0126	5558-PBS	CHAIN	18-24 GA.							.051-.122 (1.30-3.10)	4,000	.075 (1.90)	.091 (2.30)	.020 (.50)	.142 (3.60)
39-00-0127	5558-PBSL	LOOSE					22-28 GA.	.035-.071 (.90-1.80)	6,000			.071 (1.80)	.065 (1.65)	.016 (.40)	.091 (2.30)
39-00-0128	5558-PBS2	CHAIN	16 GA.	.122 MAX. (3.10)	4,000	.091 (2.30)				.106 (2.70)	.024 (.60)	.142 (3.60)	.177 (4.50)	.035 (.90)	
39-00-0129	5558-PBS2L	LOOSE				18-24 GA.				.051-.122 (1.30-3.10)	4,000	.075 (1.90)	.091 (2.30)	.020 (.50)	.142 (3.60)
39-00-0130	5558-PBS3	CHAIN					22-28 GA.	.035-.071 (.90-1.80)	6,000			.071 (1.80)	.065 (1.65)	.016 (.40)	.091 (2.30)
39-00-0131	5558-PBS3L	LOOSE	16 GA.	.122 MAX. (3.10)	4,000	.091 (2.30)				.106 (2.70)	.024 (.60)	.142 (3.60)	.177 (4.50)	.035 (.90)	

LEGEND:

5558-***S**

- BASE NO. _____
- MATERIAL _____
- BLANK= BRASS
- PB= PHOS. BRONZE
- S= TIN OVER NICKEL
- CRIMP SIZE _____
- BLANK = 18-24 AWG
- 2 = 22-28 AWG
- 3 = 16 AWG
- CHAIN OR LOOSE _____
- BLANK= CHAIN
- L= LOOSE

SEE SHEET 1 EC NO: UCP2014-3293 DRAWN BY: NGUYEN CHKD: BELL APPR: SMITH DATE: 2014/02/11 DATE: 2014/02/11 DATE: 2014/03/21	QUALITY SYMBOLS ∇=0 ∇=0 ∇=0	GENERAL TOLERANCES (UNLESS SPECIFIED)		DIMENSION STYLE IN/MM		SCALE 1:1	DESIGN UNITS INCH	THIRD ANGLE PROJECTION	
		4 PLACES ± --- ± ---	mm	INCH	DRAWN BY	DATE	TITLE MALE CRIMP TERMINAL WITH TIN-OVER-NICKEL PLATING. (MINI-FIT JR. SERIES) MATERIAL NO. _____ DOCUMENT NO. SD-5558-*S* SHEET NO. 2 OF 2		
		3 PLACES ± --- ± .010			CHECKED BY	DATE			
		2 PLACES ± .25 ± .015			GEP	1992/05/12			
1 PLACE ± .38 ± ---			APPROVED BY	DATE					
0 PLACE ± --- ± ---			FSMITH	2014/03/21					
ANGULAR ±1/2°		DRAFT WHERE APPLICABLE MUST REMAIN WITHIN DIMENSIONS		SEE CHART					
THIS DRAWING CONTAINS INFORMATION THAT IS PROPRIETARY TO MOLEX INCORPORATED AND SHOULD NOT BE USED WITHOUT WRITTEN PERMISSION									