

Excellent Integrated System Limited

Stocking Distributor

Click to view price, real time Inventory, Delivery & Lifecycle Information:

[Molex Connector Corporation](#)
[0359229002](#)

For any questions, you can email us directly:

sales@integrated-circuit.com

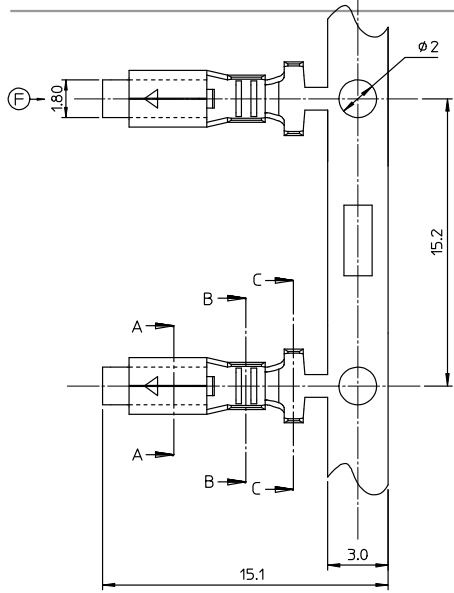

NOTES

1. MATERIAL : BRASS or PHOSPHOR BRONZE
2. FINISHES : PRE-TIN PLATED
3. PRODUCT SPECIFICATION : PS-35978-001
4. APPLIED HOUSING : 35977-***0*

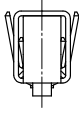

VIEW F

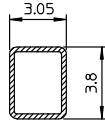

SECTION A-A

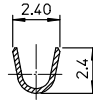

SECTION B-B

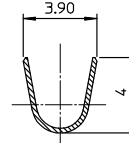

SECTION C-C

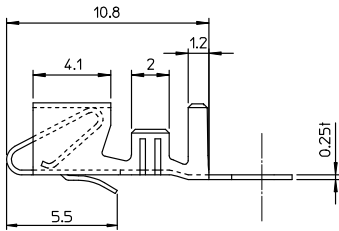

TABLE

359228011	35922-8011	PHOSPHOR BRONZE
359229002	35922-9002	BRASS
MAT'L NO.	ENG NO.	MATERIAL

REVISED EC NO: KOR2008-0186 DRWNS:KHAN01 2008/05/26 CHKDY: YANG 2008/05/26 APPR: YUNSIKKIM 2008/05/26	QUALITY SYMBOLS ▽=0 ▽=0	GENERAL TOLERANCES (UNLESS SPECIFIED)		DIMENSION STYLE MM ONLY		SCALE 5:1	DESIGN UNITS METRIC	THIRD ANGLE PROJECTION
			mm	INCH	DRAWN BY	DATE	TITLE 3.96 PITCH W-T-B CONN. TERMINAL	
		4 PLACES	±---	±---	YURIWI	1999/05/09		
		3 PLACES	±---	±---	CHECKED BY	DATE		
2 PLACES	±---	±---	J. K. OH	1999/05/09				
			1 PLACE	±0.2	±---	APPROVED BY	DATE	MOLEX INCORPORATED
		ANGULAR ± 2 °		CWLEE	1999/05/09	MATERIAL NO.	DOCUMENT NO.	
DRAFT WHERE APPLICABLE MUST REMAIN WITHIN DIMENSIONS		SEE TABLE				SD-35922-500	SHEET NO.	
		SIZE A3		THIS DRAWING CONTAINS INFORMATION THAT IS PROPRIETARY TO MOLEX INCORPORATED AND SHOULD NOT BE USED WITHOUT WRITTEN PERMISSION				