

## Excellent Integrated System Limited

Stocking Distributor

Click to view price, real time Inventory, Delivery & Lifecycle Information:

[Dialight](#)  
[5510003806F](#)

For any questions, you can email us directly:  
[sales@integrated-circuit.com](mailto:sales@integrated-circuit.com)

REV.	ECN NO.	REVISIONS	DRN.	CKD.	APP.	DATE
A		NEW RELEASE	LR		N.O.	4-22-96
B		GREEN LED FWD VOLT. TYP 2.1, MAX 2.8 WAS 2.3; 3.0 & ADDED TEST COND.: LUM. INT. MIN 4.7 TYP 12.6 WAS 4.0, 8.5; YELLOW LED FWD VOLT. TYP 2.1, MAX 2.8 WAS 2.3; 3.0; PEAK WAVELENGTH 505 WAS 583; LUM. INT. MIN 7.4 WAS 6.0; ADDED NOTE 3; Ø.118 WAS Ø.115.			TC	

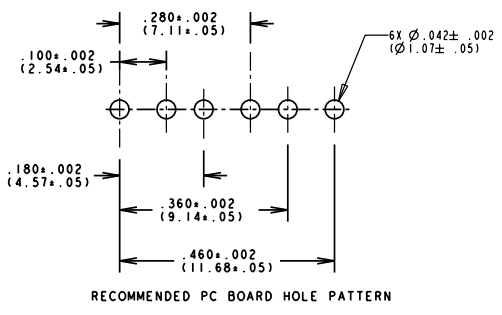
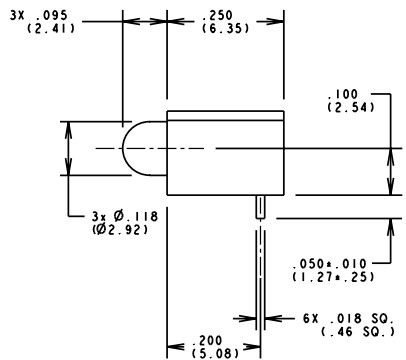
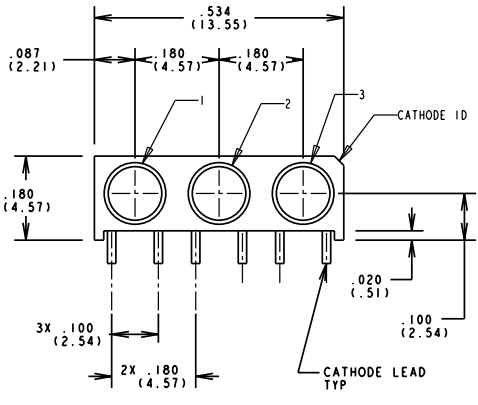

- NOTE:
- LED LEAD DIMENSIONS ARE MEASURED AT HOUSING EXIT.
  - MILLIMETER DIMENSIONS SHOWN FOR REFERENCE ONLY.
  - DIALIGHT PART NUMBER: 551-0003-806, 551-0003-807.

OPERATING CHARACTERISTICS AT T<sub>A</sub> = 25°C

SYMBOL	PARAMETER	COLOR	MIN	TYP	MAX	UNITS	TEST COND.
V <sub>F</sub>	FORWARD VOLTAGE	YELLOW GREEN		2.1 2.1	2.8 2.8	V	I <sub>F</sub> = 20 mA
V <sub>R</sub>		ALL	5			V	I <sub>R</sub> = 100µA
λ <sub>PK</sub>	PEAK WAVELENGTH	YELLOW GREEN		585 565		nm	MEASURED AT PEAK
I <sub>V</sub>	LUMINOUS INTENSITY	YELLOW GREEN	7.4 4.7	10.0 12.6		mc d	I <sub>F</sub> = 10 mA

PART NUMBER	POS. 1	POS. 2	POS. 3
551-0003-806	GREEN	YELLOW	GREEN
551-0003-807	YELLOW	GREEN	YELLOW

THIS DRAWING AND THE CONTENTS HEREIN ARE CONFIDENTIAL AND THE SOLE PROPERTY OF DIALIGHT. REPRODUCTION OF THIS DRAWING OR CONSTRUCTION OF ANY PARTS WITHIN THIS DRAWING ARE FORBIDDEN WITHOUT THE WRITTEN CONSENT OF DIALIGHT.

SCALE 5:1

DRAWING NUMBER	REV
C-16086	B

TITLE

MATERIAL

ANGLES: ±3°

FINISH:

FSCM 83330

1913 ATLANTIC AVE.  
MANASQUAN, N.J. 08736

SHEET OF FAMILY TABLE: