

Excellent Integrated System Limited

Stocking Distributor

Click to view price, real time Inventory, Delivery & Lifecycle Information:

[Memory Protection Devices](#)
[BA9VPC](#)

For any questions, you can email us directly:

sales@integrated-circuit.com

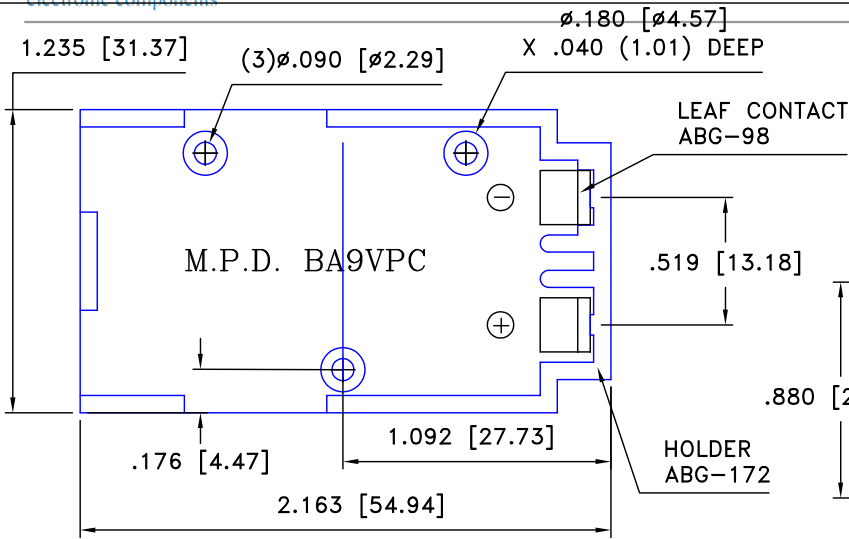

Date	SYM	REVISION RECORD	AUTH	DR.	CK.
09/13/03	A	ADDED MOUNTING INSTRUCTION	T.B.	B.S.	
09/20/03	B	ADDED DIM. ∅.180 x .040 DEEP	T.B.	B.S.	
05/01/04	C	ADDED DIM. ∅.176 AND 1.092 (UPDATED CONTACT MATERIAL)	T.B.	B.S.	
10/28/06	D	ADDED "ROHS COMPLIANT"	T.B.	B.S.	

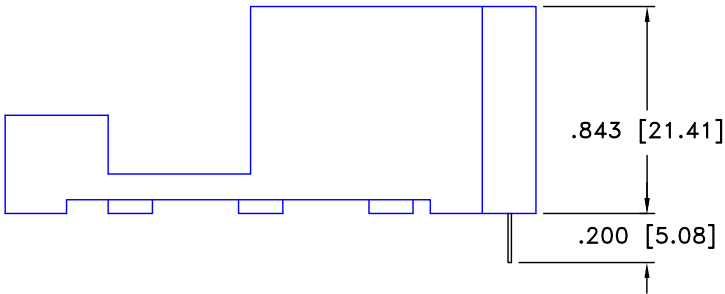
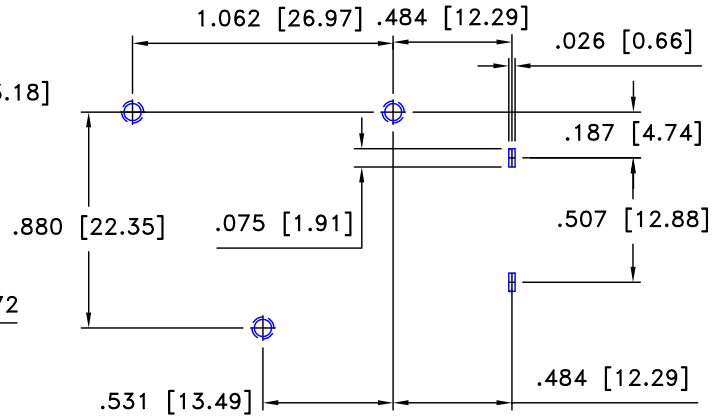

PCB LAYOUT

MOUNTING INSTRUCTION:
 USE 2-56 MACHINE SCREWS OR EYELETS 0.089" OD BY 0.15" FLANGE
 STIMPSON GS-3 SERIES OR EQUIVALENT
 ALSO ADHESIVES AND DOUBLE SIDED TAPES WORK WELL.

NOTE:
 ROHS COMPLIANT

FEATURES REVERSE POLARITY PROTECTION

Tolerance (Except as noted)	Memory Protection Devices, Inc 200 Broad Hollow Road, Farmingdale, New York 11735		
decimal		Scale	Drawn By T.S.
±.5 (.020)		2=1	Approved By T.B.
Fractional	Title		
±.8 (.030)	BA 9V PC ASSEMBLY		
Angular	Date	Drawing Number	
± 3°	10/28/06	BA9VPC	

QTY REQ'D	PART NO.	DESCRIPTION	MATERIAL
1	ABG-172	BA 9V PC HOLDER	HIGH IMPACT ABS BLACK, UL940-0 File No.E56070(S)
2	ABG-98	BC 9V PC LEAF CONTACT	PHOSPHOR BRONZE, .012" THICK NICKEL PLATED OVER ALL 5.44M MIN THICK