

## **Excellent Integrated System Limited**

Stocking Distributor

Click to view price, real time Inventory, Delivery & Lifecycle Information:

[Hammond Manufacturing](#)  
[1444-28](#)

For any questions, you can email us directly:

[sales@integrated-circuit.com](mailto:sales@integrated-circuit.com)

**Bottom View of Assembly**

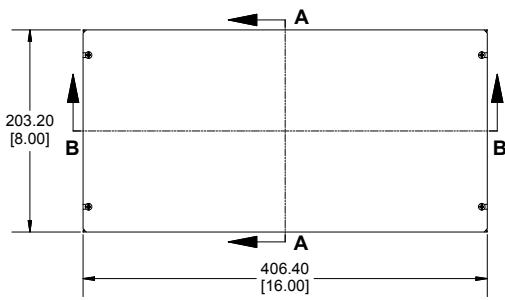

**SECTION A-A  
End View of Assembly**

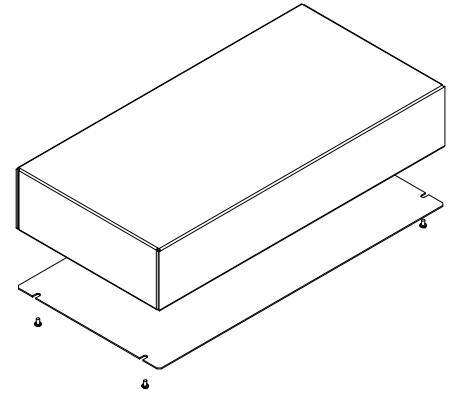
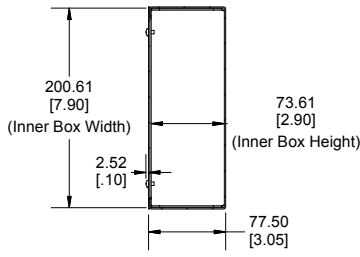

**Bottom View of Chassis  
(Sold Separately)**

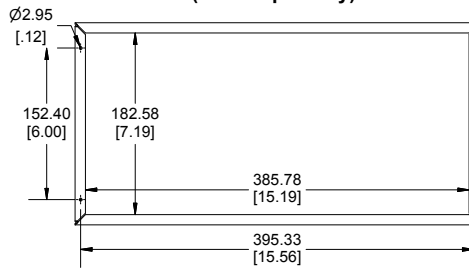

**SECTION B-B  
Side View of Assembly**

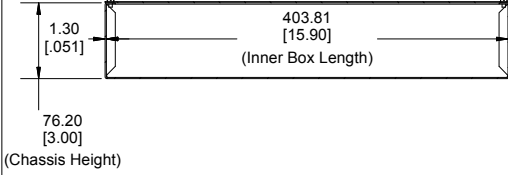

**Bottom Plate  
(Sold Separately)**

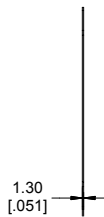
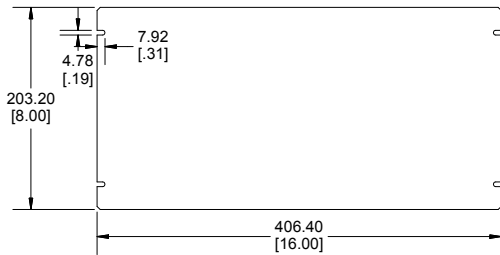

Enclosures can be Factory Modified ( Milling, Drilling, Printing etc.)  
Contact Factory mjm@hammondmfg.com for quotes  
Solid models of this enclosure available in STEP or IGES.

**NOTE**

All Components Sold Separately  
Chassis is Made of 0.051" Aluminum.  
Bottom Plate is Made of 0.051" Aluminum.

**PART NUMBERS**

1444-28 Enclosure	
Natural Finish Chassis	1444-28
<b>ACCESSORIES</b>	
Natural Finish Bottom Plate	1434-26
Plated Cover Screws (Pkg 6) [6-32 x 1/4" Self-Tapping Screws]	1421J6

**HAMMOND  
MANUFACTURING™**  
**1444-28**  
www.hammondmfg.com

Dimensions:  
mm  
[inches]