

## Excellent Integrated System Limited

Stocking Distributor

Click to view price, real time Inventory, Delivery & Lifecycle Information:

[Phoenix Contact](#)  
[1771286](#)

For any questions, you can email us directly:

[sales@integrated-circuit.com](mailto:sales@integrated-circuit.com)



Extract from the online catalog

## HC-B 10-TMQ-45/M1PG16G

Order No.: 1771286



<http://eshop.phoenixcontact.de/phoenix/treeViewClick.do?UID=1771286>

Sleeve housing, with double locking latch, height 45 mm, with screw connection, 1x Pg16, straight cable entry

Commercial data	
GTIN (EAN)	 4 017918 036027
sales group	D002
Pack	10 pcs.
Customs tariff	85389099
Catalog page information	Page 486 (PC-2009)

### Product notes

WEEE/RoHS-compliant since:  
03/01/2006



<http://www.download.phoenixcontact.com>  
 Please note that the data given here has been taken from the online catalog. For comprehensive information and data, please refer to the user documentation. The General Terms and Conditions of Use apply to Internet downloads.

### Technical data

#### General data

Note	For contact inserts HC-B10, BB18, DD42, M, K8/24
Design	B10
Height	45 mm
Width	43 mm
Length	73 mm

HC-B 10-TMQ-45/M1PG16G Order No.: 1771286  
<http://eshop.phoenixcontact.de/phoenix/treeViewClick.do?UID=1771286>

Housing type	Sleeve housings
Locking type	With double locking latch
Cable exit	Straight
Type of the screw connection	1x Pg16
Pg screw connection	With
Wrench size, union nut	22 mm
External cable diameter	7.5 mm ... 15 mm
Degree of protection	IP65
Ambient temperature (operation)	-40 °C ... 125 °C
Housing material	Aluminum, die-cast
Housing surface material	Powder-coated, gray
Cable gland material	Nickel-plated brass
Cable seal material	NBR
Material lock	High-grade steel, handle: PA-GF
Material grip body interlock	PA-GF

**Certificates / Approvals**



Certification

GOST

**Diagrams/Drawings**

Dimensioned drawing

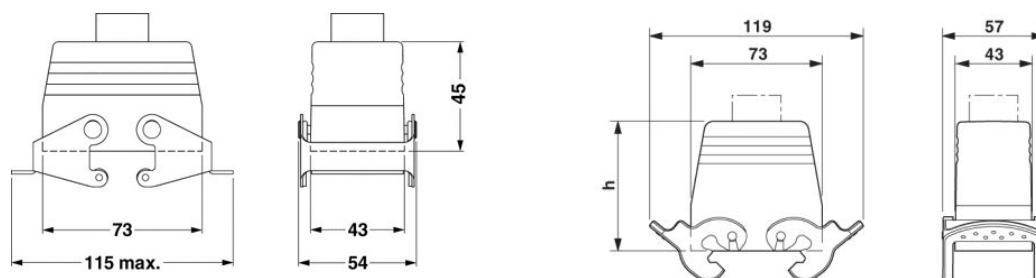

HC-B 10-TMQ-45/M1PG16G Order No.: 1771286  
<http://eshop.phoenixcontact.de/phoenix/treeViewClick.do?UID=1771286>

---

**Address**

PHOENIX CONTACT Deutschland GmbH  
Flachsmarktstr. 8  
32825 Blomberg, Germany  
Phone +49 5235 3 12000  
Fax +49 5235 3 41200  
<http://www.phoenixcontact.de>



© 2010 Phoenix Contact  
Technical modifications reserved;