

Excellent Integrated System Limited

Stocking Distributor

Click to view price, real time Inventory, Delivery & Lifecycle Information:

[Würth Electronics Midcom](#)
[750310344](#)

For any questions, you can email us directly:
sales@integrated-circuit.com



CUSTOMER TERMINAL	RoHS	LEAD(Pb)-FREE
Sn98%, Cu2%	Yes	Yes

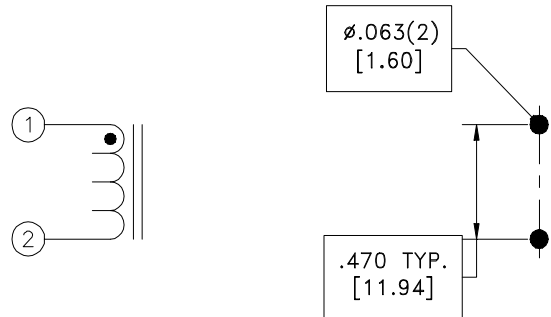
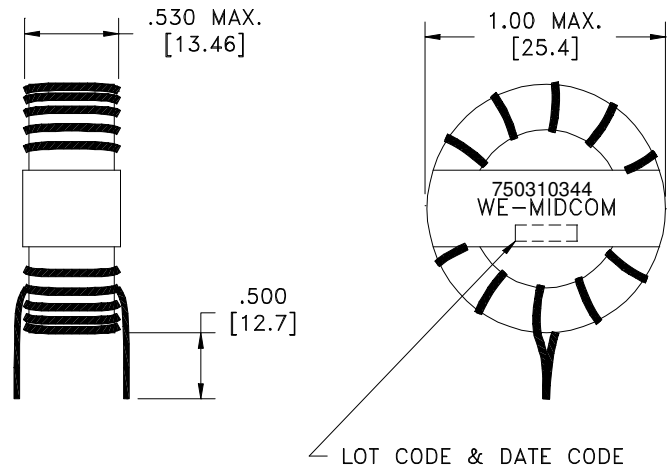

ELECTRICAL SPECIFICATIONS @ 25°C unless otherwise noted:

D.C. RESISTANCE (@20°C):	1-2, .006 Ohms max.
INDUCTANCE:	10.00µH ±10%, 100kHz, 100mVAC, 0mADC, 1-2, Ls.

Midcom, Inc. Watertown, SD USA Toll Free: 800-643-2661 Fax: 605-886-4486	Unless otherwise specified, tolerances are as follows: Angles: ±1° Fractions: ±1/64 Decimals: ±.005 (.127mm)		Midcom, Inc.	
	Drawing Title <h2 style="text-align: center;">Transformer</h2>		Drawing Number <h2 style="text-align: center;">750310344</h2>	Rev. <h2 style="text-align: center;">00</h2>
<small>This drawing is dual dimensioned. Dimensions in brackets are in millimeters</small>	Revisions: See Sheet 1		Scale ----	Sheet 2 of 5
Engineer: TST			11/12/2007	