

## Excellent Integrated System Limited

Stocking Distributor

Click to view price, real time Inventory, Delivery & Lifecycle Information:

[Molex Connector Corporation](#)  
[0643211019](#)

For any questions, you can email us directly:  
[sales@integrated-circuit.com](mailto:sales@integrated-circuit.com)

13 12 11 10 9 8 7 6 5 4 3 2 1

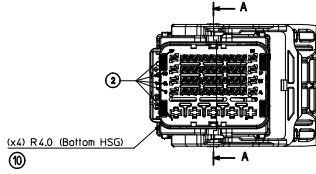
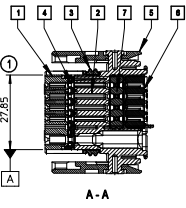

**CMC 53W LEFT WIRE OUTPUT**

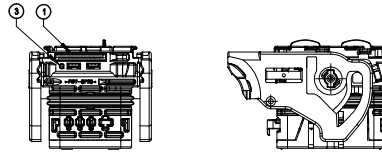

LEFT WIRE OUTPUT (Position shown below)	
MOLEX PIN	COLOR
0643211011	BLACK
0643211018	GREY
0643211019	BROWN
0643211015	GREEN

RIGHT WIRE OUTPUT (Position shown below)	
MOLEX PIN	COLOR
0643212011	BLACK
0643212018	GREY
0643212019	BROWN
0643212015	GREEN

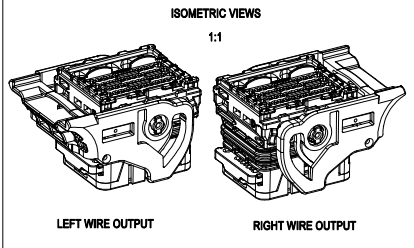
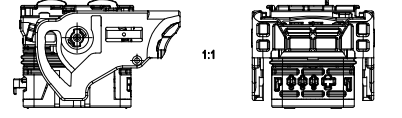
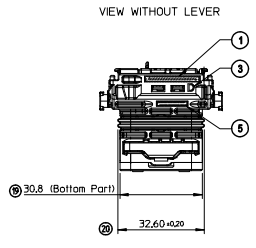
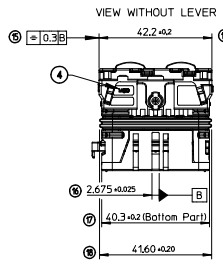
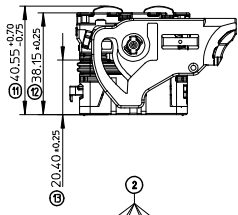
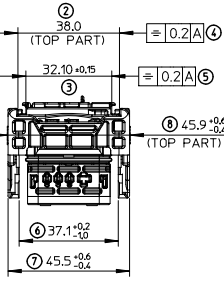
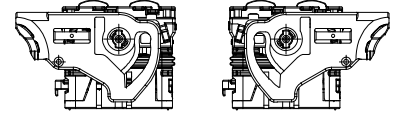

POS.	QTY	DESCRIPTION	MATERIAL	COLOR
7	1	BACK SEAL 'GROMMET'	Silicon	RED
8	1	REAR SEAL COVER	>PBT-GF20<	GREY
5	1	LOCKING LEVER R&L S4	>PBT-GF30<	BLACK
4	1	TPA	>PBT-GF20<	YELLOW
3	1	PERIMETER SEAL SIZE 4	Silicon	RED
2	1	HOUSING TOP PART	>PBT-GF20<	BROWN BLACK BROWN GREY GREEN
1	1	HOUSING BOTTOM PART	>PBT-GF20<	BROWN GREY GREEN

**MARKINGS:**

- ① - Tracking N° for assembled connector. (Year & Day)
- ② - Cavities Identification (N°).
- ③ - Lever sense indicator. Visible letter 'D' = RIGHT WIRE OUTPUT. (Lever on the opposite side of the SL Key) Visible letter 'G' = LEFT WIRE OUTPUT. (Lever on the side of the SL Key)
- ④ - Supplier logo.
- ⑤ - Molex Area.

**NOTES:**

- 1- The represented female connector is the 'D' version (Way out on the Right). Black coding.
- 2- Application Spec.: AS-64318-002
- 3- Plugs & caps used:  
Cavities 0.6: plug: 0643251010  
Cavities 1.5: plug: 0643251023  
Cavities 2.8: cap: 0643251091
- 4- Weight: 50.8 g
- 5- The assembled female connector matches with the cover CMC 53W (P/N: 0643211019)

GENERAL TOLERANCES (UNLESS SPECIFIED)		DIMENSION STYLE	SCALE	DESIGN UNITS	FIRST ANGLE PROJECTION
		MM ONLY	1:1	METRIC	
4 PLACES	± 0.15	mm			
3 PLACES	± 0.10	mm			
2 PLACES	± 0.05	mm			
1 PLACE	± 0.1	mm			
0 PLACE	± 0.1	mm			
ANGULAR ± 2°					
DRAFT WHERE APPLICABLE MUST REMAIN WITHIN DIMENSIONS					
SEE CHARTS					
MATERIAL NO.		DOCUMENT NO.		SHEET NO.	
A2		SD-64321-001		1 OF 2	



13 12 11 10 9 8 7 6 5 4 3 2 1

**CODINGS**

**FEMALE HOUSING RIGHT WIRE OUTPUT**

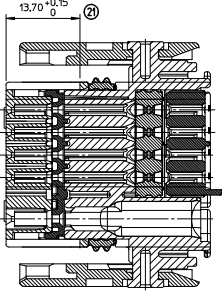

**B - B  
2:1**

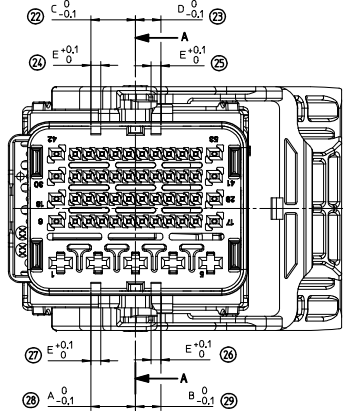

COLOR	CODING	A <sup>0</sup> <sub>-0.1</sub>	B <sup>0</sup> <sub>-0.1</sub>	C <sup>0</sup> <sub>-0.1</sub>	D <sup>0</sup> <sub>-0.1</sub>	E <sup>+0.1</sup> <sub>0</sub>
BLACK	1	8.4	4.8	8.4	4.8	1.8
GREY	2	8.4	6.6	6.6	6.6	1.8
BROWN	3	8.4	8.4	4.8	10.2	1.8
GREEN	4	4.8	10.2	8.4	12.0	1.8

**MODULE OVERALL DIMENSIONS:**

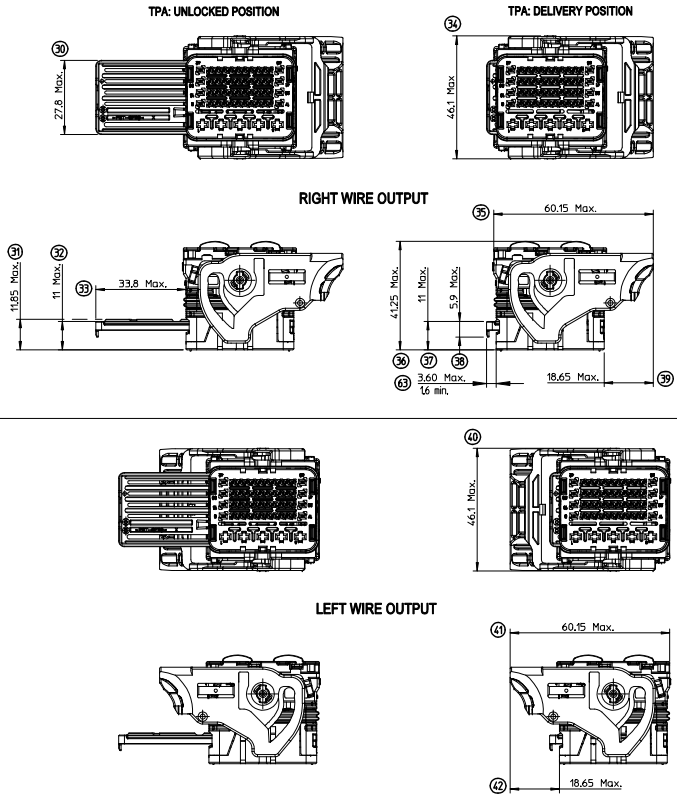

TERMINALS' P/N(S)					
CAVITIES N°	FEMALE TERMINALS (Section mm2)	PLATING	MOLEX P/N	WIRE SEAL	min / MAX WIRE INSULATION DIAMETER
7 to 16 19 to 28 31 to 40 43 to 52	CP 0.6 (0.35mm2)	Tin plated	0643221019	/	Ø1.25 min. / Ø1.40 Max.
		Gold plated	0643221229		
	CP 0.6 (0.5mm2)	Tin plated	0643221039	/	Ø1.40 min. / Ø1.70 Max.
		Gold plated	0643221239		
	CP 0.6 (0.75mm2)	Tin plated	0643221029	/	Ø1.60 min. / Ø1.90 Max.
		Gold plated	0643221219		
6, 17, 18 29, 30, 41 42, 53	CP 1.5 (0.5mm2 to 1mm2)	Tin plated	0643231029	/	Ø1.45 min. / Ø2.15 Max.
		Gold plated	0643231319		
	CP 1.5 (>1mm2 to 2mm2)	Tin plated	0643231039	/	Ø2.10 min. / Ø2.80 Max.
		Gold plated	0643231219		
1 to 5	CP 2.8 (>0.5mm2 to 1mm2)	Tin plated	0643241049	0643251332	Ø1.40 min. / Ø2.15 Max.
		Gold plated	0643241149		
	CP 2.8 (>1mm2 to 2mm2)	Tin plated	0643241039	0643251345	Ø2.10 min. / Ø2.80 Max.
		Gold plated	0643241139		
	CP 2.8 (>2mm2 to 3mm2)	Tin plated	0643241029	0643251358	Ø2.65 min. / Ø3.45 Max.
		Gold plated	0643241129		
	CP 2.8 (>3mm2 to 5mm2)	Tin plated	0643241019	0643251366	Ø3.40 min. / Ø4.00 Max.
		Gold plated	0643241119		

MODIFY COLOR PERMETER SEAL	EC NO: G2014-0127	DRWBY/JOUS	CHKD/BOUGHAN	APPR/PLESSIS	DATE	DESCRIPTION	GENERAL TOLERANCES (UNLESS SPECIFIED)			DIMENSION STYLE		SCALE	DESIGN UNITS	FIRST ANGLE PROJECTION
							mm	INCH	MM ONLY	DATE	TITLE			
4 PLACES	± 0.15	± 0.006			2014/01/16						1.5:1	METRIC		
3 PLACES	± 0.10	± 0.004			2014/01/16									
2 PLACES	± 0.05	± 0.002			2014/01/16									
1 PLACE	± 0.1	± 0.004			2014/06/17									
0 PLACE	± 0.1	± 0.004			2014/06/17									
ANGULAR ± 2 °							DRAFT WHERE APPLICABLE MUST REMAIN WITHIN DIMENSIONS		SEE SHEET 1		THIS DRAWING CONTAINS INFORMATION THAT IS PROPRIETARY TO MOLEX INCORPORATED AND SHOULD NOT BE USED WITHOUT WRITTEN PERMISSION			

CMC FEMALE MODULE 53W  
GENERIC SALES DRAWING

**molex**

DOCUMENT NO. SD-64321-001

SHEET NO. 2 OF 2