



Distributor of Keystone Electronics: Excellent Integrated System Limited

Datasheet of 105-2 - CONTACT PC BATTERY .020" THICK

Contact us: sales@integrated-circuit.com Website: www.integrated-circuit.com

Excellent Integrated System Limited

Stocking Distributor

Click to view price, real time Inventory, Delivery & Lifecycle Information:

[Keystone Electronics](#)

[105-2](#)

For any questions, you can email us directly:

sales@integrated-circuit.com

BATTERY CONTACTS

"A" • "AA" • "AAA" • "N" SIZE PC BUTTON & SPRING CONTACTS



MATERIAL: Frame: .015 Steel, Tin Plate

- Ideal contacts for "A" • "AA" • "AAA" • "N" size batteries.
- Space saving design installs directly onto the PC board
- Contacts available for .062 and .093 thick PC boards
- Reliable spring and/or button assures low contact resistance
- Ideal for self-contained battery compartments



MATERIAL: Frame: .015 Steel, Tin Plate
Uses Cat. No. 211 Spring Contact

(+) Positive Button

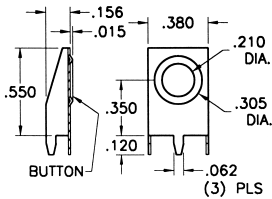

Mounting Detail

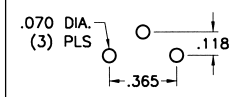

CAT. NO. 595 - For "A"

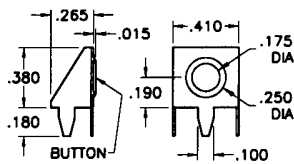

Mounting Detail

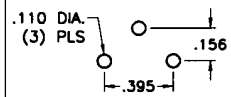

CAT. NO. 637 - For "AA" • "AAA" • "N"

(-) Negative Spring

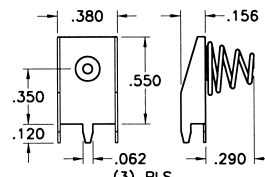

Mounting Detail

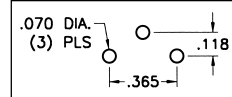

CAT. NO. 628 - For "A"

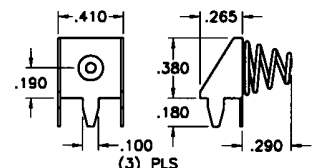

Mounting Detail

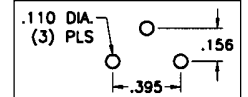

CAT. NO. 629 - For "AA" • "AAA" • "N"

SURFACE MOUNT BATTERY CONTACTS

For "AAA" • "AAAA"

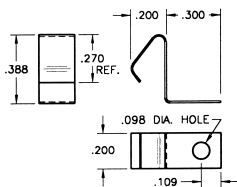

CAT. NO. 5230
CAT. NO. 5230TR



Tape and Reel Spec's: 24mm wide; 12mm pitch;
13 inch reel (400 pieces per reel)

For "A" • "AA" • "9V"

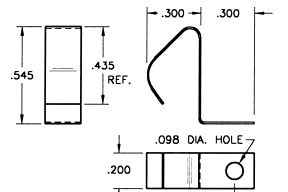

Tape and Reel Spec's: 32mm wide; 12mm pitch;
13 inch reel (400 pieces per reel)



CAT. NO. 5231
CAT. NO. 5231TR

- ECONOMICAL • SPACE SAVING

PC BATTERY CONTACTS

- Ideal for self-contained battery compartments
- Contact us for modifications and custom design

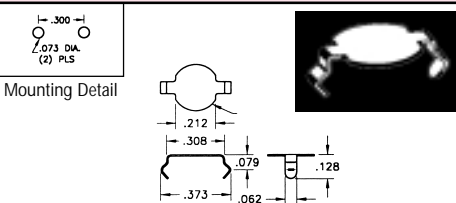

CAT. NO. 2990 .008 Thick, Phosper Bronze, Nickel Plate

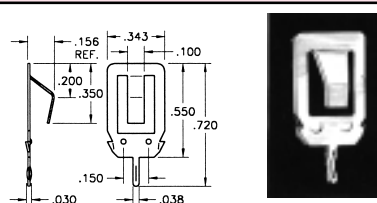

CAT. NO. 108-2 .012 Thick, Spring Steel, Nickel Plate

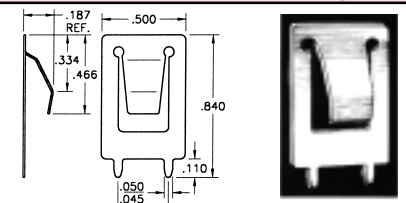

CAT. NO. 109-2 .012 Thick, Spring Steel, Nickel Plate

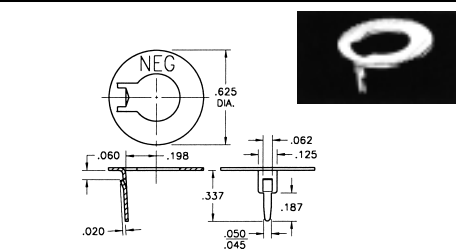

CAT. NO. 105-3 .020 Thick, Spring Steel, Nickel Plate

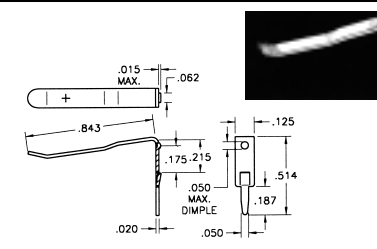

CAT. NO. 105-2 .020 Thick, Spring Steel, Nickel Plate

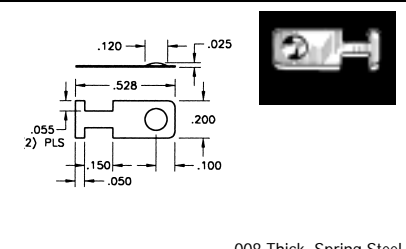

CAT. NO. 230-1 .008 Thick, Spring Steel, Nickel Plate

