

Excellent Integrated System Limited

Stocking Distributor

Click to view price, real time Inventory, Delivery & Lifecycle Information:

[Phoenix Contact](#)
[1608155](#)

For any questions, you can email us directly:
sales@integrated-circuit.com



Extract from the online catalog

VS-PPC-C1-PC67-POBK

Order No.: 1608155



<http://eshop.phoenixcontact.de/phoenix/treeViewClick.do?UID=1608155>

Protective cover, IP67, to cover the contact insert in the RJ45 and SCRJ push-pull panel mounting frames



Commercial data	
GTIN (EAN)	 4 046356 159999
sales group	D512
Pack	1 pcs.
Customs tariff	39269097
Catalog page information	Page 195 (PC-2009)

Product notes

WEEE/RoHS-compliant since:
01/01/2008



<http://www.download.phoenixcontact.com>
 Please note that the data given here has been taken from the online catalog. For comprehensive information and data, please refer to the user documentation. The General Terms and Conditions of Use apply to Internet downloads.

Technical data

Mechanical characteristics	
Insertion/withdrawal cycles	≥ 500
Color	black
Ambient temperature (operation)	-40 °C ... 70 °C

VS-PPC-C1-PC67-POBK Order No.: 1608155
<http://eshop.phoenixcontact.de/phoenix/treeViewClick.do?UID=1608155>

Material data

Inflammability class acc. to UL 94	V0
Housing material	PA-GF
Material	Plastic
Material, O-ring	NBR
Material, housing intermediate seal	NBR
Degree of protection	IP65/67

Diagrams/Drawings

Explosion drawing

Mounting the protective cover

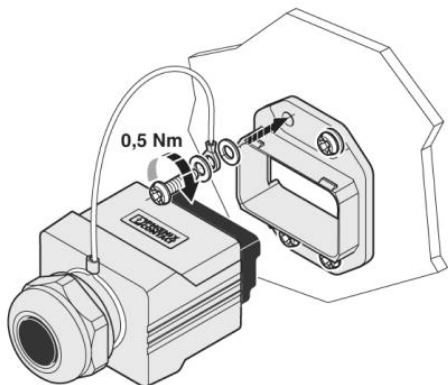

Dimensioned drawing

Protective cover for the Push-Pull panel mounting frame

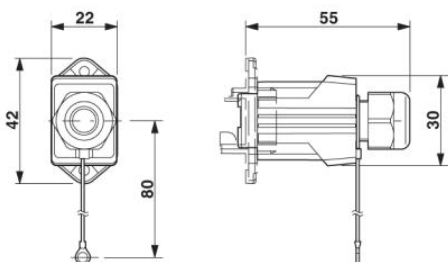

VS-PPC-C1-PC67-POBK Order No.: 1608155
<http://eshop.phoenixcontact.de/phoenix/treeViewClick.do?UID=1608155>

Address

PHOENIX CONTACT Deutschland GmbH
Flachsmarktstr. 8
32825 Blomberg, Germany
Phone +49 5235 3 12000
Fax +49 5235 3 41200
<http://www.phoenixcontact.de>



© 2011 Phoenix Contact
Technical modifications reserved;