

## Excellent Integrated System Limited

Stocking Distributor

Click to view price, real time Inventory, Delivery & Lifecycle Information:

[Molex Connector Corporation](#)  
[0850424696](#)

For any questions, you can email us directly:

[sales@integrated-circuit.com](mailto:sales@integrated-circuit.com)

13 12 11 10 9 8 7 6 5 4 3 2 1

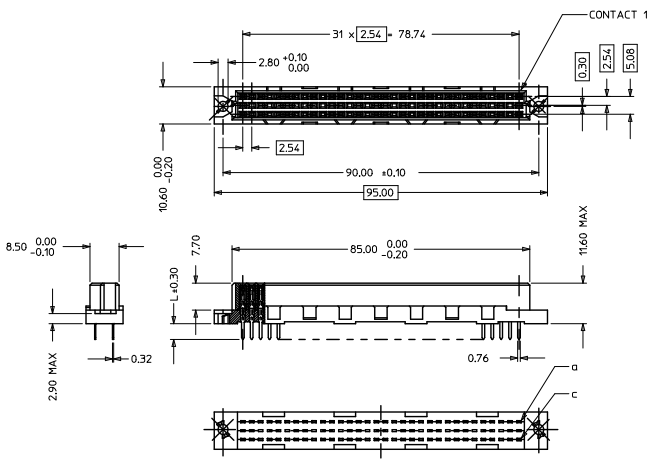

RECOMMENDED PCB LAYOUT  
COMPONENT SIDE

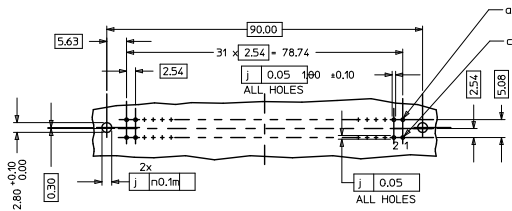

WITH MOUNTING CLIPS

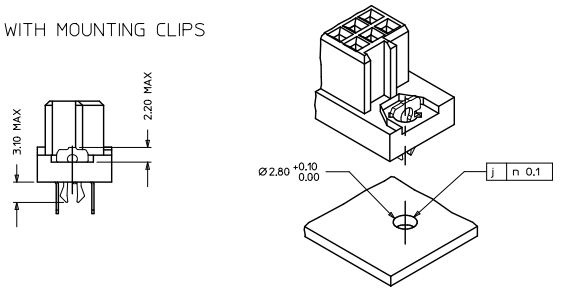

NOTES:

- 1) MATERIALS: THERMOPLASTIC POLYESTER/GLASS FILLED.  
UL94V-0 COLOUR: PEBBLE GREY/RAL 7032  
TERMINAL - PHOSPHOR BRONZE  
MOUNTING CLIP: STEEL
- 2) FINISH: TERMINAL:-  
CONTACT AREA  
A. PERFORMANCE LEVEL 1: SELECTIVE GOLD (Au),  
THICKNESS = 127 MICROMETER OVER NICKEL  
THICKNESS = 18 MICROMETER  
B. PERFORMANCE LEVEL 2: SELECTIVE GOLD (Au),  
THICKNESS = 0.8 MICROMETER OVER NICKEL  
THICKNESS = 18 MICROMETER  
C. PERFORMANCE LEVEL 3: SELECTIVE GOLD (Au),  
THICKNESS = 0.3 MICROMETER OVER NICKEL.  
THICKNESS = 18 MICROMETER.  
TERMINATION AREA:  
SELECTIVE TIN, THICKNESS = 5 MICROMETER  
OVER NICKEL, THICKNESS 18 MICROMETER OVERALL.
- 3). MOUNTING CLIP:  
TIN (Sn), THICKNESS = 5-10 MICROMETER OVER NICKEL (Ni)  
THICKNESS = 2.5 MICROMETER.
- 4). FOR NON MOUNTING CLIP OPTION, CONNECTOR TO BE SECURED WITH  
RIVETS: 2 TABULAR RIVETS 2.5 X 0.3 ...DIN 7340  
SCREWS: 2 CHEESEHEAD SCREWS M2.5 X ...DIN 84 AND  
2 HEXAGONAL NUTS M2.5 DIN 934.
- 5). MATERIAL NO. BATCH CODE, UL AND CSA MARKING TO BE PRINTED  
ON THE CONNECTOR.
- 6). CUT FACES OF TIP WITHOUT PLATING PERMITTED.

EC NO: 12010-0265 2009/12/11 DRMNS01 CHIKKIPRASAD 2009/12/28 APPR:KPRASAD 2010/01/06	QUALITY SYMBOLS ▽=0 ▽=0	GENERAL TOLERANCES (UNLESS SPECIFIED)		DIMENSION STYLE MM ONLY		SCALE 4:1	DESIGN UNITS METRIC	THIRD ANGLE PROJECTION
		4 PLACES ± 0.005 ± --- 3 PLACES ± 0.1 ± --- 2 PLACES ± 0.15 ± --- 1 PLACE ± 0.15 ± --- ANGULAR ± 2°	mm INCH ± 0.005 ± --- ± 0.1 ± --- ± 0.15 ± --- ± 0.15 ± ---	DRAWN BY PRASHANT 2004/12/07 CHECKED BY SSUDHIR 2004/12/07 APPROVED BY SSUDHIR 2004/12/07	DATE DATE DATE	TITLE ASSEMBLY, DIN 41612 C FEMALE, 96 POS		MOLEX INCORPORATED
DRAFT WHERE APPLICABLE MUST REMAIN WITHIN DIMENSIONS	MATERIAL NO. SEE CHART	DOCUMENT NO. SD-85042-001	SHEET NO. 1 OF 2		THIS DRAWING CONTAINS INFORMATION THAT IS PROPRIETARY TO MOLEX INCORPORATED AND SHOULD NOT BE USED WITHOUT WRITTEN PERMISSION			

13 12 11 10 9 8 7 6 5 4 3 2 1

MATERIAL No	PERF LEVEL	PLATING	CONTACT SEQUENCE/ROW	DIM "L" mm	MOUNTING CLIP NO.	FLUX PROOF
850421249	1	Au+Ni	1,2,3...32 a+c	4,5	NO	NO
850420385	2	Au+Ni	1,2,3...32 a+b+c	2,9	NO	NO
850420191	2	Au+Ni	1,2,3...32 a+c	4,5	NO	NO
850420270	2	Au+Ni	1,2,3...32 a+b+c	4,5	NO	NO
850420397	2	Au+Ni	2,4,6...32 a+c	4,5	NO	NO
850421043	1	Au+Ni	1,2,3...32 a+b+c	4,5	NO	NO
850421079	2	Au+Ni	1,2,3...32 a+b+c	2,9	YES	NO
850421213	2	Au+Ni	1,2,3...32 a+b+c	4,5	YES	NO
850421304	1	Au+Ni	1,2,3...32 a+b+c	2,9	NO	NO
850422347	2	Au+Ni	1,2,3...32 a+b+c	2,9	NO	YES
850422529	2	Au+Ni	1,2,3...32 a+c	2,9	YES	NO
850423316	2	Au+Ni	2,4,6...32 a+c	2,9	YES	YES
850424696	2	Au+Ni	1,2,3...32 a+c	4,5	YES	NO
850424763	2	Au+Ni	2,4,6...32 a+c	2,9	NO	NO
850426232	2	Au+Ni	1,2,3...32 a+b+c	4,5	YES	NO
850429017	3	Au+Ni	1,2,3...32 a+b+c	4,5	YES	NO

VIEW ON MATING SIDE (96PINS)

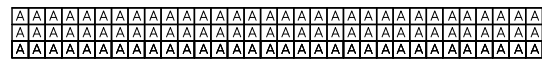

VIEW ON MATING SIDE (64PINS)

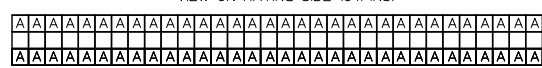

VIEW ON MATING SIDE (32PINS)

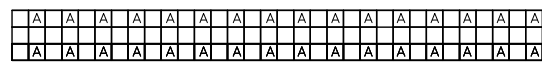

CLIPS SNAP UNDER PC - BOARD OF 1.5 to 1.8 mm  
 $F_m \leq 60N$   
 $F_r \geq 20N$   
 $F_r \geq 200N$ , WHEN SOLDERED IN PLATED - THROUGH FIXING HOLES

$F_m$  = MOUNTING FORCE (FOR ONE CONNECTOR = 2 CLIPS)

$F_r$  = RETENTION FORCE (FOR ONE CONNECTOR = 2 CLIPS)

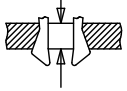

CLIPS STICK IN FIXING HOLE OF PC - BOARDS OVER 1.8 mm  
 $F_m \leq 60N$   
 $F_r \geq 16N$

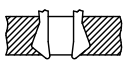

IEC NO: 12010-0265 2009/12/11 DRWNS01 CHIKKIRASAD APPR:KRASAD 2010/01/06	QUALITY SYMBOLS	GENERAL TOLERANCES (UNLESS SPECIFIED)	DIMENSION STYLE	SCALE	DESIGN UNITS	THIRD ANGLE PROJECTION	
	$\nabla=0$ $\nabla=0$	mm INCH 4 PLACES $\pm$ --- $\pm$ --- 3 PLACES $\pm 0.05$ $\pm$ --- $\pm$ --- 2 PLACES $\pm 0.1$ $\pm$ --- $\pm$ --- 1 PLACE $\pm 0.15$ $\pm$ --- $\pm$ --- ANGULAR $\pm 2^\circ$	MM ONLY	4:1	METRIC	DRAWN BY PRASHANT 2004/12/07 CHECKED BY PRASHANT 2004/12/07 APPROVED BY PRASHANT 2004/12/07 MATERIAL NO. SEE CHART SIZE A2	TITLE ASSEMBLY, DIN 41612, C FEMALE, 96 POS MOLEX INCORPORATED DOCUMENT NO. SD-85042-001 SHEET NO. 2 OF 2
	DRAFT WHERE APPLICABLE MUST REMAIN WITHIN DIMENSIONS						THIS DRAWING CONTAINS INFORMATION THAT IS PROPRIETARY TO MOLEX INCORPORATED AND SHOULD NOT BE USED WITHOUT WRITTEN PERMISSION