

## Excellent Integrated System Limited

Stocking Distributor

Click to view price, real time Inventory, Delivery & Lifecycle Information:

[Industrial Fiber Optics, Inc.](#)  
[510053](#)

For any questions, you can email us directly:  
[sales@integrated-circuit.com](mailto:sales@integrated-circuit.com)

© COPYRIGHT 2009 BY INDUSTRIAL FIBER OPTICS, INC.  
ALL RIGHTS RESERVED.

16 [.62]

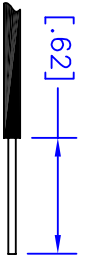

STRIP LENGTH: 16mm

**NOTES:**

1. RoHS COMPLIANT
2. -40°C TO 85°C OPERATING TEMPERATURE
3. SUITABLE FOR POF WITH Ø2.2mm BUFFER AND Ø1.0mm OPTICAL CORE
4. TIA 604.1 (FOCUS 1)
5. MAXIMUM TORQUE: 8in-lbs

**INSTRUCTIONS:**

1. STRIP A 16mm LENGTH OF JACKET OFF OF FIBER.
2. SLIP BOOT OVER CABLE.
3. APPLY EPOXY TO INSIDE OF SMA CONNECTOR AND BARE FIBER.
4. INSERT BARE FIBER INTO SMA CONNECTOR; ROTATE FIBER DURING INSERTION TO EVENLY DISTRIBUTE EPOXY.
5. CRIMP CONNECTOR TO CABLE ABOVE RETENTION RIDGES AND SLIP BOOT OVER CONNECTOR BODY TO FINISH INSTALLATION. ALLOW EPOXY TO CURE BEFORE POLISHING.

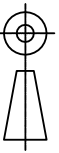

METRIC

REV	DESCRIPTION	ECO	DATE	DMN	APVD
B	ADDED BOOT INFORMATION	0036	09/29/09	BB	KS

REVISIONS

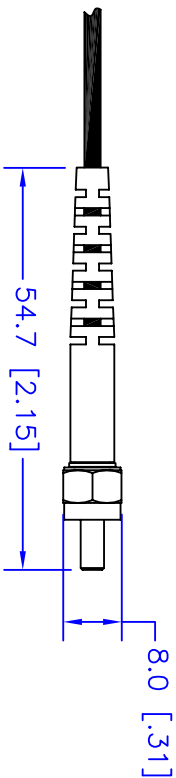
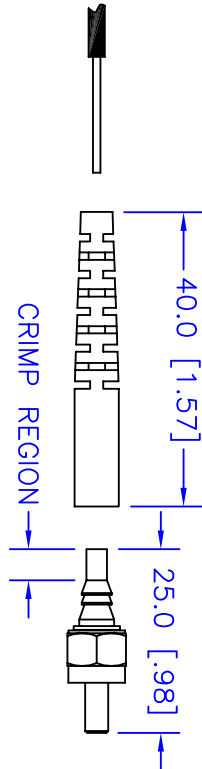
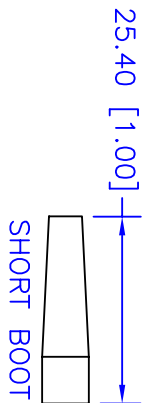

RECOMMENDED EPOXY:  
EPO-TEK 301

CRIMP TOOL: IF 370046  
USE 2.5 [.10] HEX CRIMP

UNLESS OTHERWISE SPECIFIED  
DIMENSIONS MILLIMETERS [IN.]

TOLERANCES

- |              |             |
|--------------|-------------|
| 0 PLC: ±1    | SURFACE 32/ |
| 1 PLC: ±.25  | TEXTURE: √  |
| 2 PLC: ±.127 |             |
| 3 PLC: ±.025 |             |
| 4 PLC: ±.013 |             |
| ANGLE: ±1/2° |             |

REMOVE BURRS AND SHARP EDGES  
FLATNESS .005 MM PER MM  
ALL DIMENSIONS AFTER FINISH

PRODUCT	303 STAINLESS
MATERIAL	303 STAINLESS
FINISH	NONE
DRAWN BY	BIDWELL
DATE	06/22/09
CHECKED BY	STOTZ
DATE	09/29/09

51 0053	W/STANDARD BLACK BOOT
51 0054	W/STANDARD RED BOOT
51 0056	W/STANDARD BLUE BOOT
51 0057	W/STANDARD YELLOW BOOT
51 0058	W/STANDARD WHITE BOOT
51 0062	W/SHORT BLACK BOOT

**INDUSTRIAL FIBER OPTICS**

TEMPE, AZ 85281

SMA WITH BOOT

NAME	SMA WITH BOOT			
SIZE	SCALE	PART NUMBER	REV	
A	1:1	51 0053	B	
DO NOT SCALE DRAWING	SHEET	1	OF	1