

## Excellent Integrated System Limited

Stocking Distributor

Click to view price, real time Inventory, Delivery & Lifecycle Information:

[Molex Connector Corporation](#)  
[03-06-1061](#)

For any questions, you can email us directly:

[sales@integrated-circuit.com](mailto:sales@integrated-circuit.com)

RECEPTACLE

PLUG

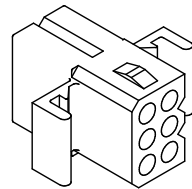
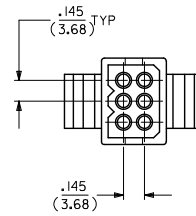
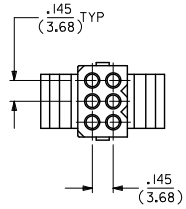
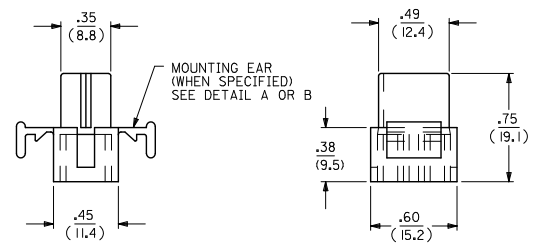
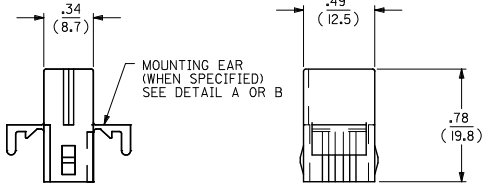
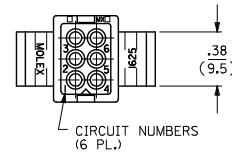
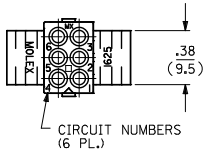

SHOWN WITH STANDARD EAR

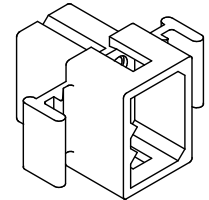

SHOWN WITH STANDARD EAR

UPDATE REV. LEVEL EC NO: UCP2072-2714 DRAWN BY: ZHANGHAG CHKD: BELL APPR: SMITH 2017/04/09 2017/04/09 2017/04/25	QUALITY SYMBOLS ▽=0 ▽=0	GENERAL TOLERANCES (UNLESS SPECIFIED)		DIMENSION STYLE IN/MM		SCALE ---	DESIGN UNITS INCH	THIRD ANGLE PROJECTION	
		4 PLACES ± --- ± ---	3 PLACES ± --- ± .010	DRAWN BY KBW	DATE 7/22/88	TITLE .062/(157) HOUSING PLUG & RECEPTACLE 6 CKT, .145/(3.68) C.L.			
		2 PLACES ± 0.25 ± .014	1 PLACE ± 0.35 ± ---	CHECKED BY RW	DATE 7/22/88	MOLEX INCORPORATED			
		ANGULAR ± 1/2°		APPROVED BY RAS	DATE 7/22/88	SEE CHART SD-1625-6*			
DRAFT WHERE APPLICABLE MUST REMAIN WITHIN DIMENSIONS		MATERIAL NO. SEE CHART		DOCUMENT NO. SD-1625-6*		SHEET NO. 1 OF 2			

PLUG		
ORDER NO	ENG NO	
03-06-2062	I625-6P	
03-06-2061	I625-6PI	
03-06-7062	I625-6PBK	
03-06-7061	I625-6PIBK	
03-06-7063	I625-6POR	OBSOLETE
-	-	

RECEPTACLE		
ORDER NO	ENG NO	
03-06-1061	I625-6R	
03-06-1062	I625-6RI	
03-06-6061	I625-6RBK	
03-06-6062	I625-6RIBK	
03-06-6063	I625-6ROR	OBSOLETE
03-06-6064	I625-6RBU	
NOT TOOLED	I625-6R2	

LEGEND:  
1625-6\*\*\*\*

CIRCUIT SIZE  
P = PLUG  
R = RECEPTACLE

BLANK = WITH STANDARD EARS  
1 = WITHOUT EARS  
2 = WITH PREBENT EARS

COLOR:  
BLANK = NATURAL COLOR  
AM = AMBER BK = BLACK BU = BLUE  
BN = BROWN GY = GRAY GN = GREEN  
OR = ORANGE RD = RED YW = YELLOW

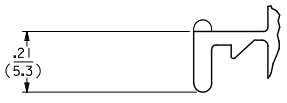

DETAIL A  
.062/(1.57) STANDARD MOUNTING EAR  
(SCALE 4:1)

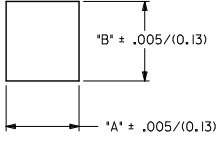
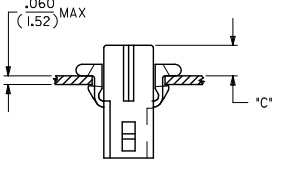

HOUSING	DIM. 'A'	DIM. 'B'	'C' PREBENT EAR	'C' STANDARD EAR
PLUG	.607/(15.42)	.615/(15.62)	.22/(5.6)	.18/(4.6)
RECEPT.	.505/(12.83)	.552/(14.02)	.23/(5.8)	.19/(4.8)

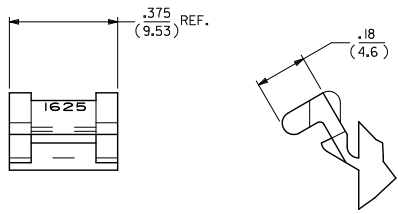

DETAIL B  
.062/(1.57) PREBENT MOUNTING EAR  
(SCALE 4:1)

- NOTES:-  
1. MATERIAL NYLON TYPE 6/6, 94-2.  
2. FINISH: NONE.  
3. PRODUCT SPECS: MOLEX PRODUCT SPECS 02-06 APPLIES.  
4. PACKAGING SPECS: BULK PACK PER PK-1625-003.

REVISE PKG NOTE #4 EC NO: UCP2072-2714 DRWING: HMG 2017/04/09 CHKD: JELL 2017/04/09 APPR: SMTH 2017/04/25	QUALITY SYMBOLS ▽=0 ▽=0	GENERAL TOLERANCES (UNLESS SPECIFIED)		DIMENSION STYLE IN/MM		SCALE ---	DESIGN UNITS INCH	THIRD ANGLE PROJECTION
		4 PLACES ± --- ± ---	DRAWN BY KBW DATE 7/22/88	TITLE .062 / (1.57) HOUSINGS PLUG & RECEPTACLE 6 CKT., 145/(3.683) C.L.				
		3 PLACES ± --- ± .010	CHECKED BY RW DATE 7/22/88	MOLEX MOLEX INCORPORATED				
		2 PLACES ± 0.25 ± .014 1 PLACE ± 0.35 ± --- ANGULAR ± 1/2°	APPROVED BY RAS DATE 7/22/88	MATERIAL NO. SEE CHART	DOCUMENT NO. SD-1625-6*	SHEET NO. 2 OF 2		
DRAFT WHERE APPLICABLE MUST REMAIN WITHIN DIMENSIONS		THIS DRAWING CONTAINS INFORMATION THAT IS PROPRIETARY TO MOLEX INCORPORATED AND SHOULD NOT BE USED WITHOUT WRITTEN PERMISSION						