

Excellent Integrated System Limited

Stocking Distributor

Click to view price, real time Inventory, Delivery & Lifecycle Information:

[Amphenol RF](#)
[122112](#)

For any questions, you can email us directly:

sales@integrated-circuit.com

| REV. | DATE | DESCRIPTION |
|------|----------|------------------------|
| A | 11/29/03 | UPDATE DRAWING FROM AT |

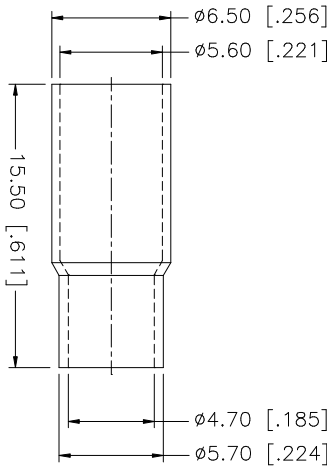
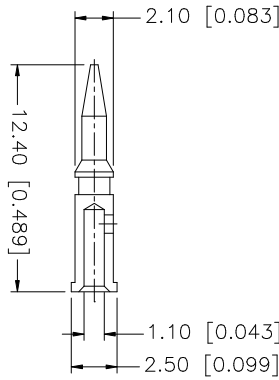
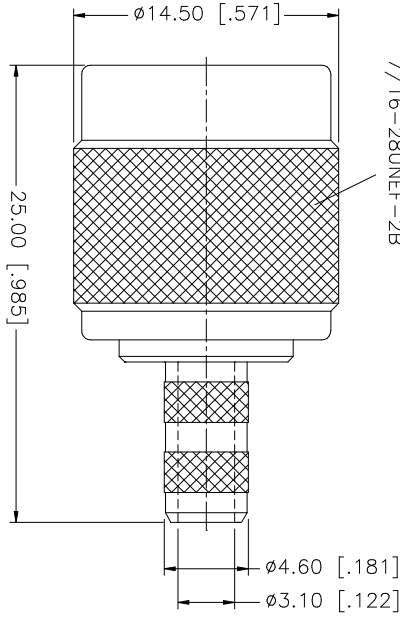
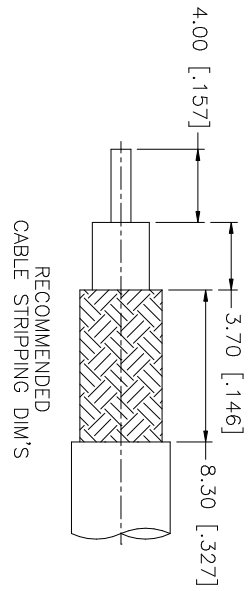

| | | | | | |
|--|-------------|-------------------|---------|------------|--|
| 8 | | | | | UNLESS OTHERWISE SPECIFIED DIMENSIONS ARE IN INCHES AND FOR CUSTOMER REFERENCE ONLY. |
| 7 | | | | | TOLERANCES FOR MILLIMETERS ARE: |
| 6 | | | | | 0.5 - 8mm ± 0.20mm |
| 5 | | | | | 8 - 30mm ± 0.40mm |
| 4 | FERRULE | COPPER | NICKEL | 1 | 30 - 120mm ± 0.50mm |
| 3 | CONTACT PIN | BRASS | GOLD | 1 | UNLESS OTHERWISE SPECIFIED DIMENSIONS FOR INCHES ARE: |
| 2 | INSULATOR | DELRIN | NATURAL | 1 | .020 - .315 = ± 0.007" |
| 1 | BODY | BRASS | NICKEL | 1 | .315 - 1.180 = ± 0.015" |
| | | | | | 1.180 - 4.724 = ± 0.020" |
| | DESCRIPTION | MATERIAL | FINISH | QTY | DO NOT SCALE DRAWING |
| | | APPROVALS | | DATE | |
| | | DRAWN G.R.S. | | 11/29/03 | |
| | | CHECKED | | | |
| | | ISSUED | | | |
| | | SHEET 1 OF 1 | | | |
| | | CAD FILE | | | |
| | | C:/122/122112.DWG | | | |
| | | DWG. NO. | | 122112.DWG | |
| | | REV. | | A | |
| | | SIZE | | A | |
| | | SCALE | | NA | |
| <p>Amphenol Connex</p> <p>TNC STRAIGHT CRIMP PLUG (FOR B89907, 58 PLENUM CABLE)</p> <p>122112</p> | | | | | |