

## **Excellent Integrated System Limited**

Stocking Distributor

Click to view price, real time Inventory, Delivery & Lifecycle Information:

[Amphenol RF](#)  
[172190](#)

For any questions, you can email us directly:

[sales@integrated-circuit.com](mailto:sales@integrated-circuit.com)

REV.	DATE	DESCRIPTION
NC	10/01/97	INITIAL RELEASE
NC	04/19/07	REVISE PLATING TO NEXCOTE / UPDATE DRAWING FDMAT

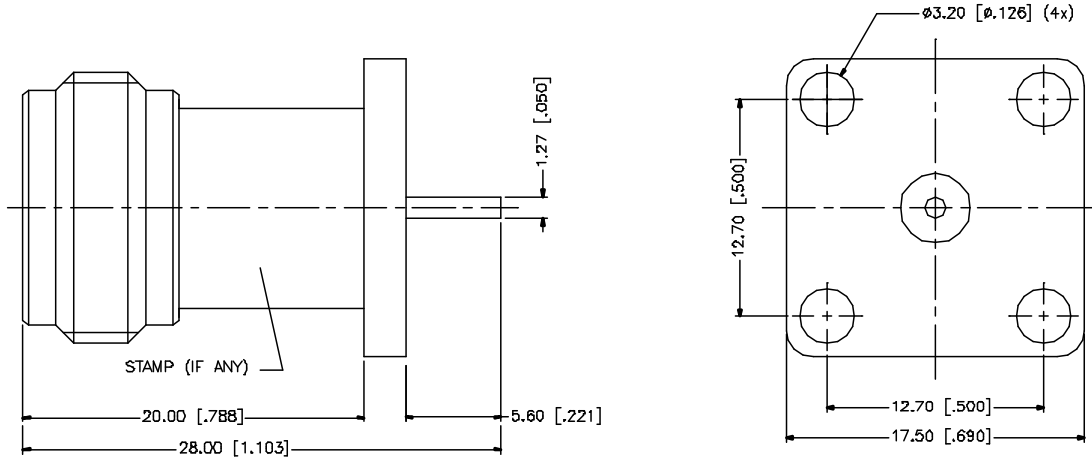

REV.	DESCRIPTION	MATERIAL	FINISH	QTY	APPROVALS	DATE	<h1 style="color: blue;">Amphenol Connex</h1>
8							
7							<b>172190</b>
6							
5							<b>172190</b>
4							
3	CONTACT PIN	PHOS. BRONZE	GOLD	1			<b>172190</b>
2	INSULATOR	TEFLON	NATURAL	1			
1	BODY	BRASS	NEXCOTE	1			<b>172190</b>
	DESCRIPTION	MATERIAL	FINISH	QTY			

UNLESS OTHERWISE SPECIFIED DIMENSIONS ARE IN MILLIMETERS. DIMENSIONS IN [ ] ARE IN INCHES AND FOR CUSTOMER REFERENCE ONLY.

UNLESS OTHERWISE SPECIFIED TOLERANCES FOR MILLIMETERS ARE:  
 0.5 - 8mm ± 0.20mm  
 8 - 30mm ± 0.40mm  
 30 - 120mm ± 0.50mm

UNLESS OTHERWISE SPECIFIED TOLERANCES FOR INCHES ARE:  
 .020 - .315 = ± 0.007"  
 .315 - 1.180 = ± 0.015"  
 1.180 - 4.724 = ± 0.020"

DO NOT SCALE DRAWING

APPROVALS

DATE: 04/19/07

DRAWN: G.R.S.

CHECKED:

ISSUED:

SHEET: 1 OF 1

CAD FILE: C:/172/172190.DWG

Part Description: N PANEL RECEPTACLE JACK / EXTENDED BODY

Part No.: 172190

DWG. NO.: 172190.DWG