

Excellent Integrated System Limited

Stocking Distributor

Click to view price, real time Inventory, Delivery & Lifecycle Information:

[Amphenol RF](#)
[112618](#)

For any questions, you can email us directly:

sales@integrated-circuit.com

REV.	DATE	DESCRIPTION
NC	07/24/00	INITIAL RELEASE
A	09/24/06	UPDATE DRAWING FORMAT

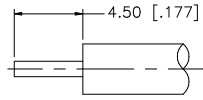

RECOMMENDED
CABLE STRIPPING DIM'S

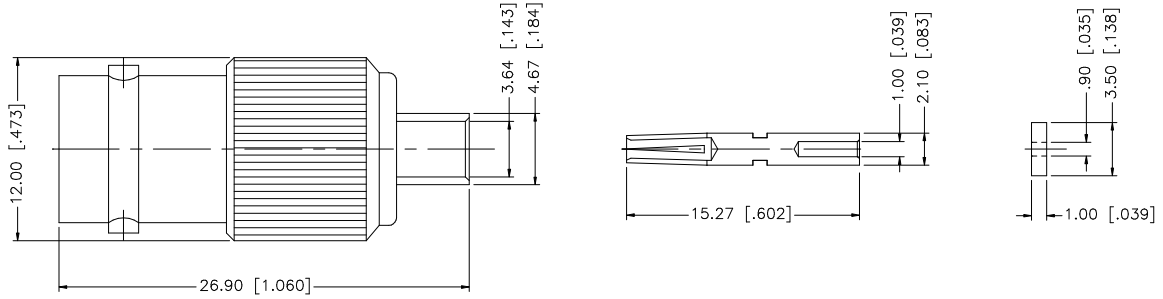

8				<small>UNLESS OTHERWISE SPECIFIED DIMENSIONS ARE IN MILLIMETERS. DIMENSIONS IN [] ARE IN INCHES AND FOR CUSTOMER REFERENCE ONLY.</small> <small>UNLESS OTHERWISE SPECIFIED TOLERANCES FOR MILLIMETERS ARE:</small> 0.5 - 8mm ± 0.20mm 8 - 30mm ± 0.40mm 30 - 120mm ± 0.50mm <small>UNLESS OTHERWISE SPECIFIED TOLERANCES FOR INCHES ARE:</small> .020 - .315 = ± 0.007" .315 - 1.180 = ± 0.015" 1.180 - 4.724 = ± 0.020" DO NOT SCALE DRAWING	APPROVALS	DATE	<h1 style="color: blue;">Amphenol Connex</h1>		
7			DRAWN		G.R.S.	09/24/06			
6			CHECKED						
5			ISSUED						
4	CONTACT PIN	PHOS. BRONZE	GOLD		1			PART DESCRIPTION	
3	INSULATOR	TEFLON	NATURAL		1			BNC DIRECT SOLDER JACK (FOR .141" SEMI RIGID CABLE)	
2	BARREL	BRASS	GOLD		1			PART NO.	
1	BODY	BRASS	NICKEL		1			112618	
	DESCRIPTION	MATERIAL	FINISH	QTY	CAD FILE	DWG. NO.	REV.	SIZE	SCALE
					C:/112/112618.DWG	112618.DWG	A	A	NA