

Excellent Integrated System Limited

Stocking Distributor

Click to view price, real time Inventory, Delivery & Lifecycle Information:

[Molex Connector Corporation](#)
[1061231400](#)

For any questions, you can email us directly:

sales@integrated-circuit.com

| LC QUAD ADAPTER | LC QUAD ADAPTER | SPLIT SLEEVE |
|-----------------|-----------------|-----------------|
| P/N | COLOR | MATERIAL |
| 106123-0400 | BLUE | ZR |
| 106123-1400 | BEIGE | PHOSPHOR BRONZE |
| 106123-2400 | GREEN | ZR |
| 106123-3400 | AQUA | PHOSPHOR BRONZE |

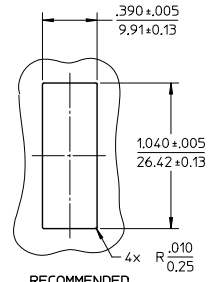
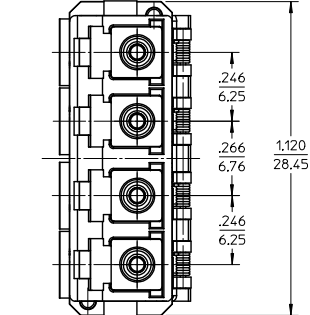
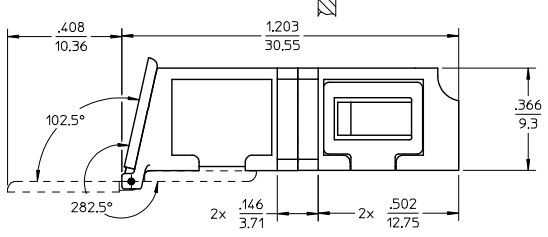
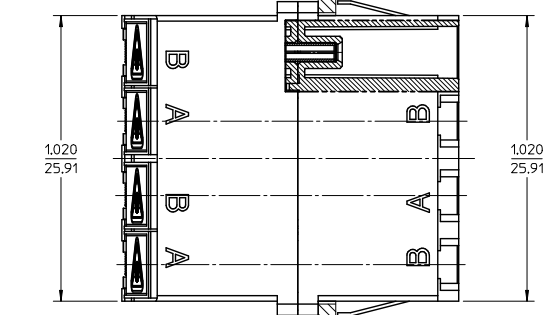
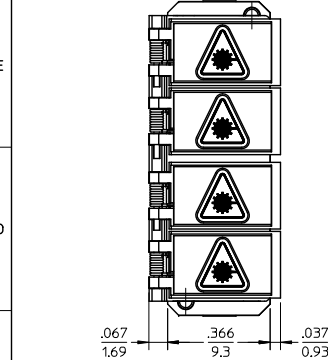

RECOMMENDED MOUNTING PATTERN SCALE 1.5:1

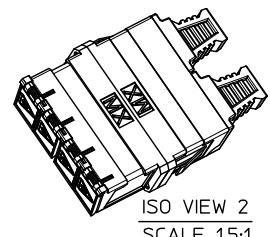

ISO VIEW 2 SCALE 1.5:1

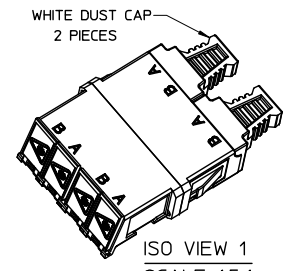

ISO VIEW 1 SCALE 1.5:1

- NOTES:
1. ALL DIMENSIONS ARE FOR REFERENCE.
 2. DUST CAPS NOT SHOWN ON FRONT, BOTTOM AND RIGHT VIEW.
 3. LC QUAD ADAPTER HAS SC DUPLEX ADAPTER FOOTPRINT.

| ENTER DESCRIPTION LC NO: MF2013-0549 DRAWN/REVZNER 2013/03/04 CHKD: GUMIN APPR: GUMIN 2013/03/07 REV A1 | QUALITY SYMBOLS | GENERAL TOLERANCES (UNLESS SPECIFIED) | DIMENSION STYLE | SCALE | DESIGN UNITS | THIRD ANGLE PROJECTION | | | | | | | | | | | | | | | | | | |
|--|---|---|-----------------|-------|---|------------------------|--------|--------|----------|--------|--------|----------|--------|--------|---------|--------|--------|---------|---|---|-------|-----|------|--|
| | $\nabla=0$ $\nabla=0$ $\nabla=0$ | <table border="1"> <thead> <tr> <th></th> <th>mm</th> <th>INCH</th> </tr> </thead> <tbody> <tr> <td>4 PLACES</td> <td>± .---</td> <td>± .---</td> </tr> <tr> <td>3 PLACES</td> <td>± .---</td> <td>± .---</td> </tr> <tr> <td>2 PLACES</td> <td>± .---</td> <td>± .---</td> </tr> <tr> <td>1 PLACE</td> <td>± .---</td> <td>± .---</td> </tr> <tr> <td>0 PLACE</td> <td>±</td> <td>±</td> </tr> </tbody> </table> | | mm | INCH | 4 PLACES | ± .--- | ± .--- | 3 PLACES | ± .--- | ± .--- | 2 PLACES | ± .--- | ± .--- | 1 PLACE | ± .--- | ± .--- | 0 PLACE | ± | ± | IN/MM | 3:1 | INCH | |
| | | mm | INCH | | | | | | | | | | | | | | | | | | | | | |
| | 4 PLACES | ± .--- | ± .--- | | | | | | | | | | | | | | | | | | | | | |
| 3 PLACES | ± .--- | ± .--- | | | | | | | | | | | | | | | | | | | | | | |
| 2 PLACES | ± .--- | ± .--- | | | | | | | | | | | | | | | | | | | | | | |
| 1 PLACE | ± .--- | ± .--- | | | | | | | | | | | | | | | | | | | | | | |
| 0 PLACE | ± | ± | | | | | | | | | | | | | | | | | | | | | | |
| ANGULAR ±---° DRAFT WHERE APPLICABLE MUST REMAIN WITHIN DIMENSIONS | DRAWN BY DATE PGIBLIN 2005/11/21 CHECKED BY DATE APPROVED BY DATE MATERIAL NO. SEE TABLE DOCUMENT NO. SD-106123-X400 | TITLE | | | LC QUAD ADAPTER WITH SHUTTERS SMALL FLANGE, SNAP MOUNT molex | | | | | | | | | | | | | | | | | | | |
| | | | | | | SHEET NO. 1 OF 1 | | | | | | | | | | | | | | | | | | |