



**Distributor of Molex Connector Corporation: Excellent Integrated System Limited**  
Datasheet of 0482580001 - Connector Receptacle USB TypeA 2.0 4 Position Board Cutout,  
Through Hole, Right Angle

Contact us: [sales@integrated-circuit.com](mailto:sales@integrated-circuit.com) Website: [www.integrated-circuit.com](http://www.integrated-circuit.com)

---

## **Excellent Integrated System Limited**

Stocking Distributor

Click to view price, real time Inventory, Delivery & Lifecycle Information:

[Molex Connector Corporation](#)  
[0482580001](#)

For any questions, you can email us directly:  
[sales@integrated-circuit.com](mailto:sales@integrated-circuit.com)

Contact us: sales@integrated-circuit.com Website: www.integrated-circuit.com

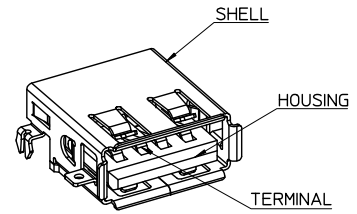
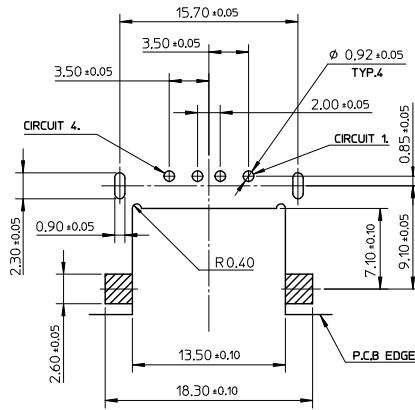
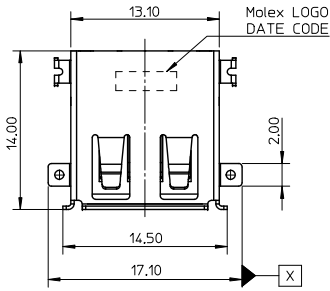

**NOTES:**

- MATERIAL:**  
HOUSING: LCP, FIBER GLASS FILLED, UL94V-0, COLOR:BLACK.  
TERMINAL: PHOSPHOR BRONZE.  
METAL SHELL: BRASS.
- FINISH:**  
TERMINAL:  
SELECTIVE GOLD(Au) IN CONTACT AREA, THICKNESS=30 MICROINCH MINIMUM, SELECTIVE TIN IN SOLDER TAIL AREA, THICKNESS=120 MICROINCH MINIMUM, NICKEL(Ni) OVERALL.  
METAL SHELL:  
NICKEL(Ni) OVERALL, THICKNESS=40 MICROINCH MINIMUM, UNDER PLATED: COPPER(Cu) OVERALL.
- PRODUCT SPECIFICATION REFER TO PS-48258-001.
- PACKAGE SPECIFICATION REFER TO PK-48258-001.
- TEST SUMMARY REFER TO TS-48258-001
- COPLANARITY TO BE 0.10 mm MAX.
- LEAD FREE AND RoHS COMPLIANT PRODUCT.
- DATE CODE:  
X X X X  
└── DAY  
└── WEEK  
└── YEAR

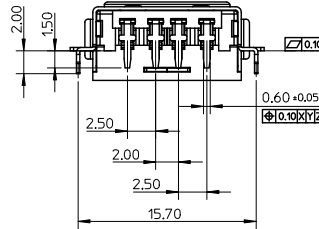
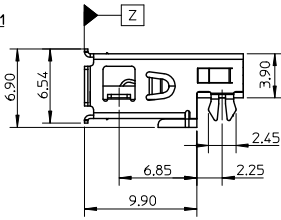
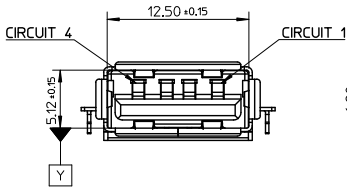

<b>NEW RELEASE</b> EC NO: SH2013-0324 CHKD: DRINKYANG05 APPR: RZHANG 2013/03/30 2013/05/17	QUALITY SYMBOLS	GENERAL TOLERANCES (UNLESS SPECIFIED)	DIMENSION STYLE	SCALE	DESIGN UNITS	THIRD ANGLE PROJECTION
	$\nabla=0$ $\nabla=0$	mm INCH 4 PLACES ± --- ± --- 3 PLACES ± --- ± --- 2 PLACES ± 0.25 ± --- 1 PLACE ± 0.25 ± --- ANGULAR ± 3°	MM ONLY	1:1	METRIC	
		DRAFT WHERE APPLICABLE MUST REMAIN WITHIN DIMENSIONS	MATERIAL NO. 48258-0001	DATE 2006/04/13	TITLE	USB A SINK REVERSE TYPE (LEAD-FREE VERSION)
			SIZE A3	DATE 2006/04/13	MOLEX INCORPORATED	DOCUMENT NO. SD-48258-001