

Excellent Integrated System Limited

Stocking Distributor

Click to view price, real time Inventory, Delivery & Lifecycle Information:

[Schurter](#)
[4840.2201](#)

For any questions, you can email us directly:

sales@integrated-circuit.com

DC Plug/Socket

www.schurter.com/PG12_2

4840.2201

DC Connector, Socket, 6.0 mm, 2.00 mm, 2-pole, solder terminals for PCB



Description

- PCB Mounting:
Drop-in type, from rear-side
- Low Voltage DC Plug and Socket
- DC Plug: 2-pole, straight

Technical Data

| | |
|-----------------------|-------------------|
| Diameter | 6.0 mm / 2.0 mm |
| Number of Poles | 2-pole |
| Ratings DC | 0.5A / 12VDC |
| Dielectric Strength | 500VDC |
| Insulation Resistance | > 100 MΩ @ 500VDC |

| | |
|---------------------------|--------------------------|
| Allowable Operation Temp. | -20°C to 70°C |
| Terminal | PCB terminals tin-plated |
| Mounting | Drop-in type |
| Style | straight |
| Lifetime | 5000 Insertions |

Dimensions

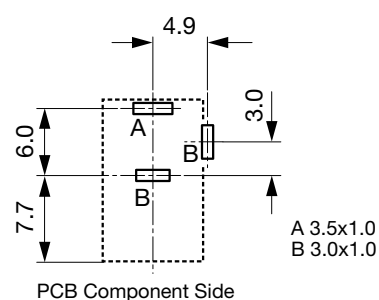
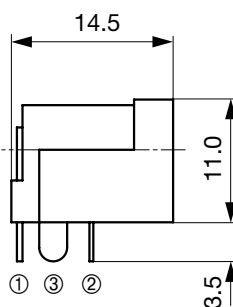
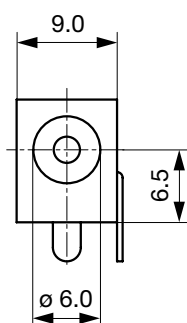

Diagrams



All Variants

| Product group | Diameter [mm] | Number of Poles | Terminal | Order Number |
|----------------|---------------|-----------------|---------------|--------------|
| DC Plug/Socket | 6.0 | 2-pole | PCB terminals | 4840.2201 |

Most Popular.

Availability for all products can be searched real-time: <http://www.schurter.com/Stock-Check/Stock-Check-SCHURTER>

4840.2201

DC Plug/Socket
www.schurter.com/PG12_2**Packaging unit** 250 Pcs**Mating Inlets/Plugs****Category / Description**[DC Plug/Socket Overview complete](#)

| | |
|---|-----------|
| 4840, solder terminal, Plug, 5.5 mm, 2-pole, DC Plug/Socket | 4840.1200 |
| 4840, Cable, Plug, 5.5 mm, 2-pole, DC Plug/Socket | 4840.5200 |
| 4840, Cable, Plug, 5.5 mm, 2-pole, DC Plug/Socket | 4840.5201 |

[DC Plug/Socket further types to 4840.2201](#)