

## Excellent Integrated System Limited

Stocking Distributor

Click to view price, real time Inventory, Delivery & Lifecycle Information:

[Schurter](#)  
[4310.0016](#)

For any questions, you can email us directly:

[sales@integrated-circuit.com](mailto:sales@integrated-circuit.com)

IEC Connector C19, Rewireable, Angled



C19



70 °C

**Description**

- cable:  
Screwing cable terminal,
- 1 Function:  
Connector, Pin temperature 70 °C, Protection class I, Cable
- Note: strain relief has to be ordered separately, mating strain reliefs please find under accessories

**Approvals**

- VDE Certificate Number: 40008423
- CSA File Number: 1435558

**References**

This type is Phase-out. Alternate type: [4790](#)  
Last order date: 31.12.2012

**Weblinks**

[pdf-datasheet](#), [html-datasheet](#), [General Product Information](#), [Approvals](#), [RoHS](#), [CHINA-RoHS](#), [Mating Connectors](#), [e-Shop](#), [SCHURTER-Stock-Check](#), [Distributor-Stock-Check](#), [CAD-Drawings](#), [Accessories](#), [Detailed request for product](#)

**Technical Data**

|                           |  |
|---------------------------|--|
| Ratings IEC               | 16 A / 250 VAC; 50 Hz  |
| Ratings UL/CSA            | 21 A / 250 VAC; 60 Hz  |
| Dielectric Strength       | > 3 kVAC between L-N<br>> 1.5 kVAC between L/N-PE<br>(1 min/50 Hz) |
| Allowable Operation Temp. | -25 °C to 70 °C  |
| Protection Class          | Suitable for appliances with protection class I acc. to IEC 61140  |
| Terminal                  | Bolts and nuts   |
| Material: Housing         | PA6, black or grey, UL 94V-0                                       |

|           |   |
|-----------|---|
| Connector | C19 acc. to IEC 60320<br>UL 498, CSA C22.2 no. 42 (for cold conditions) pin-temperature 70 °C, 16 A, Protection Class I |
|-----------|---|

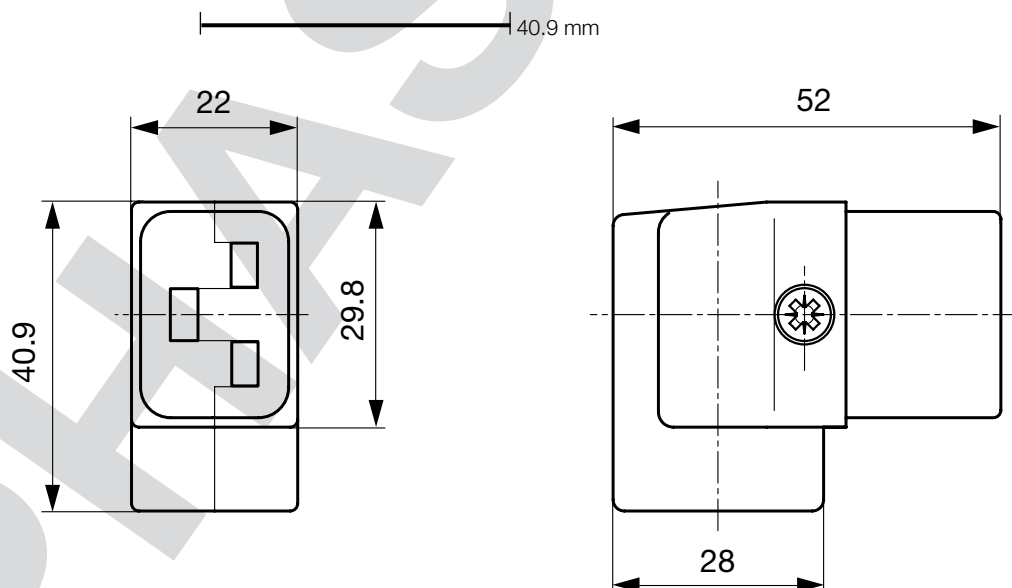
**Dimensions**

## Config. Code

1651 - H - A B C 0 - D - E J

The characters are placeholders for the correspondingly keys of selections from the key tables.

1651 - **H** - A B C 0 - D - E J = Type

| Type               | Configuration key |
|--------------------|-------------------|
| protection class 1 | X                 |

1651 - H - **A** B C 0 - D - E J = Terminals

| Terminal L     | Configuration key |
|----------------|-------------------|
| screw terminal | A                 |

1651 - H - A **B** C 0 - D - E J = Terminals

| Terminal N     | Configuration key |
|----------------|-------------------|
| screw terminal | A                 |

Symbols similar as in table A

1651 - H - A B **C** 0 - D - E J = Terminals

| Terminal Ground | Configuration key |
|-----------------|-------------------|
| screw terminal  | A                 |

Symbols similar as in table A

1651 - H - A B C 0 - **D** - E J = Color

| Color | Configuration key |
|-------|-------------------|
| Black | A                 |
| Grey  | B                 |

1651 - H - A B C 0 - D - **E J** = Style

| Style             | Configuration key |
|-------------------|-------------------|
| for cord assembly | 8                 |

1651 - H - A B C 0 - D - E **J** = Condition

| Condition    | Configuration key |
|--------------|-------------------|
| assembled    | 1                 |
| disassembled | 2                 |

## Variants

| Config. Code     | Description  | Order Number |
|------------------|--|--------------|
| 1651-X-AAA0-A-81 | 1651, IEC Connector, C19, 70°C, version: 1, L: screw terminal, N: screw terminal, ground: screw terminal, color: Black, design: for cord assembly, condition:assembled | 4310.0016    |
| 1651-X-AAA0-B-81 | 1651, IEC Connector, C19, 70°C, version: 1, L: screw terminal, N: screw terminal, ground: screw terminal, color: Grey, design: for cord assembly, condition:assembled  | 4310.0017    |

The listed variants should be available from stock. Other versions on request [www.schurter.com/contact](http://www.schurter.com/contact)

Max. torque for screws: Terminals: 0.8 Nm, Cable clamps: 0.8 Nm, Cover: 0.5 Nm

Packaging unit 50 Pcs

## Accessories

## Description



4311.0053  
PVC Strain Relief for cable outside diameter 8.7mm, 3 x 16AWG



4311.0068  
PVC Strain Relief for cable outside diameter 10mm, 3 x 14AWG



4311.9305  
PVC Strain Relief for cable outside diameter 8.7mm-10mm, 3 x 14AWG



4311.9306  
PVC Strain Relief for cable outside diameter 8.7mm-10mm, 3 x 14AWG



4311.9316  
PVC Strain Relief for cable outside diameter 8.7mm, 3 x 16AWG



4311.9317  
PVC Strain Relief for cable outside diameter 8.7mm, 3 x 16AWG



4311.9318  
PVC Strain Relief for cable outside diameter 10mm, 3 x 14AWG

## Description



4311.9319

PVC Strain Relief for cable outside diameter 10mm, 3 x 14AWG

## Mating Inlets/Plugs

## Category / Description

[Appliance Inlet Overview complete](#)

|   |      |
|---|------|
| IEC Appliance Inlet C20, Screw-on Mounting, Rear Side, PCB Terminal                             | 1601 |
| IEC Appliance Inlet C20, Screw-on Mounting, Front Side, Solder, Quick-connect or Screw Terminal | 1621 |
| IEC Appliance Inlet C20, Snap-in Mounting, Front Side, Solder or Quick-connect Terminal         | 4793 |
| IEC Appliance Inlet C24, Snap-in Mounting, Front Side, Solder or Quick-connect Terminal         | 4794 |
| IEC Appliance Inlet C20, Screw-on Mounting, Front Side, Solder or Quick-connect Terminal        | 4798 |

[Appliance Inlet further types to 1651](#)[Appliance inlets/-outlets Overview complete](#)

|   |      |
|---|------|
| Plug Coupler IEC C20 / IEC J, Screw-on Mounting | 4730 |
|---|------|

[Appliance inlets/-outlets further types to 1651](#)[Plug Overview complete](#)

|   |      |
|---|------|
| IEC Plug I, Cord Connector (Rewireable), Straight | 0106 |
| IEC Plug I, Cord Connector (Rewireable), Angled   | 1611 |
| IEC Plug I, Cord Connector (Rewireable), Angled   | 4789 |
| IEC Plug I, Cord Connector (Rewireable), Straight | 4796 |

[Plug further types to 1651](#)[Power Entry Module Overview complete](#)

|  |        |
|--|--------|
| IEC Appliance Inlet C20 with Circuit Breaker           | 1624-K |
| IEC Appliance Inlet C20 with Line Switch, 1- or 2-pole | EC11   |
| IEC Appliance Inlet C20 with Circuit Breaker TA45      | EF11   |
|  | EG11   |

[Power Entry Module further types to 1651](#)[Power Entry Module with line filter Overview complete](#)

|  |      |
|--|------|
| IEC Appliance Inlet C20 with Filter, ECO design, front or rear side Mounting                       | 5130 |
| IEC Appliance Inlet C20 with Filter, Front or Rear Side Mounting                                   | C20F |
| IEC Appliance Inlet C22 for Hot Conditions, with Filter for High Temperatures, Front Side Mounting | C22F |
| IEC Appliance Inlet C20 with Filter, Line Switch 2-pole  | EC12 |
| IEC Appliance Inlet C20 with Filter, Circuit Breaker TA45 (recessed)                               | EF12 |

[Power Entry Module with line filter further types to 1651](#)

...