

Excellent Integrated System Limited

Stocking Distributor

Click to view price, real time Inventory, Delivery & Lifecycle Information:

[Schurter](#)
[7010.1780.12](#)

For any questions, you can email us directly:
sales@integrated-circuit.com

Non resettable fuses
www.schurter.com/PG01_2

Subminiature Fuse, 4.05 x 10 mm, Quick-Acting F, 250 VAC, 125 VDC



UL 248-14 · 250 VAC · 125VDC · Quick-Acting F



Description

- Low Breaking Capacity

Standards

- UL 248-14
 - CSA C22.2 no. 248.14

Approvals

- UL File Number: E42088

References

[Packaging Details](#)

Weblinks

[pdf-datasheet](#), [html-datasheet](#), [General Product Information](#), [Approvals](#), [CE declaration of conformity](#), [RoHS](#), [CHINA-RoHS](#), [REACH](#), [Distributor-Stock-Check](#), [Detailed request for product](#)

Technical Data

Rated Voltage	125 - 250 VAC, 125VDC
Rated current	0.05 - 5 A
Breaking Capacity	50 A - 300 A
Characteristic	Quick-Acting F
Admissible Ambient Air Temp.	-40 °C to 85 °C
Material: Tube	Ceramic
Material: Axial Leads	Tin-Plated Copper
Unit Weight	0.6 g
Storage Conditions	0 °C to 60 °C, max. 70% r.h.
Product Marking	 , Rated current, Characteristic

Soldering Methods	Wave Soldering Profile
Solderability	235 °C / 2 sec acc. to IEC 60068-2-20, Test Ta, method 1
Resistance to Soldering Heat	260 °C / 5 sec acc. to IEC 60068-2-20, Test Tb, method 1A

Dimension

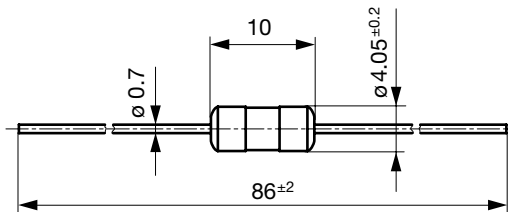
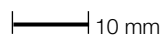

Pre-Arcing Time

Rated Current I _n	1.0 x I _n min.	2.0 x I _n max.	3.0 x I _n max.
0.05 A - 5 A	4 h	60 s	100 ms

Time-Current-Curves

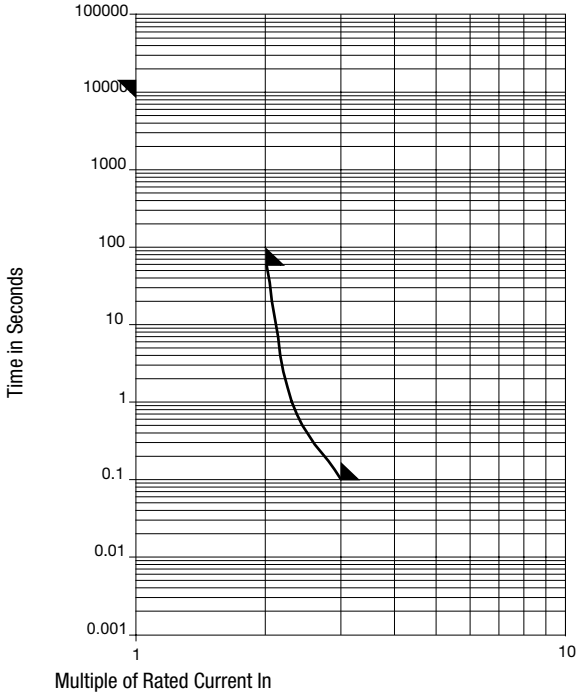

All Variants

Rated Current [A]	Rated Voltage [VAC]	Rated Voltage [VDC]	Breaking Capacity	Voltage Drop 1.0 In typ. [mV]	Melting I ² t 10.0 Intyp. [A ² s]	Order Number
0.05	250	125	1)	1150	0.00011	● 7010.1740.46
0.063	250	125	1)	735	0.00035	● 7010.1750.46
0.08	250	125	1)	950	0.00039	● 7010.1760.12
0.1	250	125	1)	875	0.00079	● 7010.1770.12
0.1	250	125	1)	875	0.00079	● 7010.1770.46
0.125	250	125	1)	870	0.0013	● 7010.1780.12
0.125	250	125	1)	870	0.0013	● 7010.1780.46
0.15	250	125	1)	545	0.0029	● 7010.1790.12
0.15	250	125	1)	545	0.0029	● 7010.1790.46
0.2	250	125	1)	520	0.0071	● 7010.1910.12
0.2	250	125	1)	520	0.0071	● 7010.1910.46
0.3	250	125	1)	920	0.021	● 7010.1920.12
0.3	250	125	1)	920	0.021	● 7010.1920.46
0.4	250	125	1)	725	0.057	● 7010.1930.12
0.4	250	125	1)	725	0.057	● 7010.1930.46
0.5	250	125	1)	725	0.069	● 7010.1800.46
0.6	250	125	1)	205	0.059	● 7010.1810.12
0.6	250	125	1)	205	0.059	● 7010.1810.46
0.8	250	125	1)	150	0.095	● 7010.1820.12
0.8	250	125	1)	150	0.095	● 7010.1820.46
1	250	125	1)	185	0.12	● 7010.1830.46
1.25	250	125	1)	125	0.29	● 7010.1840.12
1.25	250	125	1)	125	0.29	● 7010.1840.46
1.6	250	125	1)	135	0.48	● 7010.1850.12
1.6	250	125	1)	135	0.48	● 7010.1850.46
2	250	125	1)	110	0.95	● 7010.1860.12
2	250	125	1)	110	0.95	● 7010.1860.46
2.5	250	125	1)	145	1.2	● 7010.1870.12
2.5	250	125	1)	145	1.2	● 7010.1870.46

Non resettable fuses

www.schurter.com/PG01_2

Rated Current [A]	Rated Voltage [VAC]	Rated Voltage [VDC]	Breaking Capacity	Voltage Drop 1.0 In typ. [mV]	Melting I ² t 10.0 Intyp. [A ² s]		Order Number
3	250	125	1)	220	1.8	●	7010.1880.12
3	250	125	1)	220	1.8	●	7010.1880.46
4	250	125	1)	130	3.4	●	7010.1890.12
4	250	125	1)	130	3.4	●	7010.1890.46
5	250	125	1)	105	7.7	●	7010.1900.12
5	250	125	1)	105	7.7	●	7010.1900.46

Most Popular.

Availability for all products can be searched real-time: <http://www.schurter.com/Stock-Check/Stock-Check-SCHURTER>

1) 50 A @ 250 VAC/DC / 300 A @ 125 VAC/DC

Packaging Unit .xx = .12 Plastic Bag (50 pcs.)
 .xx = .46 Taped 19 cm Reel (1000 pcs.)