

## Excellent Integrated System Limited

Stocking Distributor

Click to view price, real time Inventory, Delivery & Lifecycle Information:

[BUD Industries, Inc.](#)  
[JBH-4959-KO](#)

For any questions, you can email us directly:

[sales@integrated-circuit.com](mailto:sales@integrated-circuit.com)

PART NAME	JUNCTION BOX w/ HINGED COVER & KNOCKOUTS	PART No.	JBH-4959-KO	REVISION DATE	7-18-11
-----------	--	----------	-------------	---------------	---------

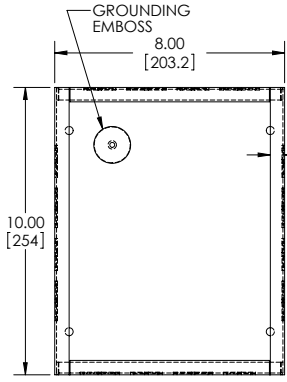
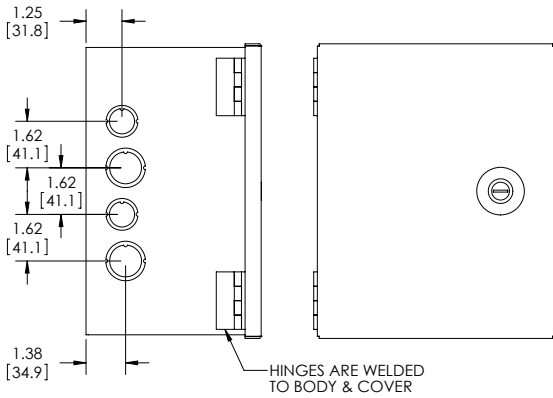
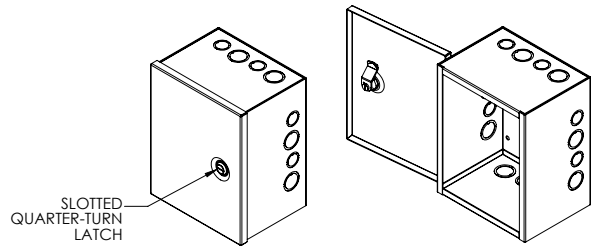
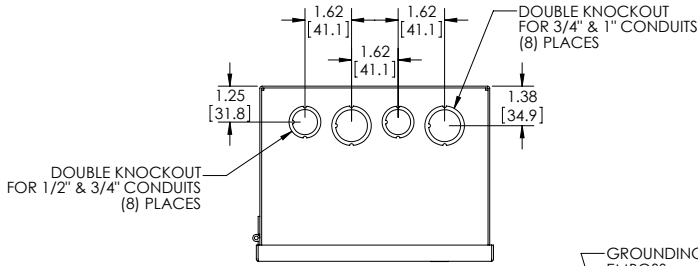

**COVER NOT SHOWN  
THIS VIEW**

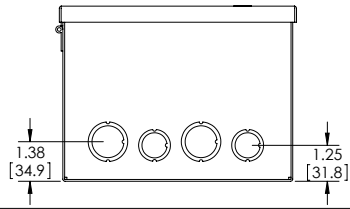
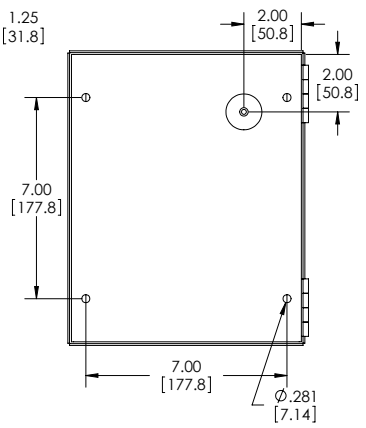
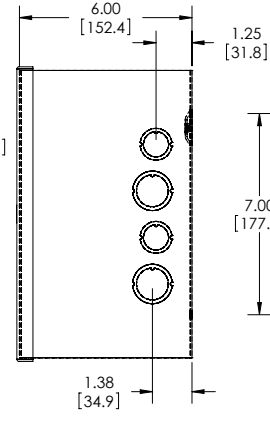

MATERIAL - 16 GA. [1.5mm] STEEL  
 FINISH - SMOOTH GRAY POWDERCOAT  
 INCLUDES ONE (1) #10-32 x .31" [8mm] LG. MACHINE, PAN HEAD, SLOTTED/SQUARE COMBINATION STYLE DRIVE, STEEL, ZINC PLATED SCREW FOR GROUND POINT.