

Excellent Integrated System Limited

Stocking Distributor

Click to view price, real time Inventory, Delivery & Lifecycle Information:

[E-Switch](#)
[EG2271](#)

For any questions, you can email us directly:

sales@integrated-circuit.com

SHEET 0F

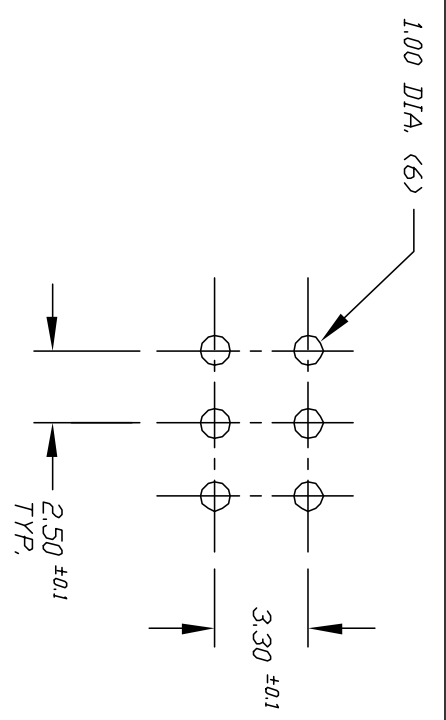
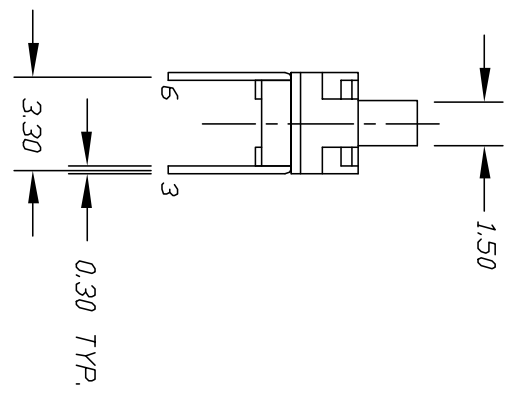
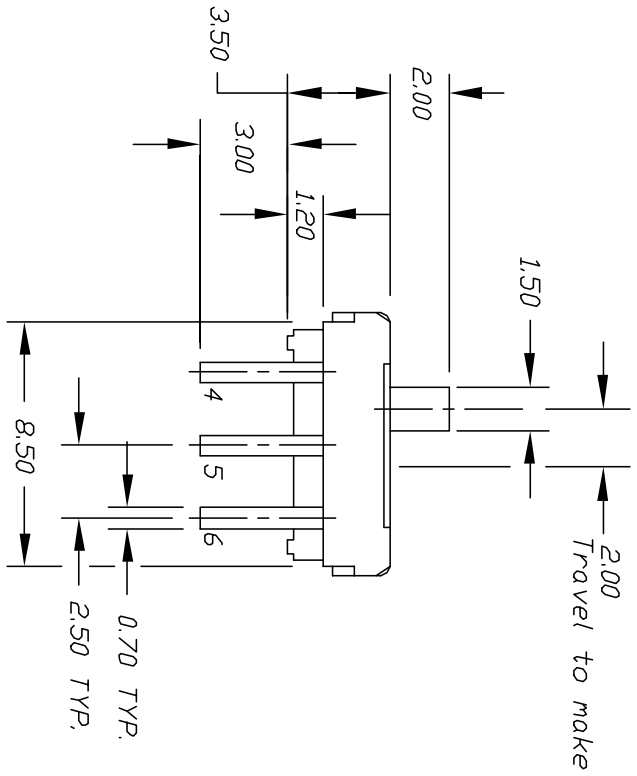
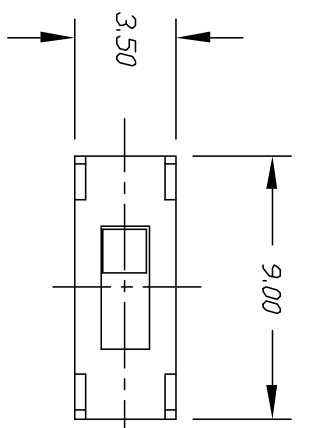

RECOMMEND P.C.B. HOLES

NOTES:

1. ALL DIMENSIONS IN MM
2. TERM. NOS. FOR REF ONLY
3. RATING: DC 6V, 0.3A
4. OPERATING FORCE: 200±150gf

REV.	DESCRIPTION	DATE	CHKD
A	RELEASED FOR PRODUCTION		

THE INFORMATION CONTAINED IN THIS DOCUMENT IS PROPRIETARY TO E-SWITCH AND IS NOT TO BE COPIED OR TRANSMITTED

TOLERANCES	
0.0	±0.4
0.00	±0.25

SCALE	DATE	DR	DWG	REV
4:1	5/19/97	NM	P122710	A

E-SWITCH®

EG 2271

CONTACT CONFIGURATION

