

Excellent Integrated System Limited

Stocking Distributor

Click to view price, real time Inventory, Delivery & Lifecycle Information:

[Molex Connector Corporation](#)
[0732510410](#)

For any questions, you can email us directly:

sales@integrated-circuit.com

SD-73251-041

MATERIALS AND FINISHES:

BODY STAINLESS STEEL
PASSIVATED

CENTER CONTACT BERYLLIUM COPPER
PLATED GOLD

INSULATOR TEFLON

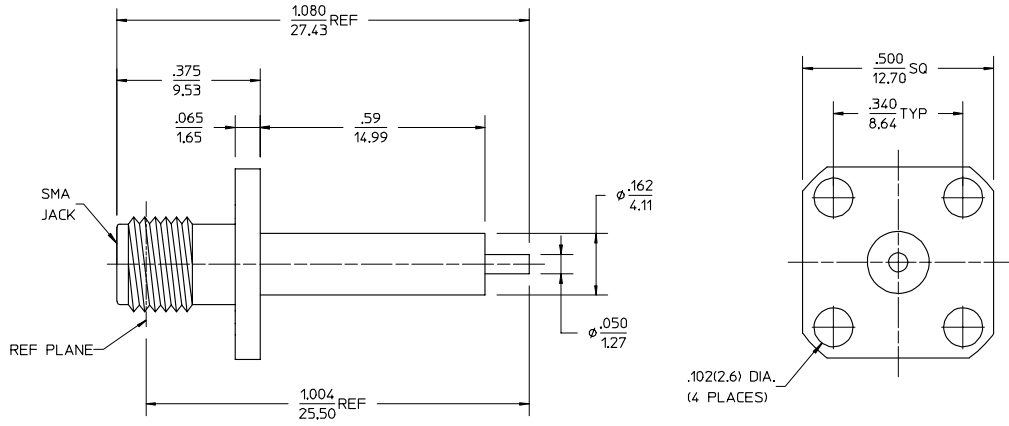

PART # 73251-0410

MIL-STD-348, FIGURE 310-2	INTERFACE
PS-89675-2820	ELECTRO/MECH PERFORMANCE

SPECIFICATION	DESCRIPTION
---------------	-------------

CHG: 59 WAS .590	EC NO. UPE-770	EC NO. UPE-699	REV 1 WAS A SINK	EC NO. REF-0013	QUALITY SYMBOLS	GENERAL TOLERANCES: (UNLESS SPECIFIED)	SCALE	DESIGN UNITS	THIRD ANGLE PROJECTION	DIMENSIONS:	SHT	REV
DRWN: JDX 04/11/03	CHG: SSS 04/11/03	DRWN: TEE 04/01/03	EC NO 003 WAS CANCELLED	DRWN: EDC 12/10/97	MAJOR	mm	INCH	mm	INCH	mm	1	A1
APPR: GMH 04/11/03	CHG: NEW RELEASE	CHG: SSS 04/01/03	REMOVED MIL SPECS FROM MATERIAL AND FINISHES	CHG: DHG 01/09/98	CRITICAL	INCH	mm	INCH	mm	mm ONLY	1	A1
		APPR: JM 04/01/03		APPR: GMH 01/09/98		±.0005	±.005	mm	INCH	mm ONLY	1	A1
						±.01	±.1	mm	INCH	mm ONLY	1	A1
						ANGULAR ± 1/2°		mm	INCH	mm ONLY	1	A1

UNLESS OTHERWISE SPECIFIED DIMS ARE INCHES AND ANGLES ARE DEGREES.
 1. $\sqrt{63}$ ALL OVER.
 2. NO CHATTER OR NON-UNIFORM SURFACE FINISH ALLOWED.
 3. PARTS TO BE FREE OF BURRS & SHARP EDGES .005 MAX BREAK.
 4. EXTERNAL THREADS TO BE ROLLED OR SINGLE POINT.
 5. DIAMETERS TO BE CONCENTRIC WITHIN .003 TIR.

GENERAL TOLERANCES: (UNLESS SPECIFIED)	SCALE	DESIGN UNITS	THIRD ANGLE PROJECTION	DIMENSIONS:	SHT	REV
4 PLACES ±.0005	mm	INCH	mm	mm	1	A1
3 PLACES ±.005	INCH	mm	INCH	mm ONLY	1	A1
2 PLACES ±.01					1	A1
1 PLACE ±.1					1	A1
ANGULAR ± 1/2°					1	A1

DRAWN BY & DATE EDC 12/10/97	TITLE: SMA JACK, RECEPTACLE, 4 HOLE FLANGE MOUNT, EXTENDED DIELECTRIC POST SMA-SDJR/F	MATERIAL NO. SEE NOTE	DRAWING NO. SD-73251-041	SHEET NO. 1 of 1
CHECKED BY & DATE DHG 01/09/98				
APPROVED BY & DATE GMH 01/09/98				
CAD FILENAME				
THIS DRAWING CONTAINS INFORMATION THAT IS PROPRIETARY TO MOLEX INCORPORATED AND SHOULD NOT BE USED WITHOUT WRITTEN PERMISSION.				

UBORD.DGN REV A 96/06/12 LEVEL 4

9 8 7 6 5 4 3 2 1