

Excellent Integrated System Limited

Stocking Distributor

Click to view price, real time Inventory, Delivery & Lifecycle Information:

[Molex Connector Corporation](#)
[0752341478](#)

For any questions, you can email us directly:

sales@integrated-circuit.com

20 19 18 17 16 15 14 13 12 11 10 9 8 7 6 5 4 3 2 1

I-TRAC BACKPLANE BOARD LAYOUT

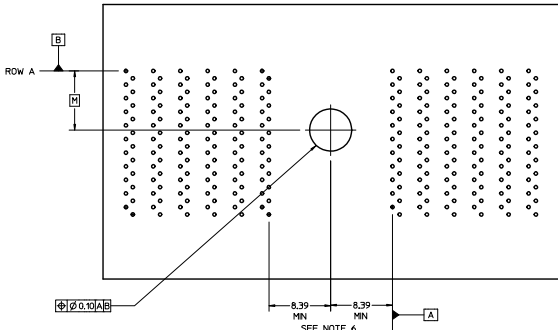

(CONNECTOR SIDE)
(11 ROW SHOWN)

IMPACT BACKPLANE BOARD LAYOUT

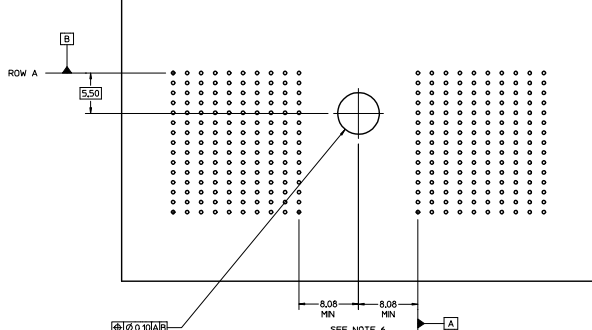

(CONNECTOR SIDE)
(5 PAIR SHOWN)

# OF ROWS	DM W
7 ROW	6.19
11 ROW	8.04
15 ROW	8.04

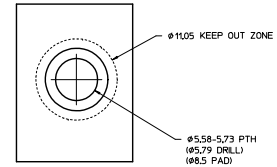
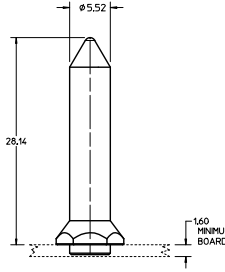

- NOTES:
1. MATERIAL: STAINLESS STEEL CL303 OR 303.
 2. FINISH: PASSIVATE.
 3. THE PLATED THROUGH HOLE REQUIREMENT APPLIES TO THE ESD GROUND OPTION ONLY. THE UNGROUNDED VERSION USES A #538-573 UNPLATED SCREW HOLE.
 4. PLATED THRU HOLE TO CONNECT TO CHASSIS FOR GROUNDED GUIDE PIN.
 5. INSTALLATION TORQUE SPECIFICATIONS:
7.8 - 8.5 N-LS.
 6. THIS DIMENSION IS RELATED TO THE GUIDE MODULE SPACING ON THE DAUGHTERCARD SIDE. AS THIS DIMENSION INCREASES THE DAUGHTERCARD TO GUIDE MODULE SPACING MUST ALSO INCREASE.
 7. THIS DRAWING SHOWS IMPACT AND I-TRAC FOR REFERENCE PURPOSES. THIS GUIDE PIN IS A STANDALONE UNIT AND CAN BE USED WITH MANY MOLEX CONNECTORS.
 8. FOR DETAILED SIGNAL CONNECTOR BOARD LAYOUTS PLEASE SEE THE SALES DRAWING FOR THE SPECIFIC PART NUMBER.
 9. PARTS TO BE SHIPPED WITH 6-32 SQUARE CONICAL MACHINE SCREW P/N 73774-3005.
 10. THIS PART CONFORMS TO CLASS B REQUIREMENTS OF COSMETIC SPEC PS-45499-002.

DRAWN BY: JLAURX CHECKED: JLAURX APPROVED: JLAURX DATE: 2008/11/20	QUALITY SYMBOLS 4 PLACES ± 0.05 3 PLACES ± 0.10 2 PLACES ± 0.13 1 PLACE ± 0.15 ANGULAR ± 2°	GENERAL TOLERANCES (UNLESS SPECIFIED) DIMENSION STYLE: MM ONLY SCALE: 4:1 DESIGN UNITS: METRIC THIRD ANGLE PROJECTION	DRAWN BY: JLAURX DATE: 2008/11/20 CHECKED BY: JLAURX DATE: 2008/11/20 APPROVED BY: JLAURX DATE: 2008/11/20	TITLE: STAND ALONE GUIDE PIN KIT FOR PRATE CANNON (5.52 DIA INT'L THREAD) MATERIAL NO: 75234-1478 DOCUMENT NO: SD-75234-478 SHEET NO: 1 OF 2
	DRAFT WHERE APPLICABLE MUST REMAIN WITHIN DIMENSIONS			
	SIZE D THIS DRAWING CONTAINS INFORMATION THAT IS PROPRIETARY TO MOLEX INCORPORATED AND SHOULD NOT BE USED WITHOUT WRITTEN PERMISSION			
	MOLEX INCORPORATED			

20 19 18 17 16 15 14 13 12 11 10 9 8 7 6 5 4 3 2 1

IMPEL BACKPLANE BOARD LAYOUT

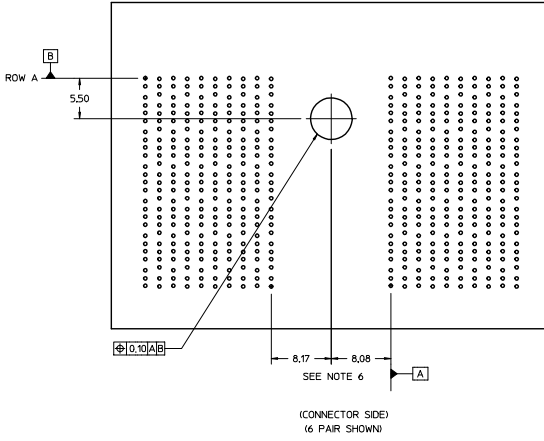

SEE SHEET 1 EC NO. 075234-3962 DRAWING APPROVAL CHECKED: JLAURX APPROVED: JLAURX DATE: 2008/11/20	QUALITY SYMBOLS	GENERAL TOLERANCES (UNLESS SPECIFIED)	DRAGON STYLE	SCALE	DESIGN UNITS	THIRD ANGLE PROJECTION
	∇=0 ∇=0 ∇=0	mm INCH 4 PLACES ± --- ± --- 3 PLACES ± --- ± --- 2 PLACES ± 0.13 ± --- 1 PLACE ± --- ± --- 0 PLACE ± --- ± ---	MM ONLY DRAWN BY: JMENDOZA CHECKED BY: JLAURX APPROVED BY: JLAURX DATE: 2008/11/20	4:1	METRIC	THIRD ANGLE PROJECTION TITLE: STAND ALONE GUIDE PIN KIT FOR PRATE CANNON (5.52 DIA. INT'L. THREAD)
	ANGULAR ± 2 ° DRAFT WHERE APPLICABLE MUST REMAIN WITHIN DIMENSIONS	MATERIAL NO. SEE CHART	DOCUMENT NO. SD-75234-478			SHEET NO. 2 OF 2
	THIS DRAWING CONTAINS INFORMATION THAT IS PROPRIETARY TO MOLEX INCORPORATED AND SHOULD NOT BE USED WITHOUT WRITTEN PERMISSION					