

Excellent Integrated System Limited

Stocking Distributor

Click to view price, real time Inventory, Delivery & Lifecycle Information:

[Molex Connector Corporation](#)
[0762790416](#)

For any questions, you can email us directly:

sales@integrated-circuit.com

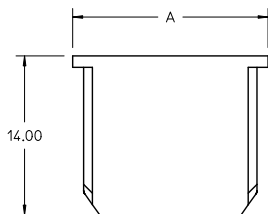

SEE NOTE 2

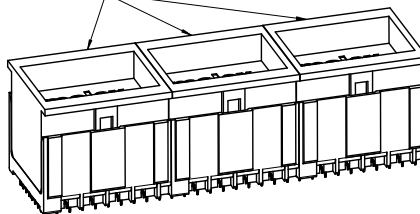
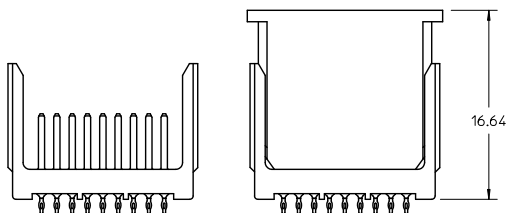
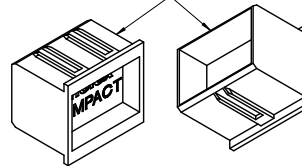
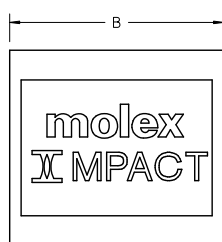
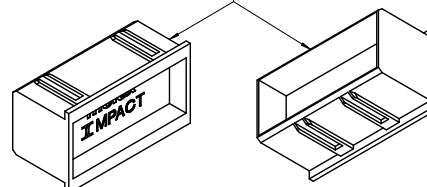
3-PAIR 10-COLUMN
PROTECTIVE COVER3-PAIR 16-COLUMN
PROTECTIVE COVER

NOTES:

1. MATERIAL: HIGH IMPACT POLYSTYRENE
COLOR: NATURAL
2. CONNECTORS WITH HEADER COVERS ARE END TO END STACKABLE.
3. PACKAGE PER: PK-70873-804
4. THIS PART CONFORMS TO MOLEX PRODUCT SPECIFICATION: PS-75710-999
5. THIS PART CONFORMS TO CLASS B REQUIREMENTS OF COSMETIC SPEC PS-45499-002.

PART NUMBER	NUMBER OF PAIRS	NUMBER OF COLUMNS	DIM "A"	DIM "B"	TOOLED
76279-0210	2 PAIR	10 COLUMN	13.15	18.82	N/A
76279-0216	2 PAIR	16 COLUMN	13.15	30.22	N/A
76279-0310	3 PAIR	10 COLUMN	17.20	18.82	YES
76279-0316	3 PAIR	16 COLUMN	17.20	30.22	
76279-0408	4 PAIR	8 COLUMN	21.25	15.02	YES
76279-0410	4 PAIR	10 COLUMN	21.25	18.82	
76279-0416	4 PAIR	16 COLUMN	21.25	30.22	
76279-0510	5 PAIR	10 COLUMN	25.30	18.82	
76279-0516	5 PAIR	16 COLUMN	25.30	30.22	N/A
76279-0610	6 PAIR	10 COLUMN	29.35	18.82	
76279-0614	6 PAIR	14 COLUMN	29.35	26.42	YES
76279-0616	6 PAIR	16 COLUMN	29.35	30.22	

ADD 6X14 & 4X8
EC NO: UCP2014-2883
DRWN:JB INGHAM 2011/03/21
CHKD:JB INGHAM 2011/05/24
APPR:JB INGHAM 2011/05/25
REV
DESCRIPTIONQUALITY
SYMBOLS
▽=0
▽=0GENERAL TOLERANCES
(UNLESS SPECIFIED)
mm INCH
4 PLACES ± --- ± ---
3 PLACES ± --- ± ---
2 PLACES ± 0.13 ± ---
1 PLACE ± 0.25 ± ---
ANGULAR ± 1/2°
DRAFT WHERE APPLICABLE
MUST REMAIN
WITHIN DIMENSIONSDIMENSION STYLE
IN/MM
DRAWN BY
J MENDOZA
DATE
2008/12/17
CHECKED BY
JB INGHAM
DATE
2008/12/17
APPROVED BY
JB INGHAM
DATE
2009/12/29
MATERIAL NO.
SEE CHART
SIZE
CSCALE
4:1
DESIGN UNITS
INCH
THIRD ANGLE
PROJECTION
TITLE
IMPACT BP ASSY
PROTECTIVE HEADER COVERS
MOLEX INCORPORATED
DOCUMENT NO.
SD-76279-001
SHEET NO.
1 OF 1
THIS DRAWING CONTAINS INFORMATION THAT IS PROPRIETARY TO MOLEX
INCORPORATED AND SHOULD NOT BE USED WITHOUT WRITTEN PERMISSION