

Excellent Integrated System Limited

Stocking Distributor

Click to view price, real time Inventory, Delivery & Lifecycle Information:

[Molex Connector Corporation](#)
[0830410062](#)

For any questions, you can email us directly:

sales@integrated-circuit.com

REV	DATE	ECN NO.	APPVD BY	REL BY
B	22FEB00	UM2000-0452		

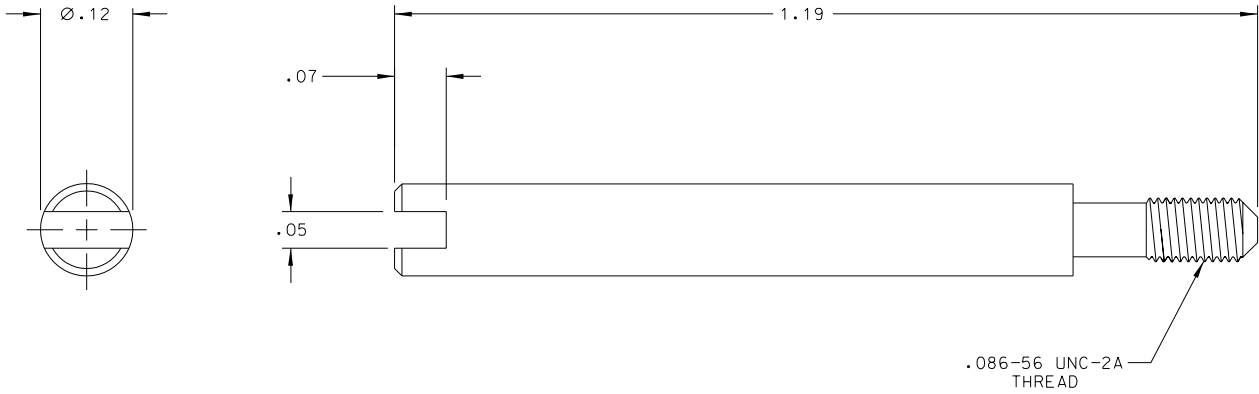

1. MATERIAL: CRES 303, ASTM-A582, PASSIVATE PER QQ-P-35.

NOTES: UNLESS OTHERWISE SPECIFIED.

QUALITY SYMBOLS MAJOR $\nabla = 0$ CRITICAL $\nabla / C = 0$ SPC $\nabla / S = 0$	UNLESS SPECIFIED: ALL DIMENSIONS IN INCHES	SCALE 8 : 1	DWG SIZE B	THIRD ANGLE PROJECTION	REVISE ON CAD ONLY	
	GENERAL TOLERANCES: 3 PLACES $\pm .005$ 2 PLACES $\pm .010$ ANGULAR $\pm 2^\circ$	DRAWN BY & DATE D.URBACH 25FEB00	TITLE: 2-56 JACKSCREW, ROUND SLOTTED, SPECIAL			
	Milti-Mate CAGE CODE 58967	CHECKED BY & DATE	APPROVED BY & DATE	MOLEX INCORPORATED Orange, CA 92868		
		PART NO. 830410062	DRAWING NO. SD-83041-0062	SHEET NO. 1 OF 1	REV B	THIS DRAWING CONTAINS INFORMATION THAT IS PROPRIETARY TO MOLEX INCORPORATED AND SHOULD NOT BE USED WITHOUT WRITTEN PERMISSION.