

## Excellent Integrated System Limited

Stocking Distributor

Click to view price, real time Inventory, Delivery & Lifecycle Information:

[Molex Connector Corporation](#)  
[1050801001](#)

For any questions, you can email us directly:

[sales@integrated-circuit.com](mailto:sales@integrated-circuit.com)

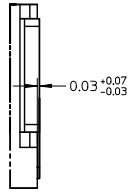
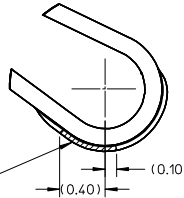
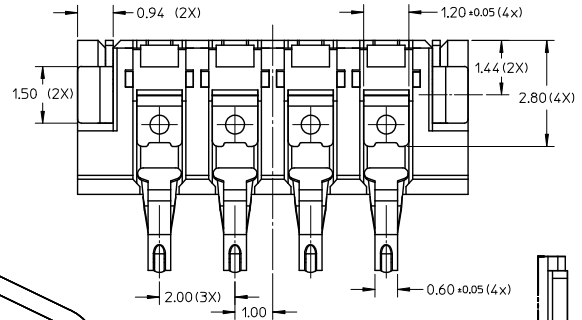
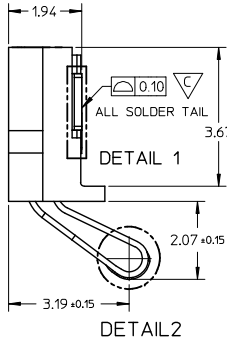
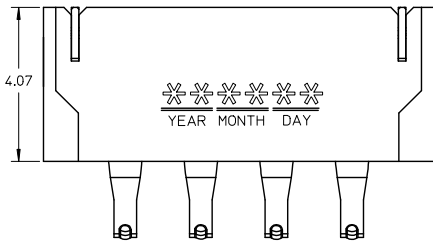
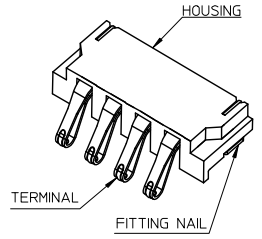
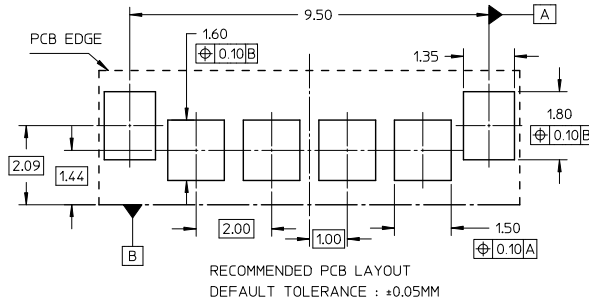
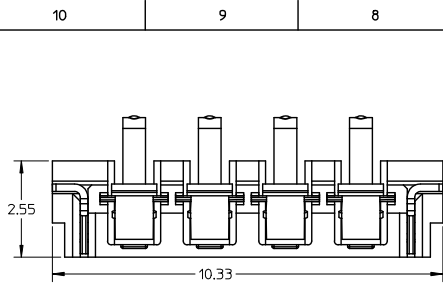

- NOTES:
- MATERIAL:  
TERMINAL : BERYLLIUMCOPPER  
HOUSING : HIGH TEMPERATURE THERMAL PLASTIC  
FITTING NAIL : BRASS
  - FINISH:  
TERMINAL : 50μ Min NICKEL UNDER PLATED  
30μ Min GOLD PLATING ON CONTACT AREA  
GOLD FLASH ON SOLDERING AREA  
FITTING NAIL : 100μ Min TIN ALLOY OVER 50μ Min NICKEL OVERALL
  - PRODUCT SPECIFICATION : PS-105080-001
  - PACKAGE SPECIFICATION : PK-47618-001
  - NORMAL FORCE SPEC:  
COMPRESS 1.37MM, READING DATA AT LOADING CURVE  
45+/-25gf AT 0.63mm DEFLECTION  
70+/-25gf AT 1.0mm DEFLECTION  
210gf MAX AT 1.37mm DEFLECTION
  - COMPLIANT TO RoHS DIRECTIVE 2002/95/EC  
AND ELV DIRECTIVE 2000/53/EC

NEW RELEASE EC NO: SH2009-0629 DRAWN: YPWU CHKD: JHWANG APPR: JHWANG	QUALITY SYMBOLS ▽=0 ▽=2	GENERAL TOLERANCES (UNLESS SPECIFIED)		DIMENSION STYLE MM ONLY		SCALE 10:1	DESIGN UNITS METRIC	THIRD ANGLE PROJECTION	
		4 PLACES ± --- ± ---	3 PLACES ± --- ± ---	2 PLACES ± 0.13 ± ---	1 PLACE ± --- ± ---	ANGULAR ± 3°	DRAWN BY JYANG13 2008/12/02	CHECKED BY YLZHUO2 2008/12/02	APPROVED BY JHWANG 2008/12/02
DRAFT WHERE APPLICABLE MUST REMAIN WITHIN DIMENSIONS		MATERIAL NO. 1050801001		DOCUMENT NO. SD-105080-001		SALES DRAWING 4 PIN 2.0MM PITCH BATTERY CONNECTOR MOLEX INCORPORATED			
SIZE A3		THIS DRAWING CONTAINS INFORMATION THAT IS PROPRIETARY TO MOLEX INCORPORATED AND SHOULD NOT BE USED WITHOUT WRITTEN PERMISSION							SHEET NO. 1 OF 1