

Excellent Integrated System Limited

Stocking Distributor

Click to view price, real time Inventory, Delivery & Lifecycle Information:

[Molex Connector Corporation](#)
[1060630500](#)

For any questions, you can email us directly:

sales@integrated-circuit.com

CONNECTOR P/N	Ø (In)	FERRULE MATERIAL	BOOT COLOR	HOUSING COLOR	CONNECTOR TYPE
106063-0500	127	Zr	BLUE	BLUE	MULTIMODE
106063-0520			BEIGE	BEIGE	
106063-0560			BLACK	BLACK	
106063-0590			RED	RED	
106063-2510	125.5	Zr	YELLOW	BLUE	SINGLE MODE
106063-2500			BLACK	BLACK	
106063-2570			RED	RED	
106063-2580			BLUE	BLUE	
106063-3500	128	Zr	BEIGE	BEIGE	MULTIMODE
106063-3560			BLACK	BLACK	
106063-3570			RED	RED	
106063-3580			YELLOW	BLUE	
106063-4500	125	Zr	BLACK	BLACK	SINGLE MODE
106063-4510			RED	RED	
106063-5500	126	Zr	BLACK	BLACK	SINGLE MODE
106063-5590			RED	RED	
106063-5570			YELLOW	BLUE	
106063-5580	127	Zr	BLACK	BLACK	SINGLE MODE
106063-7500			RED	RED	
106063-3540	128	Zr	BEIGE	BEIGE	MULTIMODE

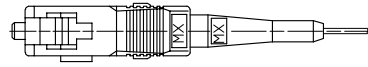

VIEW A
SCALE 2.5:1

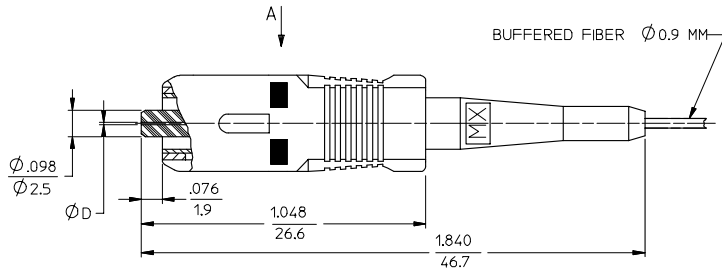
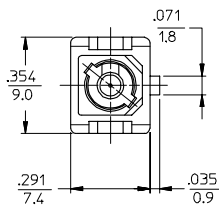

NOTES:

1. ALL DIMENSIONS ARE FOR REFERENCE ONLY.

*2. P/N 106063-0590, P/N 106063-5590, P/N 106063-3540 AND P/N 106063-0520 ARE BULK PACKED IN QUANTITIES OF 100PCS.

ENTER DESCRIPTION EC NO: MF2006-0424 DRAWN/PACIFIC I CHKD: 2006/07/24 APPR: IGMIN 2006/07/24	QUALITY SYMBOLS ▽=0 ▽=0	GENERAL TOLERANCES (UNLESS SPECIFIED)		DIMENSION STYLE	SCALE	DESIGN UNITS	THIRD ANGLE PROJECTION
		4 PLACES ± --- ± ---	mm	INCH ONLY	4:1	INCH	
B	REV	3 PLACES ± --- ± ---	INCH	DRAWN BY	DATE	TITLE	
		2 PLACES ± --- ± ---		PACIFIC I	2005/12/22	SC BARE FIBER CONNECTOR	
		1 PLACE ± --- ± ---		CHECKED BY	DATE		
		ANGULAR ±1/2°		APPROVED BY	DATE	MOLEX INCORPORATED	
		DRAFT WHERE APPLICABLE MUST REMAIN WITHIN DIMENSIONS		MATERIAL NO.	DOCUMENT NO.	SHEET NO.	
				SEE TABLE	SD-106063-X5X0	1 OF 1	
				THIS DRAWING CONTAINS INFORMATION THAT IS PROPRIETARY TO MOLEX INCORPORATED AND SHOULD NOT BE USED WITHOUT WRITTEN PERMISSION			