



Excellent Integrated System Limited

Stocking Distributor

Click to view price, real time Inventory, Delivery & Lifecycle Information:

[TE Connectivity AMP Connectors](#)
[640862-3](#)

For any questions, you can email us directly:

sales@integrated-circuit.com

REV	DATE	BY	CHKD	DESCRIPTION
0	2010-07-12	R	ECO-07-012897	

- MATERIAL: POLYESTER UL94V-0 (WHITE). CONTACTS: 0.50 [012] THK COPPER ALLOY.
- CONTACT ACCEPT #24 AWG WIRE WITH 2.41 [095] MAXIMUM INSULATION DIAMETER.
- CONNECTOR MATES WITH 1.57±0.20 [062±.008] THICK PC BOARD.
- HOUSING FEATURES: CLOSED END, STANDARD MOUTH WITHOUT MOUNTING EARS.

- CONTACT FINISH: BRIGHT TIN—LEAD 0.00203 [000080] MIN THK.
- CONTACT FINISH: MATTIE WHISKER MITIGATED TIN 0.00203 [000080] MIN THICKNESS OVER NICKEL UNDERPLATE.

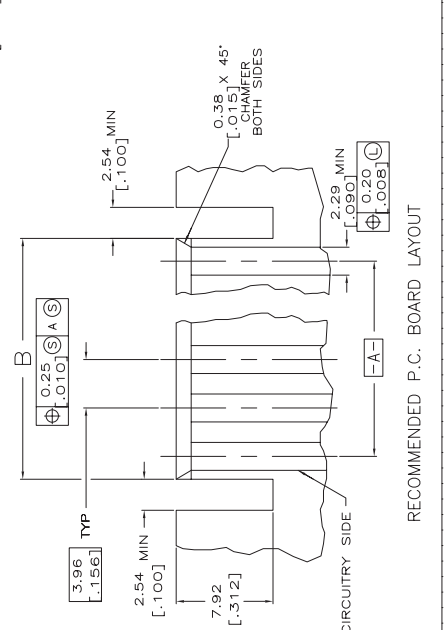
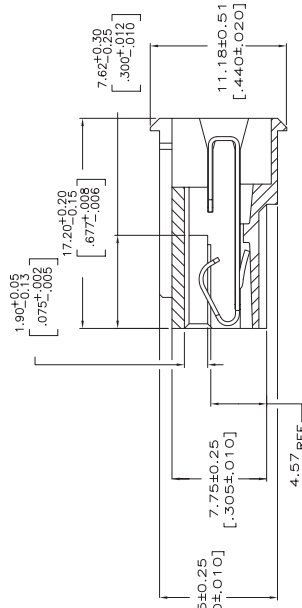
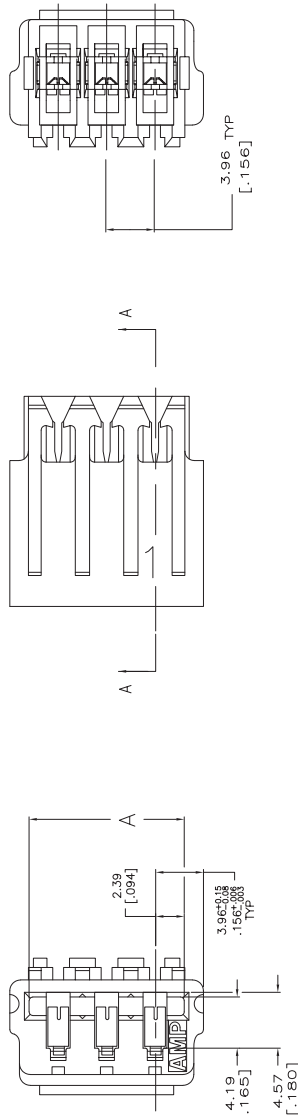

CONTACT FINISH	B	A	NO. OF CIRCUITS	PART NUMBER
△	95.50 [3.760]	95.91 [3.776]	24	5-640862-4
	91.54 [3.604]	91.95 [3.620]	23	5-640862-3
	87.58 [3.448]	87.99 [3.464]	22	5-640862-2
	83.62 [3.292]	84.02 [3.308]	21	5-640862-1
	79.65 [3.136]	80.06 [3.152]	20	5-640862-0
	71.73 [2.824]	72.14 [2.840]	18	4-640862-8
	59.84 [2.356]	60.25 [2.372]	15	4-640862-5
	47.96 [1.888]	48.36 [1.904]	12	4-640862-2
	36.07 [1.420]	36.47 [1.436]	9	3-640862-9
	24.18 [0.952]	24.59 [0.968]	6	3-640862-6
	12.29 [0.484]	12.70 [0.500]	3	2-640862-3
	95.50 [3.760]	95.91 [3.776]	24	2-640862-4
	91.54 [3.604]	91.95 [3.620]	23	2-640862-3
	87.58 [3.448]	87.99 [3.464]	22	2-640862-2
	83.62 [3.292]	84.02 [3.308]	21	2-640862-1
	79.65 [3.136]	80.06 [3.152]	20	2-640862-0
	71.73 [2.824]	72.14 [2.840]	18	1-640862-8
	59.84 [2.356]	60.25 [2.372]	15	1-640862-5
	47.96 [1.888]	48.36 [1.904]	12	1-640862-2
	36.07 [1.420]	36.47 [1.436]	9	1-640862-9
	24.18 [0.952]	24.59 [0.968]	6	1-640862-6
	12.29 [0.484]	12.70 [0.500]	3	1-640862-3

THIS DRAWING IS A CONTROLLED DOCUMENT.	REV. SALMON	10-23-91	TE Connectivity Corporation
DATE	REV.	BY	DESCRIPTION
10-23-91	1	SWING	Herbstein, Pa 17105-3608
DATE	REV.	BY	DESCRIPTION
10-23-91	1	SWING	Herbstein, Pa 17105-3608
DATE	REV.	BY	DESCRIPTION
10-23-91	1	SWING	Herbstein, Pa 17105-3608



RECOMMENDED P.C. BOARD LAYOUT