

Excellent Integrated System Limited

Stocking Distributor

Click to view price, real time Inventory, Delivery & Lifecycle Information:

[TE Connectivity Raychem Circuit Protection
SRP200](#)

For any questions, you can email us directly:

sales@integrated-circuit.com

Tyco / Electronics
Raychem Circuit Protection
 308 Constitution Drive
 Menlo Park, CA 94025-1164
 Phone: 800-227-4856
 Fax: 800-227-4866

PolySwitch®
PTC Devices
 Overcurrent Protection Device

PRODUCT: SRP200

DOCUMENT: SCD 21790
 PCN: 194020
 REV LETTER: G
 REV DATE: JULY 25, 2002
 PAGE NO.: 1 OF 1

Specification Status: RELEASED

Electrical Rating

Voltage: 30V MAX
Current: 100A MAX

Leads:

Nickel: 0.125 mm nom.

Tape:

Polyester

Marking:

- Manufacturer's Mark
- ⊗ 200 — Part Identification
- □ □ □ — Lot Identification

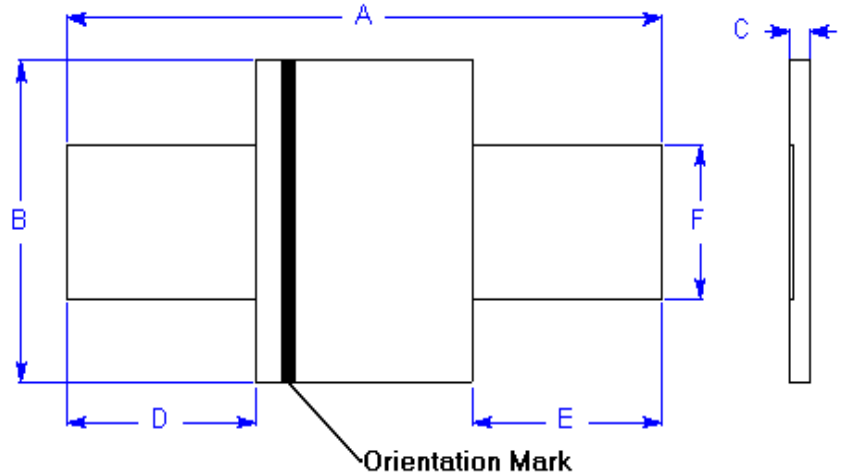

TABLE I. DIMENSIONS:

	A		B		C		D		E		F	
	MIN	MAX	MIN	MAX	MIN	MAX	MIN	MAX	MIN	MAX	MIN	MAX
mm:	21.3	23.4	10.2	11.0	0.5	1.1	5.0	7.6	5.0	7.6	4.8	5.4
in*:	(0.84)	(0.92)	(0.40)	(0.43)	(0.02)	(0.04)	(0.20)	(0.30)	(0.20)	(0.30)	(0.19)	(0.21)

*Rounded off approximation

TABLE II. PERFORMANCE RATINGS:

I HOLD	CURRENT TRIP LIMITS								TIME TO TRIP	REFERENCE RESISTANCE	ONE-HOUR POST-TRIP RESISTANCE	TRIPPED-STATE POWER DISSIPATION				
	AMPS 20°C HOLD		AMPS AT 0°C TRIP		AMPS AT 20°C HOLD TRIP		AMPS AT 60°C HOLD TRIP						AMPS AT 80°C HOLD TRIP		OHMS AT 20°C MIN MAX	
2.0	2.5	5.1	2.0	4.4	1.4	3.0	--	--	1.8	4.0	0.030	0.060	0.030	0.100	1.6	1.9

Reference Documents:
 Precedence:
 Effectivity:
 CAUTION:

PS300
 This specification takes precedence over documents referenced herein.
 Reference documents shall be the issue in effect on the date of invitation for bid.
 Operation beyond the rated voltage or current may result in rupture, electrical arcing or flame.