

## Excellent Integrated System Limited

Stocking Distributor

Click to view price, real time Inventory, Delivery & Lifecycle Information:

[TE Connectivity AMP Connectors](#)  
[534043-2](#)

For any questions, you can email us directly:

[sales@integrated-circuit.com](mailto:sales@integrated-circuit.com)



# Distributor of TE Connectivity AMP Connectors: Excellent Integrated System Limited

## Datasheet of 534043-2 - TBC RECP ASSY 540 POS 4 ROW

PRINTING MADE IN THESE ANGLES PROJECTION  
 THIS DRAWING IS UNLESS OTHERWISE SPECIFIED RELEASED FOR PUBLICATION  
 © COPYRIGHT 19 BY AMP INCORPORATED. ALL INTERNATIONAL RIGHTS RESERVED.

REV. NO.		DATE	DESCRIPTION	BY	CHKD
AD	25				
B			REDRAWN ON CAD PER ECN A55477		
C			REVISED PER ECN 0010-1013-93 T.S.		
D			ECN: 0010-1684-94		
E			REV PER ECN 001B-0195-01		

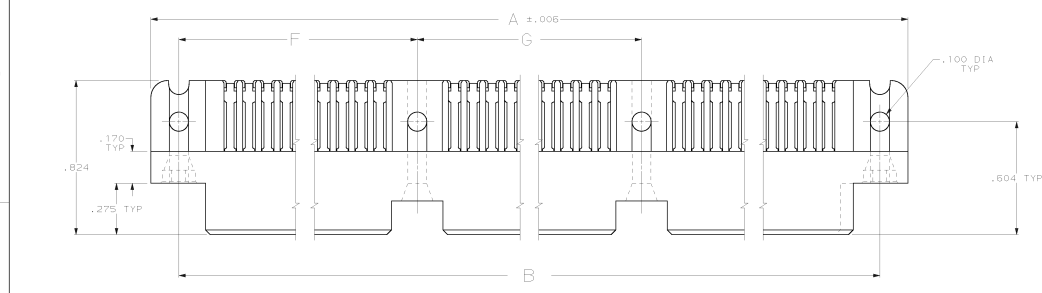

- △ HOUSING MATERIAL: THERMOPLASTIC, BLACK.
- △ CONTACT MATERIAL: COPPER ALLOY.
- △ CONTACT FINISH: .000050-.000100 NICKEL UNDERPLATE ALL OVER WITH .000030 GOLD IN CONTACT AREA AND .000100-.000200 TIN-LEAD PLATED POSTS.

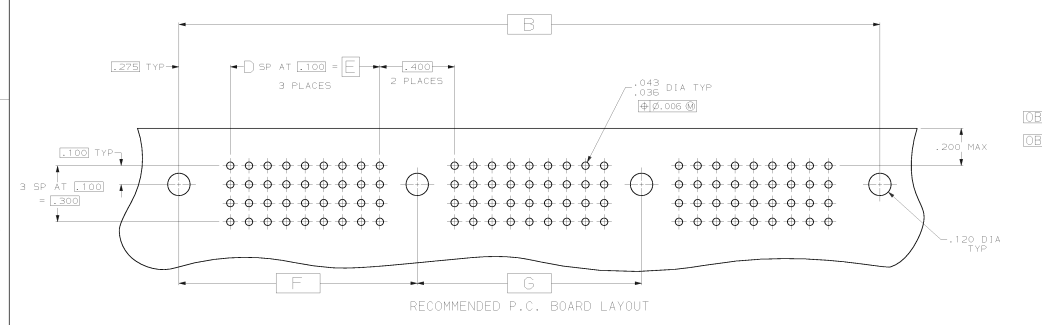
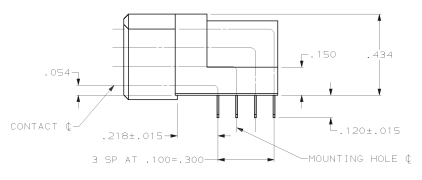
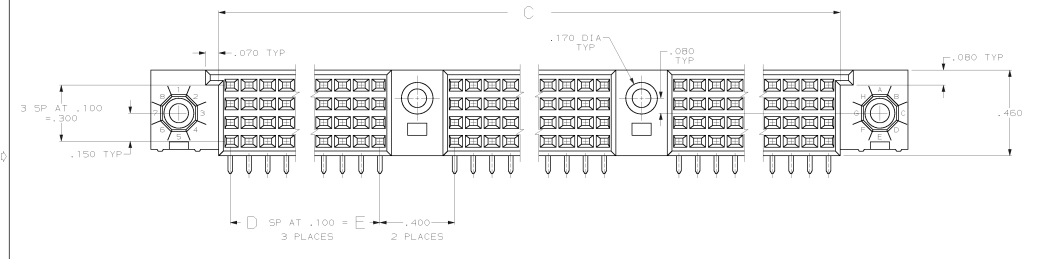

OBsolete	4,800	4,875	4,900	49	13,524	13,550	14,250	516	534043-3
	4,800	4,875	4,900	44	14,124	14,550	14,850	540	534043-2
OBsolete	4,400	4,425	4,400	40	12,324	13,350	13,650	492	534043-1

OBsolete	G	F	E	D	C	B	A	NO OF POSN	PART NUMBER
DO NOT SCALE PRINT.	DR: 6-11-81	DR: 12/10/01	DR: 12/10/01	DR: 12/10/01	DR: 12/10/01	DR: 12/10/01	DR: 12/10/01	DR: 12/10/01	DR: 12/10/01
UNLESS SPECIFIED DIMENSIONS IN INCHES	1 BALLBEIL 88	DAVID WOFFMAN	DAVID WOFFMAN	DAVID WOFFMAN	DAVID WOFFMAN	DAVID WOFFMAN	DAVID WOFFMAN	DAVID WOFFMAN	DAVID WOFFMAN
TOLERANCES ON +	AFRO: 12/10/01	WAYNE HILLHINES	WAYNE HILLHINES	WAYNE HILLHINES	WAYNE HILLHINES	WAYNE HILLHINES	WAYNE HILLHINES	WAYNE HILLHINES	WAYNE HILLHINES
3 P.L.C. DEC = .005	AFRO: 12/10/01	VAN HERTER	VAN HERTER	VAN HERTER	VAN HERTER	VAN HERTER	VAN HERTER	VAN HERTER	VAN HERTER
ANGLES = 2 -	PRODUCT SPEC	108-1098	108-1098	108-1098	108-1098	108-1098	108-1098	108-1098	108-1098
MATERIAL:	APPLICATION SPEC								
FINISH:	HEIGHT								
AMP	CASE CODE	00779	00779	00779	00779	00779	00779	00779	00779
ASSEMBLY, RECEPTACLE, TWIN SEAM CONNECTOR, 4 ROW, 2 MOUNTING HOLES, 2 GUIDE PINS, .120 POST LENGTH	DRAWING NO.	534043	534043	534043	534043	534043	534043	534043	534043
	SCALE	4:1	4:1	4:1	4:1	4:1	4:1	4:1	4:1
	SHEET	1 OF 1	1 OF 1	1 OF 1	1 OF 1	1 OF 1	1 OF 1	1 OF 1	1 OF 1