

Excellent Integrated System Limited

Stocking Distributor

Click to view price, real time Inventory, Delivery & Lifecycle Information:

[TE Connectivity AMP Connectors](#)
[1-645979-2](#)

For any questions, you can email us directly:

sales@integrated-circuit.com

4
 DRAWING MADE IN THIRD ANGLE PROJECTION
 THIS DRAWING IS UNPUBLISHED. RELEASED FOR PUBLICATION .19
 © COPYRIGHT 19 BY AMP INCORPORATED. ALL INTERNATIONAL RIGHTS RESERVED.

LOC	QTY	P	F	ZONE	LTR	REVISIONS	DATE	APPD
AG	53				E	REDWN & REV PER 0160-3551-93	5-5-84	WS

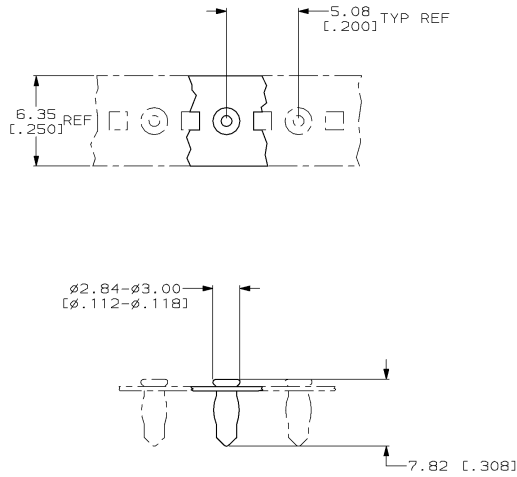

- 1 MATERIAL:
 EYELET - COPPER (QQ-C-576)
 SPRING - BERYLLIUM COPPER (QQ-C-533)
- 2 TIN PLATE (MIL-T-10727) 0.00381 [.000150] MIN THK.
- 3 TIN PLATE (MIL-T-10727) 0.00254 [.000100] MIN THK.
- 4 GOLD PL (MIL-G-45204) 0.00076 [.000030] MIN THK ON CONTACT AREA.
- 5 PACKAGED 25,000 PER REEL
- 6 TO INSURE 1/2 OZ MIN RETENTION DO NOT EXCEED 0.10 [.004] DIFFERENCE IN PIN DIA WHEN CHANGING TO A SMALLER DIA PIN
- 7 PRODUCT IS OVALIZED FOR RETENTION IN THE P.C. BOARD. THE RECOMMENDED HOLE DIAMETER IS Ø2.59 [Ø.102] MINIMUM, +0.08 [.003] MAX. PRIOR TO SOLDERING.
- 8 PACKAGED 10,000 PER REEL

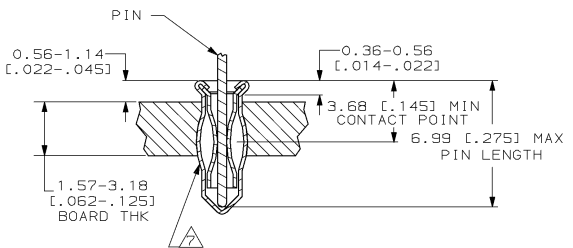

3.76-6.99 [.145-.275]	Ø1.07-Ø1.24 [Ø.042-Ø.049]	GOLD	TIN	1-645979-2
3.76-6.99 [.145-.275]	Ø1.07-Ø1.24 [Ø.042-Ø.049]	TIN	TIN	645979-1
LENGTH	DIAMETER	SPRING	EYELET	PART NO
PIN		FINISH		
DO NOT SCALE PRINT. UNLESS SPECIFIED DIMENSIONS IN mm [INCHES] TOLERANCES ON: 1 PLG DEC ± 0.20(.008) ANGLES ± -		AMP AMP Incorporated Harrisburg, PA 17105-3608 NAME: MINIATURE SPRING SOCKET ASSY SERIES 5 WITHOUT SEALANT		
FINISH: SEE TABLE		APPLICATION SPEC: 114-26004	SIZE: C	CAGE CODE: 00779
WEIGHT: -		SCALE: NTS	DRAWING NO: ©645979	SHEET: 1 OF 1

THIS DRAWING IS A CONTROLLED DOCUMENT FOR AMP INCORPORATED. IT IS SUBJECT TO CHANGE AND THE CONTROLLING ENGINEERING ORGANIZATION SHOULD BE CONTACTED FOR THE LATEST REVISION.