

Excellent Integrated System Limited

Stocking Distributor

Click to view price, real time Inventory, Delivery & Lifecycle Information:

[TE Connectivity AMP Connectors](#)
[221162-1](#)

For any questions, you can email us directly:

sales@integrated-circuit.com



1

2

3

4

THIS DRAWING IS UNPUBLISHED. RELEASED FOR PUBLICATION BY TYCO ELECTRONICS CORPORATION. ALL RIGHTS RESERVED. © COPYRIGHT		REV PER 0514-0252-04		DATE	DRW APPR
LOC	QST	PI UN	G	12-02-04	JDP GM
AJ	16				

- 1 BRASS PER QQ-B-626.
- 2 PTFE PER MIL-P-19468.
- 3 PHOSPHOR BRONZE PER QQ-B-750.
- 4 BERYLLIUM COPPER PER QQ-C-530.
- 5 TIN PLATE PER ASTM-B-545.
- 6 COPPER PLATE PER MIL-C-14550.
- 7 NICKEL PLATE PER QQ-N-290.
- 8 GOLD PLATE PER MIL-G-45204.
9. DIELECTRIC AND CONTACT ASSEMBLY WILL WITHSTAND 2.5 LB PUSHOUT FORCE DIRECTED FROM MATING END.

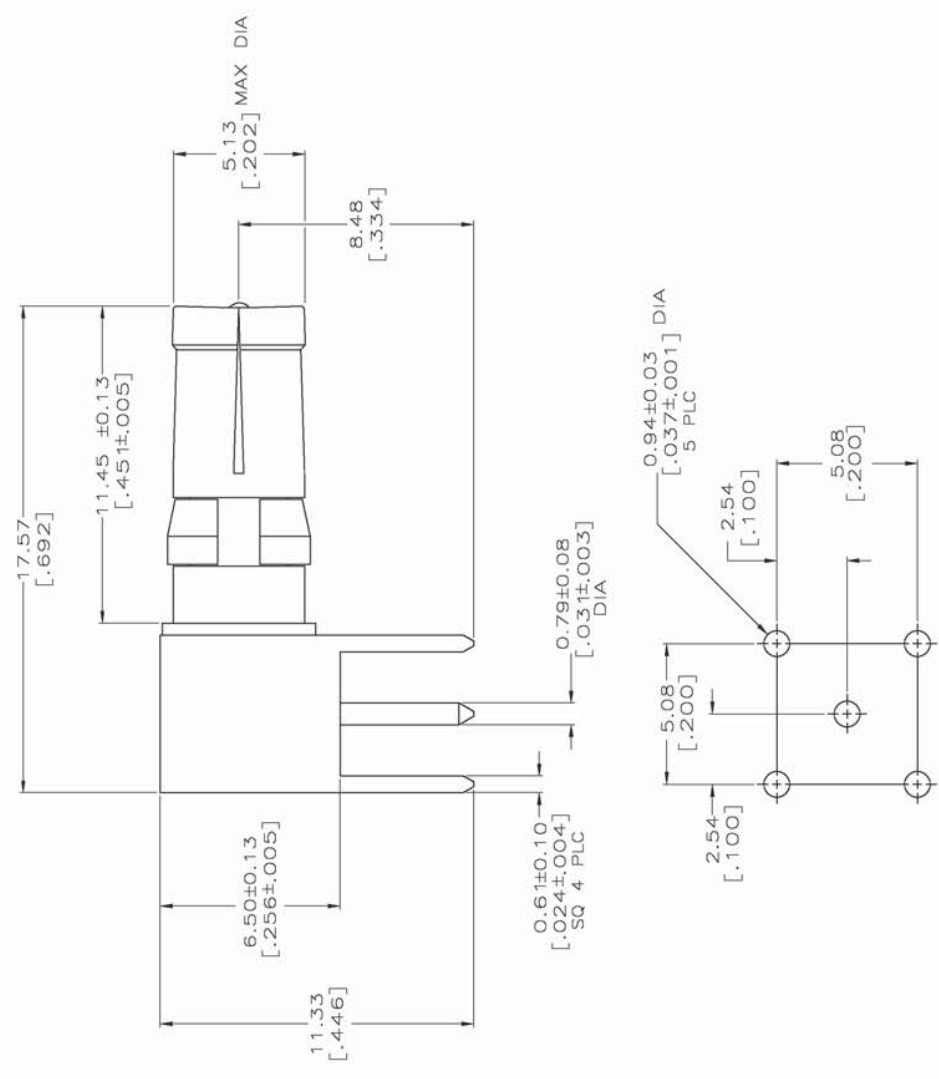

PCB CONFIGURATION

OBSOLETE	221162-2
	221162-1
	PART NUMBER

THIS DRAWING IS A CONTROLLED DOCUMENT.		DRW	B. JOHNSON	08-20-91
DIMENSIONS UNLESS OTHERWISE SPECIFIED:		CHK	B. WERNER	08-29-91
INCHES		APP	D. DOTE	09-05-91
0 PLC	#	PRODUCT SPEC		
1 PLC	#	APPLICATION SPEC		
2 PLC	#	WEIGHT		
3 PLC	#			
4 PLC	#			
5 PLC	#			
FINISH				

TYCO Electronics Corporation Harrisburg, Pa 17105-3608		SIZE	DATE	DRAWING NO	RESTRICTED TO
SOCKET, PCB, RIGHT ANGLE SIZE B, HDI		A2	00779	221162	
CUSTOMER DRAWING		SCALE	1:1	SHEET	1 OF 1