



Distributor of TE Connectivity AMP Connectors: Excellent Integrated System Limited
Datasheet of 747839-4 - D-Sub Connector Receptacle, Female Sockets 37 Position Through
Hole, Right Angle Solder

Contact us: sales@integrated-circuit.com Website: www.integrated-circuit.com

Excellent Integrated System Limited

Stocking Distributor

Click to view price, real time Inventory, Delivery & Lifecycle Information:

[TE Connectivity AMP Connectors
747839-4](#)

For any questions, you can email us directly:

sales@integrated-circuit.com



Distributor of TE Connectivity AMP Connectors: Excellent Integrated System Limited

Datasheet of 747839-4 - D-Sub Connector Receptacle, Female Sockets 37 Position Through

DISPOSITION TO SUPPLIER: 7
 REVISIONS FOR FACTORY: 7
 (BY CONTRACT ID) (BY INCORPORATED) (BY PART NUMBER)

REV	DATE	DESCRIPTION	BY	CHK	APP
1	REV PER EC 0640-0205-03		SPERB00	DO	KB
0	REV PER EC 0010-0142-00		SM NW 03	DB	JK

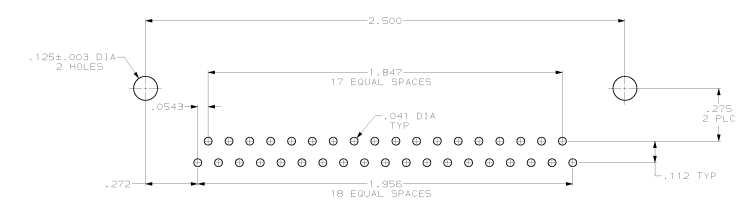
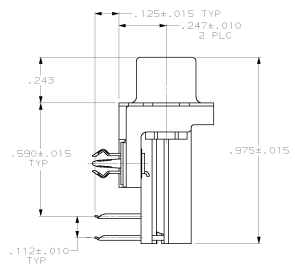
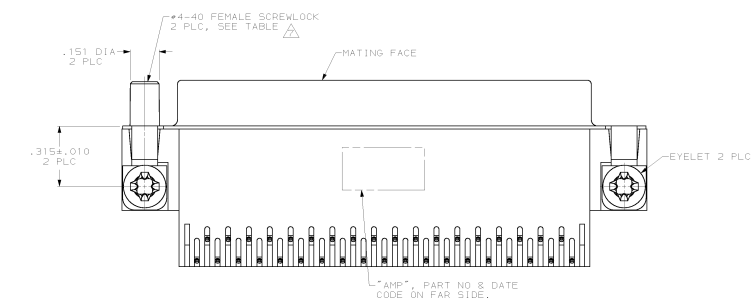
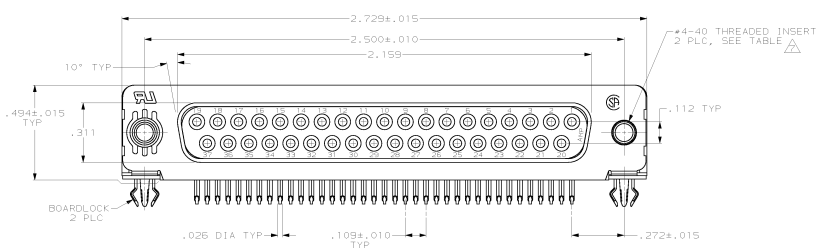

- CONNECTOR MATES WITH ANY 25 POSN PLUG IN AMPLIMITE™ SERIES.
- MOLDED PARTS: FLAME RETARDANT 94V-0 RATED THERMOPLASTIC, BLACK.
SHELL: STEEL PER ASTM A109
CONTACTS: PHOSPHOR BRONZE PER QQ-B-750
EYELETS: BRASS
SCREWLOCKS: ZINC
INSERTS: ZINC
BOARDLOCKS: COPPER ALLOY
- SHELL: .000100 MIN TIN OR TIN-LEAD
CONTACTS: SEE TABLE
EYELETS: TIN
SCREWLOCKS: CLEAR CHROMATE
BOARDLOCKS: TIN-LEAD
INSERTS: CLEAR CHROMATE
- GOLD PLATING PER MIL-G-45204, NICKEL PLATING PER QQ-N-290, TIN PLATING PER MIL-T-10727.
- GOLD FLASH FOR A DISTANCE OF .100 MIN FROM MATING END, .000100-.000200 BRIGHT TIN OR BRIGHT TIN-LEAD ON TERMINATION END, ALL OVER .000050 NICKEL ON ENTIRE CONTACT.
- .000030 GOLD FOR A DISTANCE OF .100 MIN FROM MATING END, .000100-.000200 BRIGHT TIN OR BRIGHT TIN-LEAD ON TERMINATION END, ALL OVER .000050 NICKEL ON ENTIRE CONTACT.
- SCREWLOCKS & INSERTS WILL WITHSTAND 4 IN-LBS TORQUE & 20 LBS PULL OUT FORCE FROM MATING FACE SIDE.

SUPSD BY 747839-4	FEMALE SCREWLOCKS	△	747839-6
OBSOLETE	FEMALE SCREWLOCKS	△	747839-5
SUPSD BY 747839-4	THREADED INSERTS	△	747839-4
OBSOLETE	THREADED INSERTS	△	747839-3
SUPSD BY 747839-4	.125 DIA HOLES	△	747839-2
OBSOLETE	.125 DIA HOLES	△	747839-1
	MOUNTING HARDWARE	△	PART NUMBER
	CONTACT FINISH	△	

THIS DRAWING IS A CONTROLLED DOCUMENT		REV		DATE		DESCRIPTION		BY		CHK		APP	
INCHES	MM	1	0000	06/01/00	06/01/00	RECEPTACLE ASSEMBLY, SIZE 4, 37 POSITION, RIGHT ANGLE, FRONT METAL SHELL, .590 SERIES, .026 DIA POSN, BOARDLOCK, AMPLIMITE™ 740-25	SM NW 03	DB	JK				
DATE	BY	CHK	APP	REV	DATE	DESCRIPTION	BY	CHK	APP	REV	DATE	DESCRIPTION	BY
06/01/00	SM NW 03	DB	JK	1	06/01/00	RECEPTACLE ASSEMBLY, SIZE 4, 37 POSITION, RIGHT ANGLE, FRONT METAL SHELL, .590 SERIES, .026 DIA POSN, BOARDLOCK, AMPLIMITE™ 740-25	SM NW 03	DB	JK	0	06/01/00	RECEPTACLE ASSEMBLY, SIZE 4, 37 POSITION, RIGHT ANGLE, FRONT METAL SHELL, .590 SERIES, .026 DIA POSN, BOARDLOCK, AMPLIMITE™ 740-25	SM NW 03