



**Distributor of TE Connectivity AMP Connectors: Excellent Integrated System Limited**  
Datasheet of 748389-4 - D-Sub Connector Receptacle, Female Sockets 15 Position Through  
Hole, Right Angle Solder

Contact us: [sales@integrated-circuit.com](mailto:sales@integrated-circuit.com) Website: [www.integrated-circuit.com](http://www.integrated-circuit.com)

---

## **Excellent Integrated System Limited**

Stocking Distributor

Click to view price, real time Inventory, Delivery & Lifecycle Information:

[TE Connectivity AMP Connectors  
748389-4](#)

For any questions, you can email us directly:

[sales@integrated-circuit.com](mailto:sales@integrated-circuit.com)

THIS DRAWING IS UNPUBLISHED.  
© COPYRIGHT BY TYCO ELECTRONICS CORPORATION. ALL RIGHTS RESERVED.

LOC	DIST	REVISIONS			
F	UR	DESCRIPTION	DATE	DM	APD
GP	00	AH	REVISED PER EC DS13-0307-02	12MAR03	JG CC

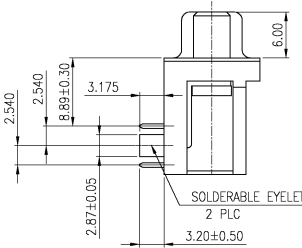
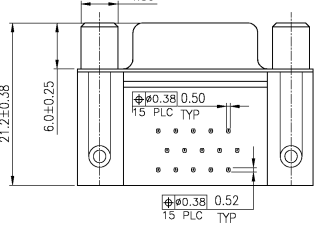
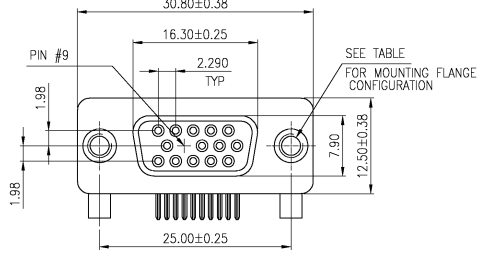
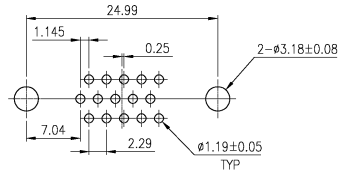
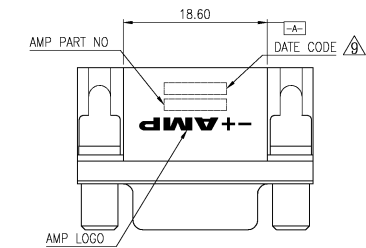

**MATERIAL:**

- Housing: PBT, 30% G.F polyester, Black. (UL 94V-0 Rated)
- Contact: Phos. Bronze.
- Contact Plated: 30u"Gold Plated over 50u" Nickel underplated.
- Solder Tail: Sn/Pb Plated 120u" over 50u" Nickel underplated.
- Shell: Steel, Nickel Plated.
- Boardlock: Brass,Tin or Sn/PB Plated 100u"
- Female Screwlock:Brass, Nickel plated 30u" Min.

⚠ Four digit date code in this format.

Year 01 45 Manufacturing Week

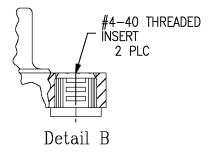
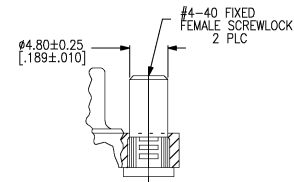

Yes	No	Tray	Detail B	Gold flash	3-748389-7
Yes	No	Tray	Detail B	15 μ	3-748389-6
No	Yes	Tray	Detail A	Gold flash	3-748389-5
No	Yes	Tray	Detail A	15 μ	3-748389-4
Yes	No	Tray	Detail B	30 μ	748389-7
No	Yes	Tray	Detail A	30 μ	748389-4

Boardlock	Solderable Eyelet	Packaging	Mounting Config	Contact Finish	AMP Part NO.
THIS DRAWING IS A CONTROLLED DOCUMENT.	DATE: 18AA2002	DR: BURWELL	18AA2002	TYCO Electronics	Typo Electronics Corporation
DRAWING NO: 748389-4	DESIGNED BY: CASH	CHK: CASH	18AA2002	NAME: AMP-LMITE HD-22,	15 POSITION RECEPTACLE, RIGHT ANGLE CAVITY #9 MOLDED
APPROVED BY: CASH	18AA2002	DATE: 18AA2002	NAME: AMP-LMITE HD-22,	15 POSITION RECEPTACLE, RIGHT ANGLE CAVITY #9 MOLDED	RESTRICTED TO
MATERIAL: -	FINISH: -	WEIGHT: -	SCALE: A2	00779	748389
CUSTOMER DRAWING		SCALE: 2:1	SHEET: 1 OF 1	REV: AH	

748389-4 SHOWN