

Excellent Integrated System Limited

Stocking Distributor

Click to view price, real time Inventory, Delivery & Lifecycle Information:

[Linx Technologies](#)
[BAT-HLD-002-THM](#)

For any questions, you can email us directly:

sales@integrated-circuit.com

REVISIONS			
REV	DESCRIPTION	DATE	APPV
A	INITIAL RELEASE OF INTERNAL DOCUMENT	2-FEB-12	SAH

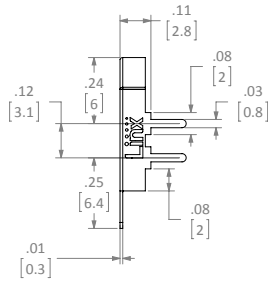
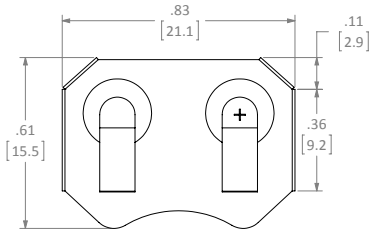
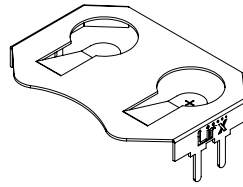

RECOMMENDED FOOTPRINT

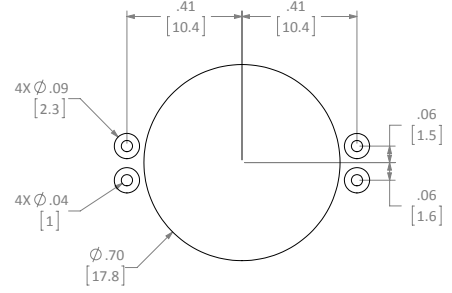

- NOTES: (UNLESS OTHERWISE SPECIFIED)
1. ALL DIMENSIONS ARE IN INCHES [mm].
 2. DIMENSIONS APPLY AFTER FINISHING.
 3. MANUFACTURE TO BE COMPLIANT WITH EU RoHS DIRECTIVE.
 4. SAFETY BREAK ALL SHARP CORNERS AND EDGES .02 MAXIMUM.

WARNING: THIS DRAWING CONTAINS PROPRIETARY INFORMATION THAT IS THE SOLE PROPERTY OF LINX TECHNOLOGIES, AND SHALL BE TREATED AS SUCH. NO DISCLOSURE OR REPRODUCTION OF THIS DOCUMENT IS PERMITTED, IN WHOLE OR IN PART, WITHOUT THE EXPRESS WRITTEN PERMISSION OF LINX TECHNOLOGIES OR ITS DESIGNATED AGENTS.

Linx 159 ORT LANE
 MERLIN, OR 97532

MATERIAL: PHOSPHOR BRONZE #C-5191
 FINISH: NICKEL PLATE

TITLE: BATTERY HOLDER OUTLINE
 CR2016, THROUGH HOLE MOUNT

INTERPRET DIMENSIONS AND TOLERANCES PER ASME Y14.5.
 SURFACE FINISH: ✓ ANGLES: ±1°
 TOLERANCES: X ±.1 .3X ±.01 .XXX ±.005

PROJECTION: **B** DWG. NO. BAT-HLD-002-THM-OTL REV A
 DRAWN: B.MURPHY DT: 2-FEB-12
 ENGR: S.HOGAN DT: 2-FEB-12 SCALE: 3:1 DO NOT SCALE DRAWING SHEET 1 OF 1