

Excellent Integrated System Limited

Stocking Distributor

Click to view price, real time Inventory, Delivery & Lifecycle Information:

[E-Switch](#)
[TL59DF160Q](#)

For any questions, you can email us directly:

sales@integrated-circuit.com

SHEET DF

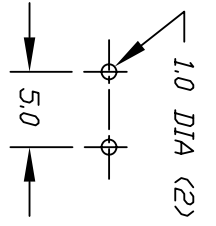
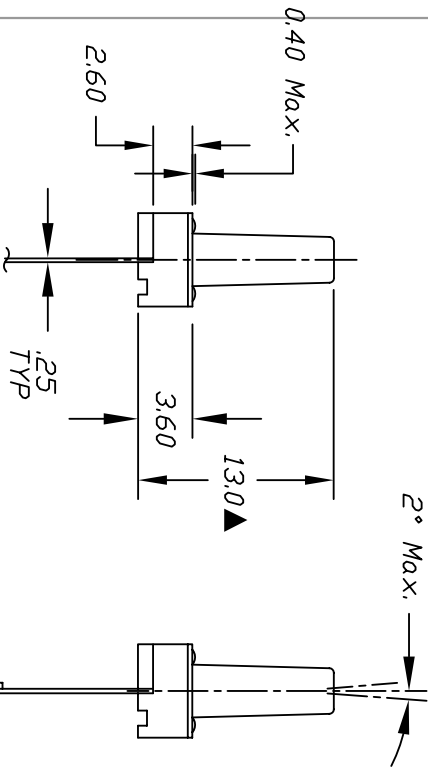
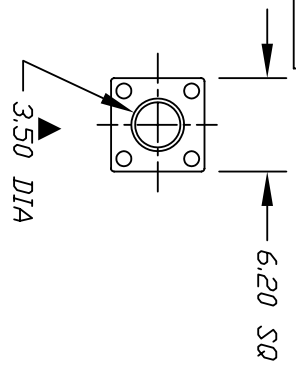

RECOMMEND P.C.B. HOLES

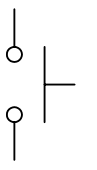

CIRCUIT: SPST

CONTACT CONFIGURATION

- NOTES:
1. ALL DIMENSIONS IN MM [INCH]
 2. GENERAL TOLERANCE: X.X=±0.4
X.XX=±0.25
 3. CONTACT RATING: 50mA @12V DC
 4. CONTACT MATERIAL: SILVER
 5. OPERATING FORCE: 160±50gf
 6. TRAVEL: 0.25 +0.2/-0.1
 7. CONTACT RESISTANCE: 100mILLI Ohms max.
 8. ELECTRICAL LIFE: 100,000 CYCLES
 9. PACKAGING:
CARRIER IS FOLDED EVERY 25 PITCHES
(24 SWITCHES PER FOLD)
(1,000) SWITCHES PER BOX
 10. 2002/95/EC (ROHS) COMPLIANT
 11. ▲ DENOTES MAJOR DIMENSION.

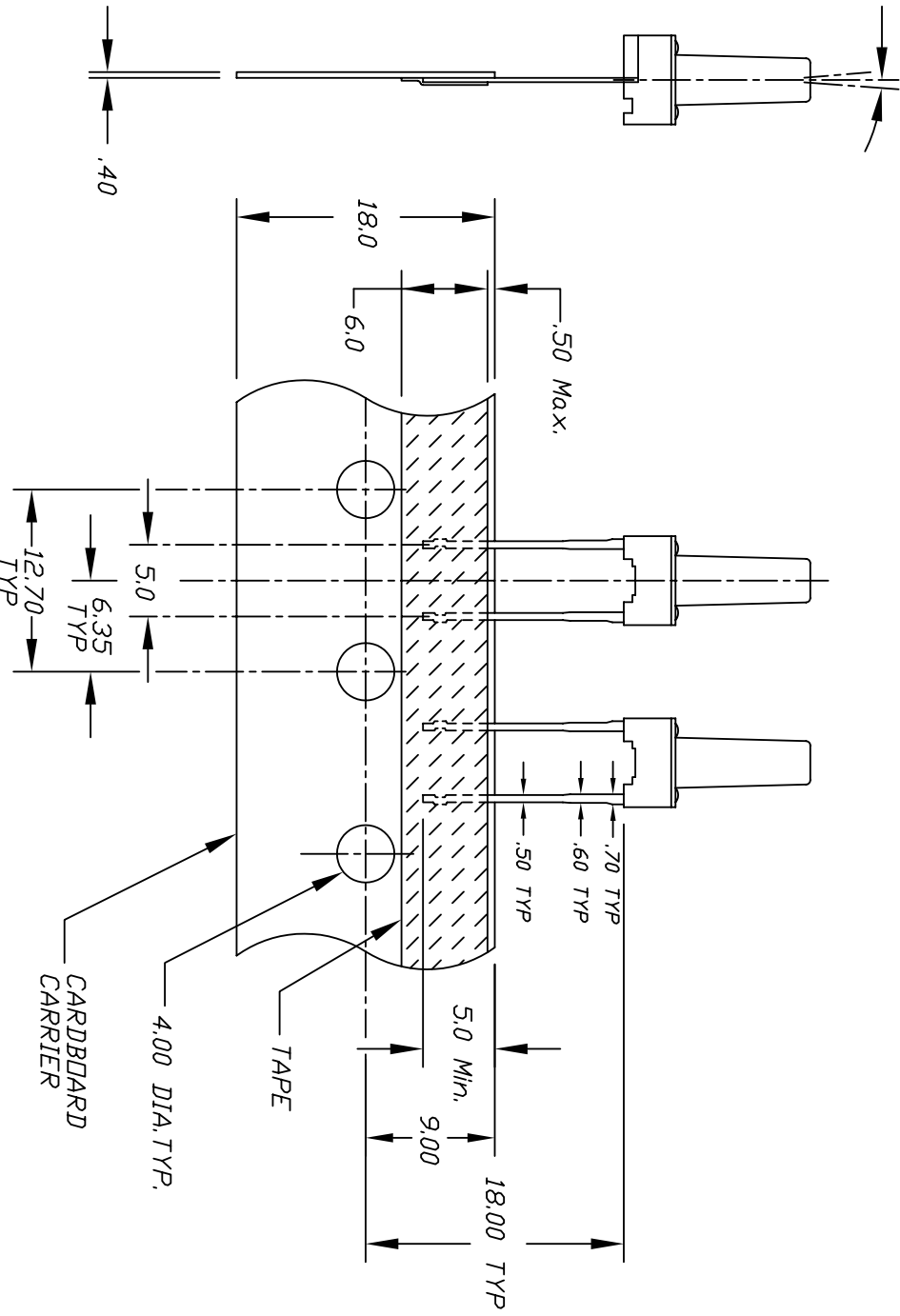

REV.	PCR	DESCRIPTION	DATE	CHKD
B	16894	UPDATE NOTES, .30 TD .25	1/19/2007	TN
A		RELEASED FOR PRODUCTION		

TOLERANCES	
0.0	±0.4
0.00	±0.25

TITLE	SCALE	DATE	DR	DWG	REV
TL59DF160Q	2:1	1/19/2007	TN	P010565	B
E-SWITCH®					
CARDBOARD CARRIER					
TAPPE					
4.00 DIA. TYP.					
5.0					
6.35 TYP					
12.70 TYP					
.50 TYP					
.60 TYP					
.70 TYP					
5.0 Min.					
9.00					
18.00 TYP					

THE INFORMATION CONTAINED IN THIS DOCUMENT IS PROPRIETARY TO E-SWITCH AND IS NOT TO BE COPIED OR TRANSFERRED