



Distributor of Molex Connector Corporation: Excellent Integrated System Limited
Datasheet of 0010101113 - Connector Receptacle 11 Position 0.200" (5.08mm) Tin Through Hole

Contact us: sales@integrated-circuit.com Website: www.integrated-circuit.com

Excellent Integrated System Limited

Stocking Distributor

Click to view price, real time Inventory, Delivery & Lifecycle Information:

[Molex Connector Corporation](#)
[0010101113](#)

For any questions, you can email us directly:
sales@integrated-circuit.com

Contact us: sales@integrated-circuit.com Website: www.integrated-circuit.com

CIRCUIT 1
SEE NOTE 8

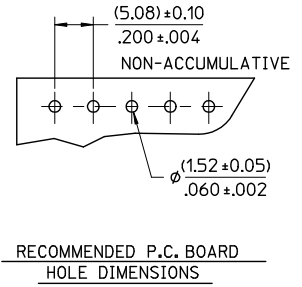
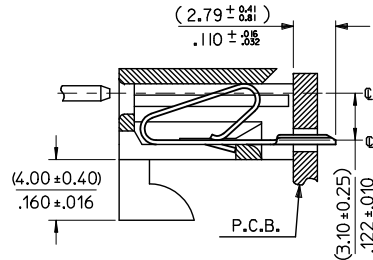
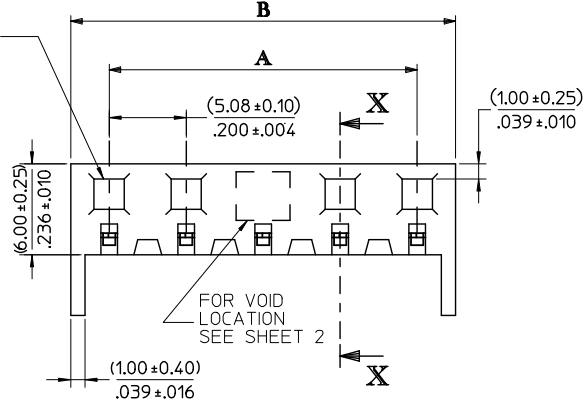

SECTION X-X

OPTIONAL CORE

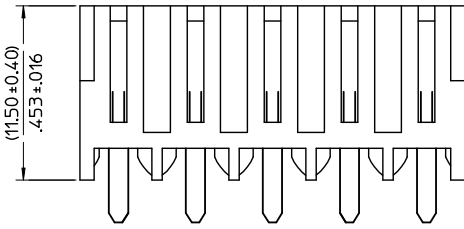
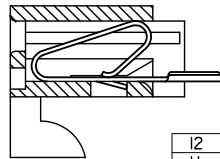

No of CIRCUITS	PART No.	ENG. No.	A		B	
			ENGLISH	METRIC		
12	10-10-1123	AE-3002-12C	2.200 ±.010	2.400 ^{+0.008} _{-.006}	55.88 ±.25	60.96 ±.2
11	↑ -1113	↑ -11C	2.000 ±.008	2.200 ^{+0.008} _{-.012}	50.80 ±.20	55.88 ±.2
10	↑ -1103	↑ -10C	1.800 ±.008	2.000 ^{+0.008} _{-.008}	45.72 ±.20	50.80 ±.2
9	↑ -1093	↑ -9C	1.600 ±.008	1.800 ^{+0.008} _{-.008}	40.64 ±.20	45.72 ±.2
8	↑ -1083	↑ -8C	1.400 ±.008	1.600 ^{+0.008} _{-.008}	35.56 ±.20	40.64 ±.2
7	↑ -1073	↑ -7C	1.200 ±.008	1.400 ^{+0.008} _{-.008}	30.48 ±.20	35.56 ±.2
6	↑ -1063	↑ -6C	1.000 ±.004	1.200 ^{+0.008} _{-.008}	25.40 ±.10	30.48 ±.15
5	↑ -1053	↑ -5C	.800 ±.004	1.000 ^{+0.008} _{-.006}	20.32 ±.10	25.40 ±.15
4	↑ -1043	↑ -4C	.600 ±.004	.800 ^{+0.008} _{-.006}	15.24 ±.10	20.32 ±.15
3	↑ -1033	↑ -3C	.400 ±.004	.600 ^{+0.008} _{-.006}	10.16 ±.10	15.24 ±.15
2	10-10-1023	AE-3002-2C	.200 ±.004	.400 ^{+0.008} _{-.006}	5.08 ±.10	10.16 ±.15

- NOTES:
 1. HOUSING : NYLON, UL94V-2, COLOR: NATURAL
 TERMINAL : PHOSPHOR BRONZE
 2. FINISH: HOT TIN DIP, (0.00254)/.000100 MIN
 3. PRODUCT SPECIFICATION : PS-99020-0087
 4. PACKAGING SPECIFICATION : PK-3002-002
 5. HOUSING SUITABLE FOR (1.14±0.15)/.045±.006 RD OR SQ. PINS
 6. HOOKS AVAILABLE ON ENDS ONLY
 7. THIS PART CONFORMS TO CLASS B REQUIREMENTS OF COSMETIC SPECIFICATION PS-45499-002
 8. CIRCUIT 1 ID. USED TO DEFINE VOID LOCATION.
 CIRCUIT 1 MAY OR MAY NOT LINE UP WITH CIRCUIT 1 OF MATING PART

REV	DESCRIPTION	QUALITY SYMBOLS	GENERAL TOLERANCES (UNLESS SPECIFIED)		DIMENSION STYLE	SCALE	DESIGN UNITS	THIRD ANGLE PROJECTION
			mm	INCH				
1	ADD PK SPEC EC NO: UCP2015-2965 DRAWN/KPPER 2015/01/22 CHKD:JBELL 2015/01/22 APPR:SMITH 2015/01/22	∇=0 ∇=0 ∇=0	4 PLACES ±.--- ±.---	3 PLACES ±.25 ±.010	2 PLACES ±.35 ±.014	1 PLACE ±.--- ±.---	0 PLACE ±. ±.	ANGULAR ±1/2°
DRAFT WHERE APPLICABLE MUST REMAIN WITHIN DIMENSIONS			SEE CHART		MATERIAL NO. DOCUMENT NO.		SHEET NO.	
			SIZE A 3		THIS DRAWING CONTAINS INFORMATION THAT IS PROPRIETARY TO MOLEX INCORPORATED AND SHOULD NOT BE USED WITHOUT WRITTEN PERMISSION		1 OF 2	

KONEKTCON & P.C. TAIL
 TERMINAL ASSEMBLY
 (5.08)/.200 PITCH
molex