

Excellent Integrated System Limited

Stocking Distributor

Click to view price, real time Inventory, Delivery & Lifecycle Information:

[Molex Connector Corporation](#)
[0008500183](#)

For any questions, you can email us directly:

sales@integrated-circuit.com

- NOTES:
 1. MATERIAL: SEE LEGEND
 2. FINISH: SEE LEGEND
 3. PRODUCT SPECIFICATION: PS-40-02
 4. DIMENSIONS GIVEN ACROSS CENTERLINES ARE SYMMETRICAL ABOUT THOSE CENTERLINES WITHIN HALF THE TOTAL TOLERANCE.
 5. CRIMP FOR 22 TO 26 GA. WIRE WITH MAX. INSULATION DIA. OF (1.65)/.005
 6. THIS PRODUCT CONFORMS TO CLASS B REQUIREMENTS OF COSMETIC SPECIFICATION PS-45499-002.

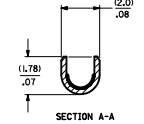
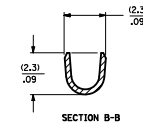
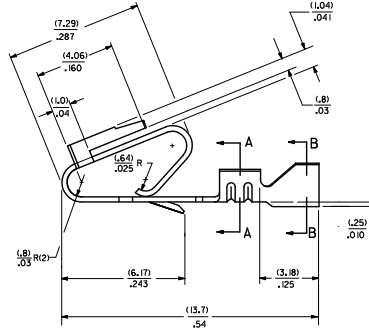
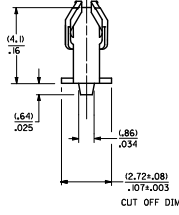
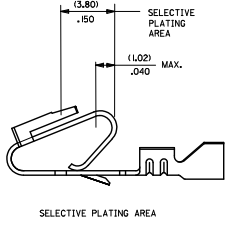
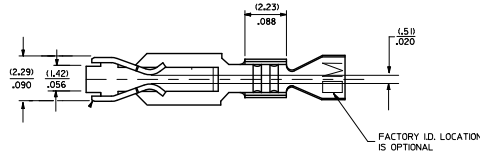

MAT'L: (L27)/.0106 THK J
 7258 FORM
 BLANK=BRASS
 A=PHOS. BRONZE
 PLATING PER SDES- 88
 BLANK+ CHAIN PER DETAIL B
 A=CHAIN PER DETAIL A
 L= LOOSE

(909) - HOT TIN DFP: 0.002541/.000100 MIN.
 (558) - SELECT GOLD: 0.000761/.000030 MIN.
 OVERALL GOLD FLASH: 0.000050/.000002 MIN.
 OVERALL NICKEL UNDERPLATE: 0.001271/.000050 MIN.
 (561) - SELECT GOLD: 0.000761/.000030 MIN.
 OVERALL NICKEL UNDERPLATE: 0.001271/.000050 MIN.
 (555) - SELECT GOLD: 0.000381/.000015 MIN.
 OVERALL NICKEL UNDERPLATE: 0.000761/.000030 MIN.

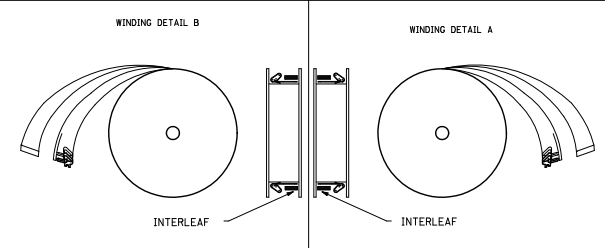

QUALITY SYMBOLS	GENERAL TOLERANCES (UNLESS SPECIFIED)		DIMENSION STYLE		SCALE	DESIGN UNITS	THIRD ANGLE PROJECTION
	mm	INCH	MM/IN	MM/IN			
∇=0	4 PLACES	±.010	---	---	---	INCH	☉
∇=0	3 PLACES	±.010	---	---			
∇=0	2 PLACES	±0.25	±.014	---			
∇=0	1 PLACE	±0.36	---	---	---	---	---
		ANGULAR	±1/2°	---	---	---	---

REMOVE PINS	QUALITY SYMBOLS	GENERAL TOLERANCES (UNLESS SPECIFIED)	DIMENSION STYLE	SCALE	DESIGN UNITS	THIRD ANGLE PROJECTION
EC NO. LCP202-821	∇=0	4 PLACES ±.010	MM/IN	---	INCH	☉
EC NO. LCP202-821	∇=0	3 PLACES ±.010	MM/IN	---	INCH	☉
EC NO. LCP202-821	∇=0	2 PLACES ±0.25 ±.014	MM/IN	---	INCH	☉
EC NO. LCP202-821	∇=0	1 PLACE ±0.36	MM/IN	---	INCH	☉
EC NO. LCP202-821		ANGULAR ±1/2°	MM/IN	---	INCH	☉

REVISIONS	DATE	BY	DESCRIPTION
1	2017/01/04	JJS	ISSUE FOR PRODUCTION
2	2017/01/04	PATEL	APPROVED FOR PRODUCTION

DRAWN BY	DATE	TITLE
JJS	12/03/87	TRIFURCON TERMINAL
CHECKED BY	DATE	CRIMP TYPE .156 CENTERS
PATEL	12/03/87	22 TO 26 AWG
APPROVED BY	DATE	
LENZ	12/03/87	

MATERIAL NO.	DOCUMENT NO.	SHEET NO.
SEE CHART	SD-7258	1 OF 2

DRAFT WHERE APPLICABLE MUST REMAIN WITHIN DIMENSIONS

THIS DRAWING CONTAINS INFORMATION THAT IS PROPRIETARY TO MOLEX INCORPORATED AND SHOULD NOT BE USED WITHOUT WRITTEN PERMISSION

