

Excellent Integrated System Limited

Stocking Distributor

Click to view price, real time Inventory, Delivery & Lifecycle Information:

[Molex Connector Corporation](#)
[0015913660](#)

For any questions, you can email us directly:

sales@integrated-circuit.com

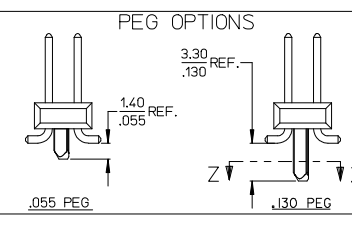
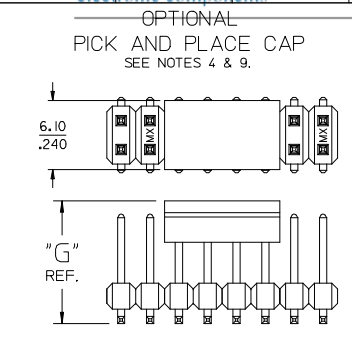

- NOTES:**
- MATERIALS: INSULATOR: GLASS FILLED LIQUID CRYSTAL POLYMER (LCP), UL94 V-0, COLOR: BLACK
TERMINAL: COPPER ALLOY
 - FINISH:
59 TIN - 0.00150/0.00059 MIN. BRIGHT TIN OVER NICKEL OVERALL.
150 TIN - 0.00381/0.00150 MIN. BRIGHT TIN OVER NICKEL OVERALL.
REFLOWED MATTE TIN - 0.00152/0.00060 MIN. REFLOWED MATTE TIN OVER NICKEL OVERALL.
15 GOLD - 0.00038/0.00015 MIN. GOLD IN SELECT AREA OVER 0.00191/0.00075 MIN. TIN IN SELECT AREA OVER NICKEL OVERALL.
30 GOLD - 0.00076/0.00030 MIN. GOLD IN SELECT AREA OVER 0.00191/0.00075 MIN. TIN IN SELECT AREA OVER NICKEL OVERALL.
50 GOLD - 0.00127/0.00050 MIN. GOLD IN SELECT AREA OVER 0.00254/0.00100 MIN. TIN IN SELECT AREA OVER NICKEL OVERALL.
 - PART TO CONFORM TO PS-71308.
 - PACKAGING (SEE CHARTS): BULK: PER PK-70873-0353
TUBES: PER PK-70873-0041.
71308-82** IN TUBES: PER PK-70873-042.
TUBES W/ VAC CAPS: PER PK-70873-0691
TAPE AND REEL W/ VAC CAPS: PER PK-70873-0805.
SEE SHEET 3 FOR TAPE & REEL PRODUCT WITH SHALLOW POCKET REQUIREMENTS.
 - TYP. DIMENSIONS FOR LANDS SURROUNDING HOLES FOR RETENTION PEGS.
 - PIN SOLERABILITY PER MOLEX SPEC. SMES-152.
 - SEE SHEETS 2-6 FOR CHARTED DIMS., PART/EDP NO'S, AND VOIDED CIRCUITS.
 - PIN PUSHOUT FORCE: 3 LBS. MINIMUM.
 - PICK-N-PLACE CAPS WILL BE PLACED SO THAT VACUUM PICK UP AREA WILL BE IN CENTER OF PART.
 - COPLANARITY FOR CIRCUIT SIZES UP TO 40 IS 0.15 MM/0.06 INCH. FOR CIRCUIT SIZES 42 AND LARGER, CONTACT MOLEX SALES DEPARTMENT.
 - THIS PART CONFORMS TO CLASS B REQUIREMENTS OF COSMETIC SPECIFICATION PS-45499-002.
 - MEASURE POINT FOR PLATING THICKNESS.

| DIM. "M" | DIM. "G" |
|--------------|---------------|
| 6.10 .240 | 10.67 .420 |
| 8.13 .320 | 12.70 .500 |

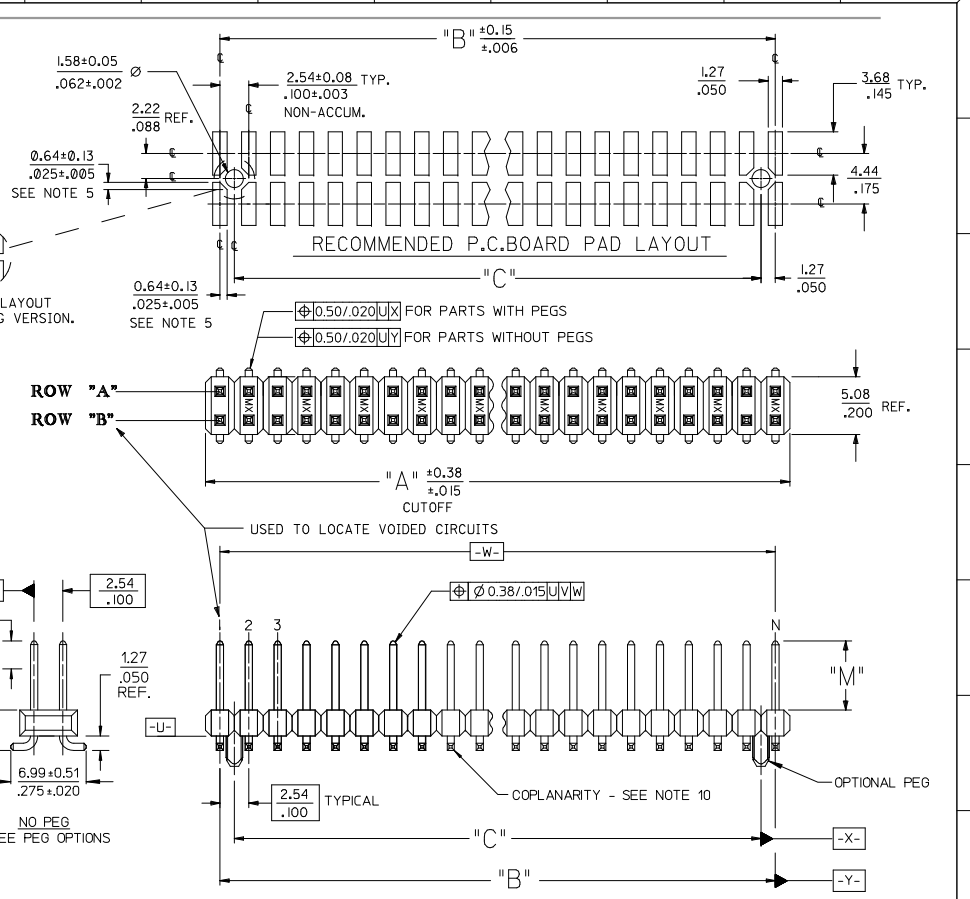
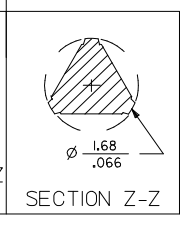
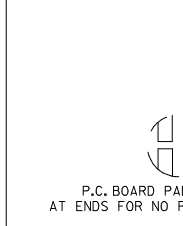

| REV | DESCRIPTION |
|-----|-------------------------|
| 1 | 71308-8426 PLATING |
| 2 | EC NO: UCP2014-4901 |
| 3 | DRW/KJPPER 2/15/08/12 |
| 4 | CHK/KONGUTEN 2/15/08/12 |
| 5 | APPROV/STH 2/15/09/10 |

| QUALITY SYMBOLS | GENERAL TOLERANCES (UNLESS SPECIFIED) |
|---------------------------|---------------------------------------|
| $\nabla \rightarrow 0$ | 4 PLACES \pm --- \pm --- |
| $\nabla \rightarrow 0.05$ | 3 PLACES \pm --- \pm .005 |
| $\nabla \rightarrow 0.13$ | 2 PLACES \pm 0.13 \pm .010 |
| $\nabla \rightarrow 0.25$ | 1 PLACE \pm 0.25 \pm --- |
| $\nabla \rightarrow 0$ | 0 PLACE \pm --- \pm --- |
| | ANGULAR $\pm 1/2^\circ$ |

| GENERAL TOLERANCES (UNLESS SPECIFIED) | DIMENSION STYLE | SCALE | DESIGN UNITS | THIRD ANGLE PROJECTION |
|---------------------------------------|-----------------|-------|--------------|------------------------|
| mm | MM/IN | | INCH | |
| INCH | | | | |

| DRAWN BY | DATE | TITLE | DOCUMENT NO. | SHEET NO. |
|-------------|------------|---|--------------|-----------|
| KMS | 1999/10/15 | SALES ASSY INSULATOR DUAL ROW SMT W/BREAK-OFF .025SQ PIN GULLWING .100 | SD-71308-001 | 1 OF 6 |
| CHECKED BY | DATE | molex | | |
| KMS | 1999/10/15 | | | |
| APPROVED BY | DATE | THIS DRAWING CONTAINS INFORMATION THAT IS PROPRIETARY TO MOLEX INCORPORATED AND SHOULD NOT BE USED WITHOUT WRITTEN PERMISSION | | |
| KMS | 1999/10/15 | | | |

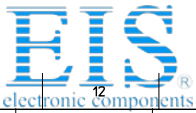

Distributor of Molex Connector Corporation: Excellent Integrated System Limited

Datasheet of 0015913660 - CONN BKWY HEADER 66POS GOLD SMD

Contact us: sales@integrated-circuit.com Website: www.integrated-circuit.com

Main table with columns for DIM. A, DIM. B, EDP NUMBER, and various connector specifications. Includes rows for DIM. M, PLATING, and DIM. H.

Technical drawing area containing: NO PEG VERSION (SEE ALSO SHEET 3), QUALITY SYMBOLS, GENERAL TOLERANCES (UNLESS SPECIFIED), DIMENSION STYLE MM/IN, SCALE, DESIGN UNITS INCH, THIRD ANGLE PROJECTION, SALES ASSY INSULATOR DUAL ROW SMT W/BREAK-OFF .025SQ PIN GULL WING .100, molex logo, MATERIAL NO., DOCUMENT NO., SHEET NO., DRAFT WHERE APPLICABLE MUST REMAIN WITHIN DIMENSIONS, SEE TABLE, SD-71308-001, 2 OF 6. Includes drawing ID: SEE SHEET 1, EC NO: UC2014-4901, CHKD BY: P. KIPPER, DATE: 2015/08/12, APPR: M. NGUYEN, DATE: 2015/09/10.



| | | | | | IN TAPE AND REEL WITH SHALLOW POCKET TAPE | | | | | BULK / IN TUBES | | | | |
|--------------------------------|--------|-------|--------|-------|---|----------------------------|----------------------------|--|--|-----------------|---------------|---------------|-------|--|
| PACKAGING SEE NOTE 4. SHT 1 | | | | | 4-8 CKT | TAPE-N-REEL W/ VAC CAPS | TAPE-N-REEL W/ VAC CAPS | | | | | BULK | BULK | |
| | | | | | 10-100 CKT | TAPE-N-REEL W/ VAC CAPS | TAPE-N-REEL W/ VAC CAPS | | | | | TUBES | TUBES | |
| DIM. M±0.25 MM | | | | | | 6.10 (.240) | 6.10 (.240) | | | | 8.13 (.320) | 13.59 (.535) | | |
| PLATING | | | | | | 30 GOLD | 15 GOLD | | | | 150 TIN | 150 TIN | | |
| DIM. H | | | | | | 2.54 (.100) | 2.54 (.100) | | | | 4.57 (.180) | 4.57 (.180) | | |
| CKTS | DIM. A | | DIM. B | | EDP NUMBER | EDP NUMBER | | | | | EDP NUMBER | EDP NUMBER | CKTS | |
| | MM | IN | MM | IN | | | | | | | | | | |
| 04 | 5.08 | .200 | 2.54 | .100 | | | | | | | | | 04 | |
| 06 | 7.62 | .300 | 5.08 | .200 | | 015-91-6068 | | | | | | | 06 | |
| 08 | 10.16 | .400 | 7.62 | .300 | | 015-91-6088 | | | | | | | 08 | |
| 10 | 12.70 | .500 | 10.16 | .400 | | 015-91-6108 | | | | 713088010 | 71308-8210 | | 10 | |
| 12 | 15.24 | .600 | 12.70 | .500 | | | | | | | | | 12 | |
| 14 | 17.78 | .700 | 15.24 | .600 | 015-91-6148 | | | | | | | | 14 | |
| 16 | 20.32 | .800 | 17.78 | .700 | | | | | | 713088016 | | | 16 | |
| 18 | 22.86 | .900 | 20.32 | .800 | | | | | | | | | 18 | |
| 20 | 25.40 | 1.000 | 22.86 | .900 | | | | | | | | | 20 | |
| 22 | 27.94 | 1.100 | 25.40 | 1.000 | | | | | | | | | 22 | |
| 24 | 30.48 | 1.200 | 27.94 | 1.100 | | | | | | | | | 24 | |
| 26 | 33.02 | 1.300 | 30.48 | 1.200 | | | | | | | | | 26 | |
| 28 | 35.56 | 1.400 | 33.02 | 1.300 | | | | | | | | | 28 | |
| 30 | 38.10 | 1.500 | 35.56 | 1.400 | | | | | | | | | 30 | |
| 32 | 40.64 | 1.600 | 38.10 | 1.500 | | | | | | | | | 32 | |
| 34 | 43.18 | 1.700 | 40.64 | 1.600 | | | | | | | | | 34 | |
| 36 | 45.72 | 1.800 | 43.18 | 1.700 | | | | | | | | | 36 | |
| 38 | 48.26 | 1.900 | 45.72 | 1.800 | | | | | | | | | 38 | |
| 40 | 50.80 | 2.000 | 48.26 | 1.900 | | | | | | | | | 40 | |
| 42 | 53.34 | 2.100 | 50.80 | 2.000 | | | | | | | | | 42 | |
| 44 | 55.88 | 2.200 | 53.34 | 2.100 | | | | | | | | | 44 | |
| 46 | 58.42 | 2.300 | 55.88 | 2.200 | | | | | | | | | 46 | |
| 48 | 60.96 | 2.400 | 58.42 | 2.300 | | | | | | | | | 48 | |
| 50 | 63.50 | 2.500 | 60.96 | 2.400 | | | | | | | | | 50 | |
| 52 | 66.04 | 2.600 | 63.50 | 2.500 | | | | | | | | | 52 | |
| 54 | 68.58 | 2.700 | 66.04 | 2.600 | | | | | | | | | 54 | |
| 56 | 71.12 | 2.800 | 68.58 | 2.700 | | | | | | | | | 56 | |
| 58 | 73.66 | 2.900 | 71.12 | 2.800 | | | | | | | | | 58 | |
| 60 | 76.20 | 3.000 | 73.66 | 2.900 | | | | | | | | | 60 | |
| 62 | 78.74 | 3.100 | 76.20 | 3.000 | | | | | | | | | 62 | |
| 64 | 81.28 | 3.200 | 78.74 | 3.100 | | | | | | | | | 64 | |
| 66 | 83.82 | 3.300 | 81.28 | 3.200 | | | | | | | | | 66 | |
| 68 | 86.36 | 3.400 | 83.82 | 3.300 | | | | | | | | | 68 | |
| 70 | 88.90 | 3.500 | 86.36 | 3.400 | | | | | | | | | 70 | |
| 72 | 91.44 | 3.600 | 88.90 | 3.500 | | | | | | | | | 72 | |
| 74 | 93.98 | 3.700 | 91.44 | 3.600 | | | | | | | | | 74 | |
| 76 | 96.52 | 3.800 | 93.98 | 3.700 | | | | | | | | | 76 | |
| 78 | 99.06 | 3.900 | 96.52 | 3.800 | | | | | | | | | 78 | |
| 80 | 101.60 | 4.000 | 99.06 | 3.900 | | | | | | | | | 80 | |
| 82 | 104.14 | 4.100 | 101.60 | 4.000 | | | | | | | | | 82 | |
| 84 | 106.68 | 4.200 | 104.14 | 4.100 | | | | | | | | | 84 | |
| 86 | 109.22 | 4.300 | 106.68 | 4.200 | | | | | | | | | 86 | |
| 88 | 111.76 | 4.400 | 109.22 | 4.300 | | | | | | | | | 88 | |
| 90 | 114.30 | 4.500 | 111.76 | 4.400 | | | | | | | | | 90 | |
| 92 | 116.84 | 4.600 | 114.30 | 4.500 | | | | | | | | | 92 | |
| 94 | 119.38 | 4.700 | 116.84 | 4.600 | | | | | | | | | 94 | |
| 96 | 121.92 | 4.800 | 119.38 | 4.700 | | | | | | | | | 96 | |
| 98 | 124.46 | 4.900 | 121.92 | 4.800 | | | | | | | | | 98 | |
| 100 | 127.00 | 5.000 | 124.46 | 4.900 | | | | | | | | | 100 | |

NO PEG VERSION
(ALSO SEE SHEET 2)

| | | | | | | | | | |
|--|--------------------------------------|---------------------------------------|------------|---|------------|--|--------------|------------------------|--|
| SEE SHEET 1 EC NO: UCP2014-4901 DRAWN BY: 2015/08/12 CHKD: 2015/08/12 APPROV: 2015/09/10 | QUALITY SYMBOLS ∇=0 ∇=0 ∇=0 | GENERAL TOLERANCES (UNLESS SPECIFIED) | | DIMENSION STYLE | | SCALE | DESIGN UNITS | THIRD ANGLE PROJECTION | |
| | | mm | INCH | MM/IN | | | | | |
| | | 4 PLACES ± --- ± --- | | DRAWN BY | DATE | TITLE | | | |
| | | 3 PLACES ± --- ± .005 | | KMS | 1999/10/15 | SALES ASSY INSULATOR DUAL ROW SMT W/BREAK-OFF .025SQ PIN GULLWING .100 | | | |
| 2 PLACES ± 0.13 ± .010 | | CHECKED BY | DATE | molex MATERIAL NO. SD-71308-001 DOCUMENT NO. SHEET NO. 3 OF 6 | | | | | |
| 1 PLACE ± 0.25 ± --- | | APPROVED BY | DATE | | | | | | |
| 0 PLACE ± --- ± --- | | KMS | 1999/10/15 | DRAFT WHERE APPLICABLE MUST REMAIN WITHIN DIMENSIONS | | | | | |
| ANGULAR ±1/2° | | SEE TABLE | | THIS DRAWING CONTAINS INFORMATION THAT IS PROPRIETARY TO MOLEX INCORPORATED AND SHOULD NOT BE USED WITHOUT WRITTEN PERMISSION | | | | | |

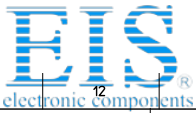

Distributor of Molex Connector Corporation: Excellent Integrated System Limited

Datasheet of 0015913660 - CONN BKWY HEADER 66POS GOLD SMD

Contact us: sales@integrated-circuit.com Website: www.integrated-circuit.com

| PKG | DIM. M ±0.25 MM | PLATING | DIM. H | 4-8 CKT | | BULK | | TAPE-N-REEL W/ VAC CAPS | | BULK | | TAPE-N-REEL W/ VAC CAPS | | BULK | | TAPE-N-REEL W/ VAC CAPS | | BULK | | BULK | | BULK | |
|-----|-----------------|---------|--------|-------------|-------|-------------------------|-------|-------------------------|-------|-------------------------|-------------|-------------------------|-------|-------------------------|-------|-------------------------|-------|-------|-------|-------|-------|-------|-------|
| | | | | 10-100 CKT | TUBES | TAPE-N-REEL W/ VAC CAPS | TUBES | TAPE-N-REEL W/ VAC CAPS | TUBES | TAPE-N-REEL W/ VAC CAPS | TUBES | TAPE-N-REEL W/ VAC CAPS | TUBES | TAPE-N-REEL W/ VAC CAPS | TUBES | TUBES | TUBES | TUBES | TUBES | TUBES | TUBES | TUBES | TUBES |
| | | | | 6.10 (.240) | | 6.10 (.240) | | 6.10 (.240) | | 8.13 (.320) | 8.13 (.320) | 8.13 (.320) | | | | | | | | | | | |
| | | | | 150 TIN | | 15 GOLD | | 15 GOLD | | 30 GOLD | 30 GOLD | 30 GOLD | | | | | | | | | | | |
| | | | | 2.54 (.100) | | 2.54 (.100) | | 2.54 (.100) | | 4.57 (.180) | 4.57 (.180) | 4.57 (.180) | | | | | | | | | | | |

| CKTS | DIM. A | | DIM. B | | DIM. C | | EDP NUMBER | EDP NUMBER | EDP NUMBER | EDP NUMBER | EDP NUMBER | EDP NUMBER | EDP NUMBER | EDP NUMBER | EDP NUMBER | EDP NUMBER | EDP NUMBER | EDP NUMBER | EDP NUMBER | EDP NUMBER | EDP NUMBER | EDP NUMBER | CKTS |
|------|--------|-------|--------|-------|--------|-------|-------------|-------------|-------------|-------------|-------------|-------------|-------------|-------------|-------------|------------|------------|------------|------------|------------|------------|------------|------|
| | MM | IN | MM | IN | MM | IN | | | | | | | | | | | | | | | | | |
| 04 | 5.08 | .200 | 2.54 | .100 | --- | --- | 015-91-1041 | 015-91-6044 | 015-91-1042 | 015-91-6045 | 015-91-1043 | 015-91-6046 | 015-91-1044 | 015-91-0047 | 015-91-1040 | | | | | | | | 04 |
| 06 | 7.62 | .300 | 5.08 | .200 | 2.54 | .100 | 015-91-1061 | 015-91-6064 | 015-91-1062 | 015-91-6065 | 015-91-1063 | 015-91-6066 | 015-91-1064 | 015-91-0067 | 015-91-1060 | | | | | | | | 06 |
| 08 | 10.16 | .400 | 7.62 | .300 | 5.08 | .200 | 015-91-1081 | 015-91-6084 | 015-91-1082 | 015-91-6085 | 015-91-1083 | 015-91-6086 | 015-91-1084 | 015-91-0087 | 015-91-1080 | | | | | | | | 08 |
| 10 | 12.70 | .500 | 10.16 | .400 | 7.62 | .300 | 015-91-1101 | 015-91-6104 | 015-91-1102 | 015-91-6105 | 015-91-1103 | 015-91-6106 | 015-91-1104 | 015-91-0107 | 015-91-1100 | | | | | | | | 10 |
| 12 | 15.24 | .600 | 12.70 | .500 | 10.16 | .400 | 015-91-1121 | | 015-91-1122 | | 015-91-1123 | | 015-91-1124 | 015-91-0127 | 015-91-1120 | | | | | | | | 12 |
| 14 | 17.78 | .700 | 15.24 | .600 | 12.70 | .500 | 015-91-1141 | 015-91-6144 | 015-91-1142 | 015-91-6145 | 015-91-1143 | 015-91-6146 | 015-91-1144 | 015-91-0147 | 015-91-1140 | | | | | | | | 14 |
| 16 | 20.32 | .800 | 17.78 | .700 | 15.24 | .600 | 015-91-1161 | 015-91-6164 | 015-91-1162 | 015-91-6165 | 015-91-1163 | 015-91-6166 | 015-91-1164 | 015-91-0167 | 015-91-1160 | | | | | | | | 16 |
| 18 | 22.86 | .900 | 20.32 | .800 | 17.78 | .700 | 015-91-1181 | | 015-91-1182 | | 015-91-1183 | | 015-91-1184 | 015-91-0187 | 015-91-1180 | | | | | | | | 18 |
| 20 | 25.40 | 1.000 | 22.86 | .900 | 20.32 | .800 | 015-91-1201 | | 015-91-1202 | | 015-91-1203 | | 015-91-1204 | 015-91-0207 | 015-91-1200 | | | | | | | | 20 |
| 22 | 27.94 | 1.100 | 25.40 | 1.000 | 22.86 | .900 | 015-91-1221 | | 015-91-1222 | | 015-91-1223 | | 015-91-1224 | 015-91-0227 | 015-91-1220 | | | | | | | | 22 |
| 24 | 30.48 | 1.200 | 27.94 | 1.100 | 25.40 | 1.000 | 015-91-1241 | 71308-6901 | 015-91-1242 | | 015-91-1243 | | 015-91-1244 | 015-91-0247 | 015-91-1240 | | | | | | | | 24 |
| 26 | 33.02 | 1.300 | 30.48 | 1.200 | 27.94 | 1.100 | 015-91-1261 | | 015-91-1262 | | 015-91-1263 | | 015-91-1264 | 015-91-0267 | 015-91-1260 | | | | | | | | 26 |
| 28 | 35.56 | 1.400 | 33.02 | 1.300 | 30.48 | 1.200 | 015-91-1281 | | 015-91-1282 | | 015-91-1283 | | 015-91-1284 | 015-91-0287 | 015-91-1280 | | | | | | | | 28 |
| 30 | 38.10 | 1.500 | 35.56 | 1.400 | 33.02 | 1.300 | 015-91-1301 | | 015-91-1302 | | 015-91-1303 | | 015-91-1304 | 015-91-0307 | 015-91-1300 | | | | | | | | 30 |
| 32 | 40.64 | 1.600 | 38.10 | 1.500 | 35.56 | 1.400 | 015-91-1321 | | 015-91-1322 | | 015-91-1323 | | 015-91-1324 | 015-91-0327 | 015-91-1320 | | | | | | | | 32 |
| 34 | 43.18 | 1.700 | 40.64 | 1.600 | 38.10 | 1.500 | 015-91-1341 | | 015-91-1342 | | 015-91-1343 | | 015-91-1344 | 015-91-0347 | 015-91-1340 | | | | | | | | 34 |
| 36 | 45.72 | 1.800 | 43.18 | 1.700 | 40.64 | 1.600 | 015-91-1361 | | 015-91-1362 | | 015-91-1363 | | 015-91-1364 | 015-91-0367 | 015-91-1360 | | | | | | | | 36 |
| 38 | 48.26 | 1.900 | 45.72 | 1.800 | 43.18 | 1.700 | 015-91-1381 | | 015-91-1382 | | 015-91-1383 | | 015-91-1384 | 015-91-0387 | 015-91-1380 | | | | | | | | 38 |
| 40 | 50.80 | 2.000 | 48.26 | 1.900 | 45.72 | 1.800 | 015-91-1401 | | 015-91-1402 | | 015-91-1403 | | 015-91-1404 | 015-91-0407 | 015-91-1400 | | | | | | | | 40 |
| 42 | 53.34 | 2.100 | 50.80 | 2.000 | 48.26 | 1.900 | 015-91-1421 | | 015-91-1422 | | 015-91-1423 | | 015-91-1424 | 015-91-0427 | 015-91-1420 | | | | | | | | 42 |
| 44 | 55.88 | 2.200 | 53.34 | 2.100 | 50.80 | 2.000 | 015-91-1441 | | 015-91-1442 | | 015-91-1443 | | 015-91-1444 | 015-91-0447 | 015-91-1440 | | | | | | | | 44 |
| 46 | 58.42 | 2.300 | 55.88 | 2.200 | 53.34 | 2.100 | 015-91-1461 | | 015-91-1462 | | 015-91-1463 | | 015-91-1464 | 015-91-0467 | 015-91-1460 | | | | | | | | 46 |
| 48 | 60.96 | 2.400 | 58.42 | 2.300 | 55.88 | 2.200 | 015-91-1481 | | 015-91-1482 | | 015-91-1483 | | 015-91-1484 | 015-91-0487 | 015-91-1480 | | | | | | | | 48 |
| 50 | 63.50 | 2.500 | 60.96 | 2.400 | 58.42 | 2.300 | 015-91-1501 | 015-91-6504 | 015-91-1502 | 015-91-6505 | 015-91-1503 | 015-91-6506 | 015-91-1504 | 015-91-0507 | 015-91-1500 | | | | | | | | 50 |
| 52 | 66.04 | 2.600 | 63.50 | 2.500 | 60.96 | 2.400 | 015-91-1521 | | 015-91-1522 | | 015-91-1523 | 71308-5203 | 015-91-1524 | 015-91-0527 | 015-91-1520 | | | | | | | | 52 |
| 54 | 68.58 | 2.700 | 66.04 | 2.600 | 63.50 | 2.500 | 015-91-1541 | | 015-91-1542 | | 015-91-1543 | | 015-91-1544 | 015-91-0547 | 015-91-1540 | | | | | | | | 54 |
| 56 | 71.12 | 2.800 | 68.58 | 2.700 | 66.04 | 2.600 | 015-91-1561 | | 015-91-1562 | | 015-91-1563 | | 015-91-1564 | 015-91-0567 | 015-91-1560 | | | | | | | | 56 |
| 58 | 73.66 | 2.900 | 71.12 | 2.800 | 68.58 | 2.700 | 015-91-1581 | | 015-91-1582 | | 015-91-1583 | | 015-91-1584 | 015-91-0587 | 015-91-1580 | | | | | | | | 58 |
| 60 | 76.20 | 3.000 | 73.66 | 2.900 | 71.12 | 2.800 | 015-91-1601 | | 015-91-1602 | | 015-91-1603 | | 015-91-1604 | 015-91-0607 | 015-91-1600 | | | | | | | | 60 |
| 62 | 78.74 | 3.100 | 76.20 | 3.000 | 73.66 | 2.900 | 015-91-1621 | | 015-91-1622 | | 015-91-1623 | | 015-91-1624 | 015-91-0627 | 015-91-1620 | | | | | | | | 62 |
| 64 | 81.28 | 3.200 | 78.74 | 3.100 | 76.20 | 3.000 | 015-91-1641 | | 015-91-1642 | | 015-91-1643 | | 015-91-1644 | 015-91-0647 | 015-91-1640 | | | | | | | | 64 |
| 66 | 83.82 | 3.300 | 81.28 | 3.200 | 78.74 | 3.100 | 015-91-1661 | | 015-91-1662 | | 015-91-1663 | | 015-91-1664 | 015-91-0667 | 015-91-1660 | | | | | | | | 66 |
| 68 | 86.36 | 3.400 | 83.82 | 3.300 | 81.28 | 3.200 | 015-91-1681 | | 015-91-1682 | | 015-91-1683 | | 015-91-1684 | 015-91-0687 | 015-91-1680 | | | | | | | | 68 |
| 70 | 88.90 | 3.500 | 86.36 | 3.400 | 83.82 | 3.300 | 015-91-1701 | | 015-91-1702 | | 015-91-1703 | | 015-91-1704 | 015-91-0707 | 015-91-1700 | | | | | | | | 70 |
| 72 | 91.44 | 3.600 | 88.90 | 3.500 | 86.36 | 3.400 | 015-91-1721 | | 015-91-1722 | | 015-91-1723 | | 015-91-1724 | 015-91-0727 | 015-91-1720 | | | | | | | | 72 |
| 74 | 93.98 | 3.700 | 91.44 | 3.600 | 88.90 | 3.500 | 015-91-1741 | | 015-91-1742 | | 015-91-1743 | | 015-91-1744 | 015-91-0747 | 015-91-1740 | | | | | | | | 74 |
| 76 | 96.52 | 3.800 | 93.98 | 3.700 | 91.44 | 3.600 | 015-91-1761 | | 015-91-1762 | | 015-91-1763 | | 015-91-1764 | 015-91-0767 | 015-91-1760 | | | | | | | | 76 |
| 78 | 99.06 | 3.900 | 96.52 | 3.800 | 93.98 | 3.700 | 015-91-1781 | | 015-91-1782 | | 015-91-1783 | | 015-91-1784 | 015-91-0787 | 015-91-1780 | | | | | | | | 78 |
| 80 | 101.60 | 4.000 | 99.06 | 3.900 | 96.52 | 3.800 | 015-91-1801 | | 015-91-1802 | | 015-91-1803 | | 015-91-1804 | 015-91-0807 | 015-91-1800 | | | | | | | | 80 |
| 82 | 104.14 | 4.100 | 101.60 | 4.000 | 99.06 | 3.900 | 71308-4082 | | 71308-4182 | | 71308-4282 | | 71308-5082 | 71308-5182 | 71308-5282 | | | | | | | | 82 |
| 84 | 106.68 | 4.200 | 104.14 | 4.100 | 101.60 | 4.000 | 71308-4084 | | 71308-4184 | | 71308-4284 | | 71308-5084 | 71308-5184 | 71308-5284 | | | | | | | | 84 |
| 86 | 109.22 | 4.300 | 106.68 | 4.200 | 104.14 | 4.100 | 71308-4086 | | 71308-4186 | | 71308-4286 | | 71308-5086 | 71308-5186 | 71308-5286 | | | | | | | | 86 |
| 88 | 111.76 | 4.400 | 109.22 | 4.300 | 106.68 | 4.200 | 71308-4088 | | 71308-4188 | | 71308-4288 | | 71308-5088 | 71308-5188 | 71308-5288 | | | | | | | | 88 |
| 90 | 114.30 | 4.500 | 111.76 | 4.400 | 109.22 | 4.300 | 71308-4090 | | 71308-4190 | | 71308-4290 | | 71308-5090 | 71308-5190 | 71308-5290 | | | | | | | | 90 |
| 92 | 116.84 | 4.600 | 114.30 | 4.500 | 111.76 | 4.400 | 71308-4092 | | 71308-4192 | | 71308-4292 | | 71308-5092 | 71308-5192 | 71308-5292 | | | | | | | | 92 |
| 94 | 119.38 | 4.700 | 116.84 | 4.600 | 114.30 | 4.500 | 71308-4094 | | 71308-4194 | | 71308-4294 | | 71308-5094 | 71308-5194 | 71308-5294 | | | | | | | | 94 |
| 96 | 121.92 | 4.800 | 119.38 | 4.700 | 116.84 | 4.600 | 71308-4096 | | 71308-4196 | | 71308-4296 | | 71308-5096 | 71308-5196 | 71308-5296 | | | | | | | | 96 |
| 98 | 124.46 | 4.900 | 121.92 | 4.800 | 119.38 | 4.700 | 71308-4098 | | 71308-4198 | | 71308-4298 | | 71308-5098 | 71308-5198 | 71308-5298 | | | | | | | | 98 |
| 100 | 127.00 | 5.000 | 124.46 | 4.900 | 121.92 | 4.800 | 71308-4100 | | 71308-4200 | | 71308-4300 | | 71308-5100 | 71308-5200 | 71308-5300 | | | | | | | | 100 |

LONG PEG VERSION (.130")

| |
|---|
| SEE SHEET 1 EC NO: UC22014-4901 DRAWN BY: CHKDMQWJEN APPRO |
|---|

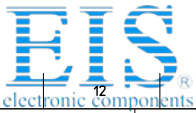

Distributor of Molex Connector Corporation: Excellent Integrated System Limited

Datasheet of 0015913660 - CONN BKWY HEADER 66POS GOLD SMD

Contact us: sales@integrated-circuit.com Website: www.integrated-circuit.com

| CKTS | DIM. A | | DIM. B | | DIM. C | | EDP NUMBER | EDP NUMBER | EDP NUMBER | EDP NUMBER | EDP NUMBER | EDP NUMBER | EDP NUMBER | EDP NUMBER | CKTS |
|------|--------|-------|--------|-------|--------|-------|-------------|-------------|------------|------------|------------|------------|------------|------------|------|
| | MM | IN | MM | IN | MM | IN | | | | | | | | | |
| 04 | 5.08 | .200 | 2.54 | .100 | ----- | ----- | 015-91-1048 | 015-91-6047 | | | | | | | 04 |
| 06 | 7.62 | .300 | 5.08 | .200 | 2.54 | .100 | 015-91-1068 | 015-91-6067 | 71308-6106 | 71308-6206 | | | | | 06 |
| 08 | 10.16 | .400 | 7.62 | .300 | 5.08 | .200 | 015-91-1088 | 015-91-6087 | 71308-6108 | 71308-6208 | | | | | 08 |
| 10 | 12.70 | .500 | 10.16 | .400 | 7.62 | .300 | 015-91-1108 | 015-91-6107 | 71308-6110 | 71308-6210 | | | | | 10 |
| 12 | 15.24 | .600 | 12.70 | .500 | 10.16 | .400 | 015-91-1128 | | | | | | | | 12 |
| 14 | 17.78 | .700 | 15.24 | .600 | 12.70 | .500 | 015-91-1148 | 015-91-6147 | | | | | | | 14 |
| 16 | 20.32 | .800 | 17.78 | .700 | 15.24 | .600 | 015-91-1168 | 015-91-6167 | | | | | | | 16 |
| 18 | 22.86 | .900 | 20.32 | .800 | 17.78 | .700 | 015-91-1188 | | | | | | | | 18 |
| 20 | 25.40 | 1.000 | 22.86 | .900 | 20.32 | .800 | 015-91-1208 | 015-91-6207 | | | | | | | 20 |
| 22 | 27.94 | 1.100 | 25.40 | 1.000 | 22.86 | .900 | 015-91-1228 | | | | | | | | 22 |
| 24 | 30.48 | 1.200 | 27.94 | 1.100 | 25.40 | 1.000 | 015-91-1248 | | | | | | | | 24 |
| 26 | 33.02 | 1.300 | 30.48 | 1.200 | 27.94 | 1.100 | 015-91-1268 | | 71308-6126 | | 71308-8426 | | | | 26 |
| 28 | 35.56 | 1.400 | 33.02 | 1.300 | 30.48 | 1.200 | 015-91-1288 | | | | | | | | 28 |
| 30 | 38.10 | 1.500 | 35.56 | 1.400 | 33.02 | 1.300 | 015-91-1308 | | | | | | | | 30 |
| 32 | 40.64 | 1.600 | 38.10 | 1.500 | 35.56 | 1.400 | 015-91-1328 | | | | | | | | 32 |
| 34 | 43.18 | 1.700 | 40.64 | 1.600 | 38.10 | 1.500 | 015-91-1348 | | | | | | | | 34 |
| 36 | 45.72 | 1.800 | 43.18 | 1.700 | 40.64 | 1.600 | 015-91-1368 | | | | | | | | 36 |
| 38 | 48.26 | 1.900 | 45.72 | 1.800 | 43.18 | 1.700 | 015-91-1388 | | | | | | | | 38 |
| 40 | 50.80 | 2.000 | 48.26 | 1.900 | 45.72 | 1.800 | 015-91-1408 | | | | | | | | 40 |
| 42 | 53.34 | 2.100 | 50.80 | 2.000 | 48.26 | 1.900 | 015-91-1428 | | | | | | | | 42 |
| 44 | 55.88 | 2.200 | 53.34 | 2.100 | 50.80 | 2.000 | 015-91-1448 | | | | | | | | 44 |
| 46 | 58.42 | 2.300 | 55.88 | 2.200 | 53.34 | 2.100 | 015-91-1468 | | | | | | | | 46 |
| 48 | 60.96 | 2.400 | 58.42 | 2.300 | 55.88 | 2.200 | 015-91-1488 | | | | | | | | 48 |
| 50 | 63.50 | 2.500 | 60.96 | 2.400 | 58.42 | 2.300 | 015-91-1508 | 015-91-6507 | | | | | | | 50 |
| 52 | 66.04 | 2.600 | 63.50 | 2.500 | 60.96 | 2.400 | 015-91-1528 | | | | | | | | 52 |
| 54 | 68.58 | 2.700 | 66.04 | 2.600 | 63.50 | 2.500 | 015-91-1548 | | | | | | | | 54 |
| 56 | 71.12 | 2.800 | 68.58 | 2.700 | 66.04 | 2.600 | 015-91-1568 | | | | | | | | 56 |
| 58 | 73.66 | 2.900 | 71.12 | 2.800 | 68.58 | 2.700 | 015-91-1588 | | | | | | | | 58 |
| 60 | 76.20 | 3.000 | 73.66 | 2.900 | 71.12 | 2.800 | 015-91-1608 | | | | | | | | 60 |
| 62 | 78.74 | 3.100 | 76.20 | 3.000 | 73.66 | 2.900 | 015-91-1628 | | | | | | | | 62 |
| 64 | 81.28 | 3.200 | 78.74 | 3.100 | 76.20 | 3.000 | 015-91-1648 | | | | | | | | 64 |
| 66 | 83.82 | 3.300 | 81.28 | 3.200 | 78.74 | 3.100 | 015-91-1668 | | | | | | | | 66 |
| 68 | 86.36 | 3.400 | 83.82 | 3.300 | 81.28 | 3.200 | 015-91-1688 | | | | | | | | 68 |
| 70 | 88.90 | 3.500 | 86.36 | 3.400 | 83.82 | 3.300 | 015-91-1708 | | | | | | | | 70 |
| 72 | 91.44 | 3.600 | 88.90 | 3.500 | 86.36 | 3.400 | 015-91-1728 | | | | | | | | 72 |
| 74 | 93.98 | 3.700 | 91.44 | 3.600 | 88.90 | 3.500 | 015-91-1748 | | | | | | | | 74 |
| 76 | 96.52 | 3.800 | 93.98 | 3.700 | 91.44 | 3.600 | 015-91-1768 | | | | | | | | 76 |
| 78 | 99.06 | 3.900 | 96.52 | 3.800 | 93.98 | 3.700 | 015-91-1788 | | | | | | | | 78 |
| 80 | 101.60 | 4.000 | 99.06 | 3.900 | 96.52 | 3.800 | 015-91-1808 | | | | | | | | 80 |
| 82 | 104.14 | 4.100 | 101.60 | 4.000 | 99.06 | 3.900 | 71308-6082 | | | | | | | | 82 |
| 84 | 106.68 | 4.200 | 104.14 | 4.100 | 101.60 | 4.000 | 71308-6084 | | | | | | | | 84 |
| 86 | 109.22 | 4.300 | 106.68 | 4.200 | 104.14 | 4.100 | 71308-6086 | | | | | | | | 86 |
| 88 | 111.76 | 4.400 | 109.22 | 4.300 | 106.68 | 4.200 | 71308-6088 | | | | | | | | 88 |
| 90 | 114.30 | 4.500 | 111.76 | 4.400 | 109.22 | 4.300 | 71308-6090 | | | | | | | | 90 |
| 92 | 116.84 | 4.600 | 114.30 | 4.500 | 111.76 | 4.400 | 71308-6092 | | | | | | | | 92 |
| 94 | 119.38 | 4.700 | 116.84 | 4.600 | 114.30 | 4.500 | 71308-6094 | | | | | | | | 94 |
| 96 | 121.92 | 4.800 | 119.38 | 4.700 | 116.84 | 4.600 | 71308-6096 | | | | | | | | 96 |
| 98 | 124.46 | 4.900 | 121.92 | 4.800 | 119.38 | 4.700 | 71308-6098 | | | | | | | | 98 |
| 100 | 127.00 | 5.000 | 124.46 | 4.900 | 121.92 | 4.800 | 71308-6100 | | | | | | | | 100 |

SHORT PEG VERSION (.055")

| | | | | | | | | | |
|--|---------------------|--|--|---|--|------------------|--------------|------------------------|--|
| SEE SHEET 1 DEC NO: UCP2014-4901 DRWING IPER 2015/08/12 CHK DRWING IEN 2015/08/12 APPR: SMITH 2015/09/10 DESCRIPTION: | QUALITY SYMBOLS | GENERAL TOLERANCES (UNLESS SPECIFIED) | | DIMENSION STYLE | | SCALE | DESIGN UNITS | THIRD ANGLE PROJECTION | |
| | | | | MM/IN | | | INCH | | |
| | | | | DRAWN BY DATE | | TITLE | | | |
| | | | | CHECKED BY DATE | | | | | |
| | | APPROVED BY DATE | | | | | | | |
| | | MATERIAL NO. | | DOCUMENT NO. | | | | | |
| | | ANGULAR ±1/2° | | SEE TABLE | | SD-71308-001 | | | |
| | | DRAFT WHERE APPLICABLE MUST REMAIN WITHIN DIMENSIONS | | THIS DRAWING CONTAINS INFORMATION THAT IS PROPRIETARY TO MOLEX INCORPORATED AND SHOULD NOT BE USED WITHOUT WRITTEN PERMISSION | | SHEET NO. 5 OF 6 | | | |

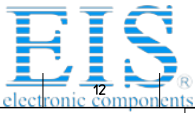

PEG-OPTION

Table with columns for NO PEG VERSION, LONG PEG VERSION (130'), and SHORT PEG VERSION (.055'). Includes sub-headers for PACKAGING, DIMENSIONS, and CKTS.

Technical drawing area containing: SEE SHEET 1, DIMENSION STYLE (MM/IN), SCALE, DESIGN UNITS (INCH), THIRD ANGLE PROJECTION, SALES ASSY INSULATOR DUAL ROW SMT W/BREAK-OFF .025SQ PIN GULLWING .100, molex logo, SD-71308-001, and SHEET NO. 6 OF 6.