

Excellent Integrated System Limited

Stocking Distributor

Click to view price, real time Inventory, Delivery & Lifecycle Information:

[Amphenol RF](#)
[112599](#)

For any questions, you can email us directly:

sales@integrated-circuit.com

1. IMPEDANCE: 50 OHM
2. FREQUENCY RANGE: DC 0-6 GHZ
3. DIELECTRIC WITHSTANDING VOLTAGE: 1000 VRMS, MIN.
4. DURABILITY: 500 CYCLES MIN.
5. TEMPERATURE RANGE: -65°C TO +165°C
6. CRIMPED FERRULE
HEX. CRIMP SIZE .213"
7. CONTACT PIN TO SOLDER

REV.	DATE	ECR NO.	DESCRIPTION
NC	08/03/98	XXXX	INITIAL RELEASE
A	01/30/07	XXXX	UPDATE DRAWING FORMAT
B	02/19/13	2447	CORRECT FERRULE DIMENSIONS, UPDATE DRAWING FORMAT

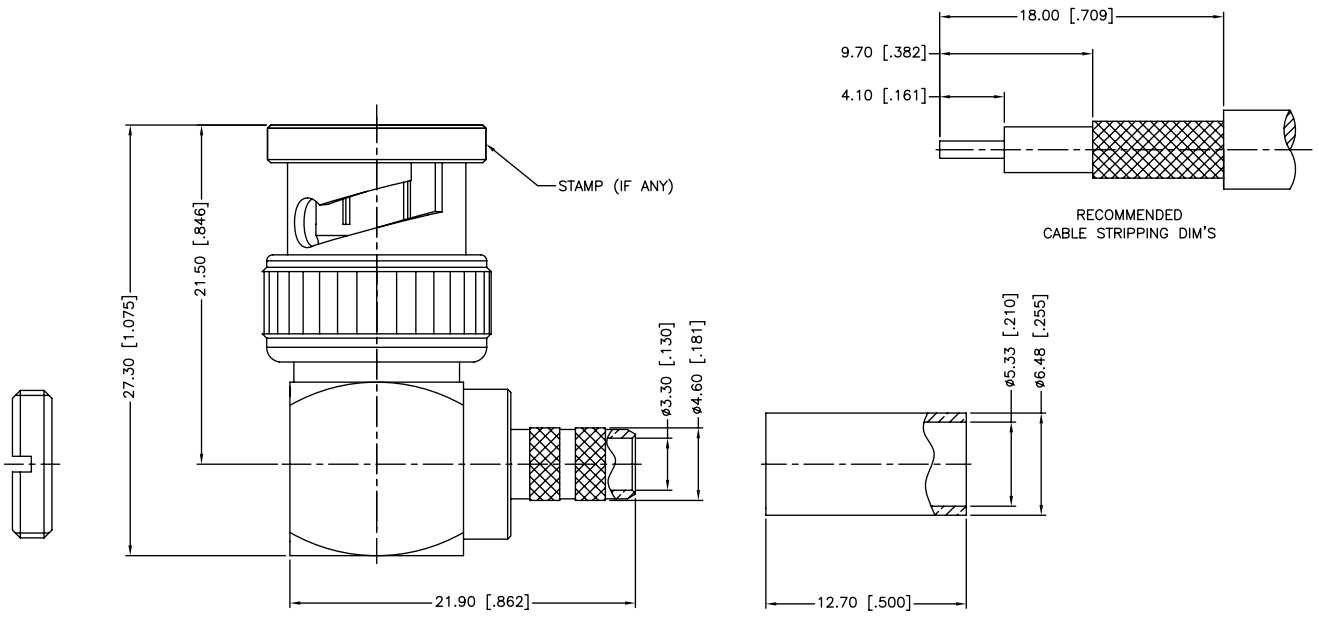

DESCRIPTION	MATERIAL	FINISH	QTY	UNLESS OTHERWISE SPECIFIED DIMENSIONS ARE IN MILLIMETERS. DIMENSIONS IN [] ARE IN INCHES AND FOR CUSTOMER REFERENCE ONLY.	APPROVALS	DATE	<h2 style="text-align: center;">Amphenol Connex</h2>
5	NUT	BRASS	NICKEL	1	DRAWN	S.LI	
4	FERRULE	BRASS	NICKEL	1	CHECKED		
3	INSULATOR	PTFE	NATURAL	1	ISSUED		
2	BODY	BRASS	NICKEL	1	SHEET	1 OF 1	
1	CONTACT PIN	BRASS	GOLD	1			
				<small>UNLESS OTHERWISE SPECIFIED DIMENSIONS ARE IN MILLIMETERS. DIMENSIONS IN [] ARE IN INCHES AND FOR CUSTOMER REFERENCE ONLY.</small> <small>UNLESS OTHERWISE SPECIFIED TOLERANCES FOR MILLIMETERS ARE:</small> <small><0.5 ± 0.05mm</small> <small>0.5 - 6mm ± 0.10mm</small> <small>6 - 30mm ± 0.20mm</small> <small>30 - 120mm ± 0.30mm</small> <small>ANGLES ± 1°</small> <small>UNLESS OTHERWISE SPECIFIED TOLERANCES FOR INCHES ARE:</small> <small>.020 - .236 ± 0.002"</small> <small>.236 - 1.180 ± 0.007"</small> <small>1.180 - 4.724 ± 0.012"</small> <small>ANGLES ± 1°</small>			PART DESCRIPTION BNC R/A CRIMP PLUG (FOR LMR200 CABLE)
				DO NOT SCALE DRAWING	CAD FILE C:/CONNEX/112599.DWG		PART NO. 112599
					DWG. NO.	112599.DWG	REV. B SIZE A SCALE NA