

Excellent Integrated System Limited

Stocking Distributor

Click to view price, real time Inventory, Delivery & Lifecycle Information:

[Molex Connector Corporation](#)
[0026603030](#)

For any questions, you can email us directly:

sales@integrated-circuit.com

| CKT | DIM. A | DIM. B |
|-----|--------|------------|
| 2 | 7.77 | 3.96±0.05 |
| | 3.06 | .56±.002 |
| 3 | 11.73 | 7.92±0.08 |
| | .462 | .312±.003 |
| 4 | 15.70 | 11.89±0.08 |
| | .618 | .468±.003 |
| 5 | 19.66 | 15.85±0.10 |
| | .774 | .624±.004 |
| 6 | 23.62 | 19.81±0.10 |
| | .930 | .780±.004 |
| 7 | 27.58 | 23.77±0.10 |
| | 1.086 | .936±.004 |
| 8 | 31.55 | 27.74±0.13 |
| | 1.242 | 1.092±.005 |
| 9 | 35.51 | 31.70±0.13 |
| | 1.398 | 1.248±.005 |
| 10 | 39.47 | 35.66±0.13 |
| | 1.554 | 1.404±.005 |
| 11 | 43.43 | 39.62±0.15 |
| | 1.710 | 1.560±.006 |
| 12 | 47.40 | 43.59±0.15 |
| | 1.866 | 1.716±.006 |
| 13 | 51.36 | 47.55±0.15 |
| | 2.022 | 1.872±.006 |
| 14 | 55.32 | 51.51±0.18 |
| | 2.178 | 2.028±.007 |
| 15 | 59.28 | 55.47±0.18 |
| | 2.334 | 2.184±.007 |
| 16 | 63.25 | 59.44±0.18 |
| | 2.490 | 2.340±.007 |
| 17 | 67.21 | 63.40±0.20 |
| | 2.646 | 2.496±.008 |
| 18 | 71.17 | 67.36±0.20 |
| | 2.802 | 2.652±.008 |

- NOTES:
 1. MATERIAL: HEADER-GLASS FILLED POLYESTER, 94V-0, MOLDED NATURAL (WHITE).
 2. FINISH:
 (154) OVERALL TIN: 0.00254/.000100 MIN OVER 0.00127/.000050 MIN NICKEL.
 (197) OVERALL REFLOWED MATTE TIN: 0.00152/.000060 MIN.
 OVER 0.00127/.000050 MIN. NICKEL OVERALL.
 (208) SELECT GOLD: 0.00038/.000015 MIN, SELECT TIN: 0.00254/.000100 MIN.
 OVERALL NICKEL UNDERPLATE: 0.00127/.000050 MIN.
 (228) SELECT GOLD: 0.00076/.000030 MIN, SELECT TIN: 0.00254/.000100 MIN.
 OVERALL NICKEL UNDERPLATE: 0.00127/.000050 MIN.
 (241) SELECT GOLD: 0.00051/.000020 MIN.
 SELECT TIN: 0.00254/.000100 MIN.
 OVERALL NICKEL UNDERPLATE: 0.00127/.000050 MIN.
 3. PRODUCT SPECIFICATION AND PROCESS PARAMETERS: SEE PS-08-50.
 4. PACKAGING: SEE CHART
 5. SOLDERABILITY: PER SMES-152.
 6. PIN PUSH-OUT FORCE: PRIOR TO SOLDERING, A 3 LB. MINIMUM FORCE (IN EITHER DIRECTION)
 7. PARTS ARE STACKABLE END TO END ON 3.96/.156 CENTERS.
 8. THIS PART CONFORMS TO CLASS B REQUIREMENTS OF COSMETIC SPECIFICATION PS-45499-002.

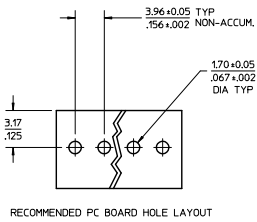
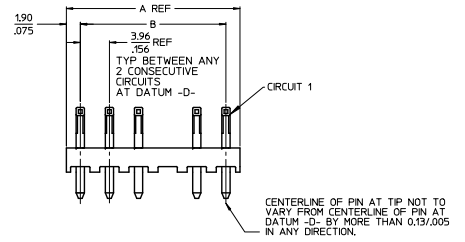
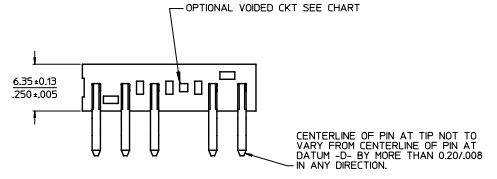
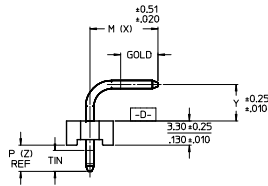
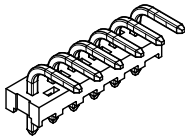

| | |
|-------|-----|
| 2-* | M1 |
| 1 | M1 |
| SHEET | REV |

| | |
|------------------------|-----------------|
| ADD: 41772-0682 | QUALITY SYMBOLS |
| EC NO: IUCP2012-3876 | ▽=0 |
| DRAWN/PPR: 2012/05/25 | ▽=0 |
| CHKD/BEL: 2012/05/25 | ▽=0 |
| APPR/SMITH: 2012/06/20 | |
| DESCRIPTION | |
| M1 | REV |

| | GENERAL TOLERANCES (UNLESS SPECIFIED) | |
|----------|---------------------------------------|--------|
| | mm | INCH |
| 4 PLACES | ± .010 | ± .004 |
| 3 PLACES | ± .015 | ± .005 |
| 2 PLACES | ± .025 | ± .010 |
| 1 PLACE | ± .038 | ± .015 |
| ANGULAR | | ± 1/2° |

DRAFT WHERE APPLICABLE MUST REMAIN WITHIN DIMENSIONS

| DIMENSION STYLE | | SCALE | DESIGN UNITS | THIRD ANGLE PROJECTION |
|-----------------|----------|--------------------------|--------------|------------------------|
| MM/IN | | 2:1 | INCH | |
| DRAWN BY | DATE | TITLE | | |
| SCHAFFER | 11-19-03 | KK 156 HEADER ASSEMBLY | | |
| CHECKED BY | DATE | FLAT RIGHT ANGLE | | |
| SAMIEC | 11-21-03 | SOLID BODY W/O PEGS | | |
| APPROVED BY | DATE | Molex MOLEX INCORPORATED | | |
| MARGULIS | 11-25-03 | DOCUMENT NO. SDA-41772 | | |
| MATERIAL NO. | | SHEET NO. | | |
| SEE CHART | | 1 OF * | | |

| | |
|---|--|
| THIS DRAWING CONTAINS INFORMATION THAT IS PROPRIETARY TO MOLEX INCORPORATED AND SHOULD NOT BE USED WITHOUT WRITTEN PERMISSION | |
|---|--|