

## Excellent Integrated System Limited

Stocking Distributor

Click to view price, real time Inventory, Delivery & Lifecycle Information:

[Molex Connector Corporation](#)  
[0038005931](#)

For any questions, you can email us directly:

[sales@integrated-circuit.com](mailto:sales@integrated-circuit.com)

10 9 8 7 6 5 4 3 2 1

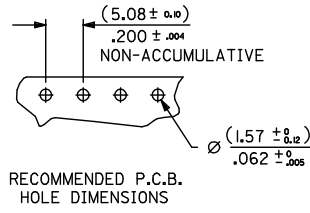
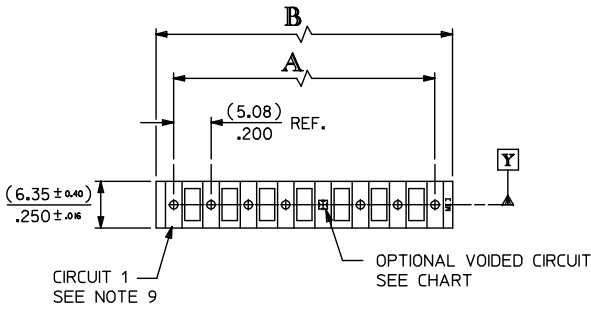

No OF CCTS.	DIMn. A	DIMn. B
2	( 5.08 ± 0.05 ) .200 ± 0.002	( 9.91 ± 0.15 ) .390 ± 0.006
3	( 10.16 ± 0.08 ) .400 ± 0.003	( 14.99 ± 0.15 ) .590 ± 0.006
4	( 15.24 ± 0.08 ) .600 ± 0.003	( 20.07 ± 0.18 ) .790 ± 0.007
5	( 20.32 ± 0.08 ) .800 ± 0.003	( 25.15 ± 0.20 ) .990 ± 0.008
6	( 25.40 ± 0.10 ) 1.000 ± 0.004	( 30.23 ± 0.23 ) 1.190 ± 0.009
7	( 30.48 ± 0.13 ) 1.200 ± 0.005	( 35.31 ± 0.25 ) 1.390 ± 0.010
8	( 35.56 ± 0.20 ) 1.400 ± 0.008	( 40.39 ± 0.28 ) 1.590 ± 0.011
9	( 40.64 ± 0.20 ) 1.600 ± 0.008	( 45.47 ± 0.30 ) 1.790 ± 0.012
10	( 45.72 ± 0.20 ) 1.800 ± 0.008	( 50.55 ± 0.30 ) 1.990 ± 0.012
11	( 50.80 ± 0.20 ) 2.000 ± 0.008	( 55.63 ± 0.33 ) 2.190 ± 0.013
12	( 55.88 ± 0.25 ) 2.200 ± 0.010	( 60.71 ± 0.33 ) 2.390 ± 0.013

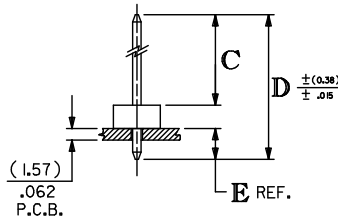
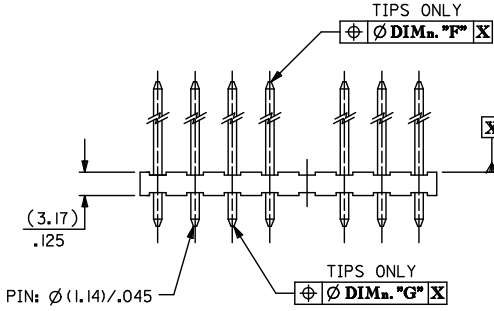

3003-N \* - \*  
 BASE No.      \*      \*  
 No. OF CCTS.      \*      \*  
 VERSION      \*      \*  
 VOID CODE NO. CORRESPONDS TO CIRCUIT NO. VOIDED. MULTIPLE VOIDS START WITH 51.

- NOTES:  
 1. MATERIAL: WAFER: NYLON UL94V-2, COLOR: NATURAL  
 PINS: BRASS  
 2. FINISH: (222) = OVERALL MATTE TIN, (0.00254)/.000100 MIN. OVER (0.00127)/.000050 MIN. NICKEL  
 3. PRODUCT SPECIFICATION: PS-99020-0087  
 4. PIN PUSH OUT FORCE: (1.36KG)/3LBS MIN.  
 5. PIN MUST MEET MOLEX SOLDERABILITY SPEC. ES-152.  
 6. MAX. BOW: (0.38)/.015 OVER (25.4)/1.00  
 7. FOR DIMENSIONS "C", "D", "E", "F" AND VERSIONS, SEE CHARTS ON SHEET 2 AND SUBSEQUENT SHEETS.  
 8. FOR VERSIONS WITH VOIDS, SEE SHEET 4.  
 9. CIRCUIT 1 IS USED TO DEFINE VOID LOCATION. CIRCUIT 1 MAY OR MAY NOT LINE UP WITH CIRCUIT 1 ON MATING PART.  
 10. THIS PART CONFORMS TO CLASS B REQUIREMENTS OF COSMETIC SPECIFICATION PS-45499-002.

REVISION	DESCRIPTION	QUALITY SYMBOLS	GENERAL TOLERANCES (UNLESS SPECIFIED)		DIMENSION STYLE MM/IN	SCALE 2:1	DESIGN UNITS METRIC	THIRD ANGLE PROJECTION
			mm	INCH				
REMOVE AE-3003-NC			4 PLACES ±	±				
FEC NO: UCP2013-0223	2012/06/08		3 PLACES ±	±.010				
DRN:MINSTROH	2012/07/18		2 PLACES ±	±.014				
CHK:KHIPPER	2012/07/18		1 PLACE ±	±.035				
APP:FSMITH	2012/07/25		0 PLACE ±	±				
BP1			ANGULAR ±---° DRAFT WHERE APPLICABLE MUST REMAIN WITHIN DIMENSIONS		SEE CHART			
			MATERIAL NO.		SDAE-3003-N*			
			DOCUMENT NO.					
			SHEET NO.		1 OF 4			

9 8 7 6 5 4 3 2 1

10 9 8 7 6 5 4 3 2 1

INDEX# FOR FULL DIMENSIONS SEE RELEVANT SHEET.

ENG. No.	PLATING	DIM. C	DIM. D	SHT. No.
AE-3003-NA	( 222 )	(11.94) / .470	(19.05) / .750	3
AE-3003-NB	( 222 )	(16.69) / .657	(23.80) / .937	3
AE-3003-NI	( 222 )	(13.51) / .532	(20.32) / .800	3

FOR VOID VERSIONS SEE SHEET 4.

SEE SHEET 1 SEC. NO: UCP2013-0223 DRAWN: MMSTROH 2012/06/08 CHECKED: KIPPER 2012/07/18 APPROVED: SMITH 2012/07/25 BP1 REV	QUALITY SYMBOLS	GENERAL TOLERANCES (UNLESS SPECIFIED)		DIMENSION STYLE MM/IN		SCALE 1:1	DESIGN UNITS METRIC	THIRD ANGLE PROJECTION
		mm	INCH	DRAWN BY DBYRNES	DATE 02/11/22	TITLE KK (5.08)/.200 VERTICAL HEADER ASSEMBLY ROUND PIN		
		4 PLACES ± --- ± ---	3 PLACES ± --- ± .010	CHECKED BY BMAGUIRE	DATE 02/11/22	<b>molex</b>		
		2 PLACES ± 0.25 ± .014	1 PLACE ± 0.35 ± ---	APPROVED BY FSMITH	DATE 2010/12/06			
	ANGULAR ± --- °	DRAFT WHERE APPLICABLE MUST REMAIN WITHIN DIMENSIONS		MATERIAL NO. SEE CHART	THIS DRAWING CONTAINS INFORMATION THAT IS PROPRIETARY TO MOLEX INCORPORATED AND SHOULD NOT BE USED WITHOUT WRITTEN PERMISSION			

9 8 7 6 5 4 3 2 1

	10	9	8	7	6	5	4	3	2	1	
ENG. NO.	AE-3003-NA		AE-3003-NB		AE-3003-NI						
DIMN. *C*	(11.94 ±0.51) .470 ±.020		(16.69 ±0.51) .657 ±.020		(13.51 ±0.51) .532 ±.020						
DIMN. *D*	(19.05) / .750		(23.80) / .937		(20.32) / .800						
DIMN. *E*	(3.94) / .155		(3.94) / .155		(3.63) / .143						
DIMN. *F*	(1.02) / .040		(1.02) / .040		(1.02) / .040						
DIMN. *G*	(1.02) / .040		(1.02) / .040		(1.02) / .040						
PLATING	(222)		(222)		(222)						
	PART NO.	ENG NO.	PART NO.	ENG NO.	PART NO.	ENG NO.					
NO. OF CIRCUITS	2	10-08-1021	AE-3003-2A	10-08-1022	AE-3003-2B	10-08-1029	AE-3003-2I				
	3	▲ -1031	▲ -3A	▲ -1032	▲ -3B	▲ -1039	▲ -3I				
	4	▲ -1041	▲ -4A	▲ -1042	▲ -4B	▲ -1049	▲ -4I				
	5	▲ -1051	▲ -5A	▲ -1052	▲ -5B	▲ -1059	▲ -5I				
	6	▲ -1061	▲ -6A	▲ -1062	▲ -6B	▲ -1069	▲ -6I				
	7	▲ -1071	▲ -7A	▲ -1072	▲ -7B	▲ -1079	▲ -7I				
	8	▲ -1081	▲ -8A	▲ -1082	▲ -8B	▲ -1089	▲ -8I				
	9	▲ -1091	▲ -9A	▲ -1092	▲ -9B	▲ -1099	▲ -9I				
	10	▲ -1101	▲ -10A	▲ -1102	▲ -10B	▲ -1109	▲ -10I				
	11	▼ -1111	▼ -11A	▼ -1112	▼ -11B	▼ -1119	▼ -11I				
	12	10-08-1121	AE-3003-12A	10-08-1122	AE-3003-12B	10-08-1129	AE-3003-12I				

QUALITY SYMBOLS	▽=0	GENERAL TOLERANCES (UNLESS SPECIFIED)	DIMENSION STYLE		DRAWN BY	DATE	SCALE	DESIGN UNITS	THIRD ANGLE PROJECTION
	▽=0		mm	INCH					
DESCRIPTION	▽=0	4 PLACES ± --- ± ---	DBYRNES		02/11/22		TITLE KK (5.08)/.200 VERTICAL HEADER ASSEMBLY ROUND PIN 		
	▽=0	3 PLACES ± --- ± .010	CHECKED BY		DATE				
	▽=0	2 PLACES ± 0.25 ± .014	BMAGUIRE		02/11/22				
	▽=0	1 PLACE ± 0.35 ± ---	APPROVED BY		DATE				
	▽=0	0 PLACE ± ±	FSMITH		2010/12/06		MATERIAL NO. DOCUMENT NO. SHEET NO. SEE CHART SDAE-3003-N* 3 OF 4		
ANGULAR ± --- °		DRAFT WHERE APPLICABLE		THIS DRAWING CONTAINS INFORMATION THAT IS PROPRIETARY TO MOLEX INCORPORATED AND SHOULD NOT BE USED WITHOUT WRITTEN PERMISSION					
MUST REMAIN WITHIN DIMENSIONS		SIZE B							

10 9 8 7 6 5 4 3 2 1

WAFERS WITH VOIDS#

No. OF CCTS	ENG. NO.	PART NO.	VOID CCT. LOCATION	FOR DIM'ns. SEE WAFER No.	PLATING
3	AE-3003-3A-2	38-00-5931	2	↑ AE-3003-NA ↓ AE-3003-NA	↑ 222 ↓ 222
4	AE-3003-4A-2	38-00-6865	2		
4	AE-3003-4A-51	38-00-0205	2, 3		
6	AE-3003-6A-51	10-08-1067	2, 4, 5		
9	AE-3003-9A-2	10-08-1098	2		
10	AE-3003-10A-2	10-08-1108	2		
12	AE-3003-12A-51	10-08-1128	4, 7		

SEE SHEET 1 ELEC. NO.: JUCP2013-0223 DRAWN BY: DRWINSTROH CHECKED BY: CHKDRKIPPER APPROV: FSMITH	QUALITY SYMBOLS	GENERAL TOLERANCES (UNLESS SPECIFIED)		DIMENSION STYLE MM/IN		SCALE 1:1	DESIGN UNITS METRIC	THIRD ANGLE PROJECTION
	▽=0	4 PLACES	± ---	± ---	DRAWN BY	DATE	KK (5.08)/200 VERTICAL HEADER ASSEMBLY ROUND PIN 	
	▽=0	3 PLACES	± ---	± .010	CHECKED BY	DATE		
	▽=0	2 PLACES	± 0.25	± .014	B MAGUIRE	02/11/22		
▽=0	1 PLACE	± 0.35	± ---	APPROVED BY	DATE			
		0 PLACE	±	±	FSMITH	2010/12/06	MATERIAL NO.	DOCUMENT NO.
		ANGULAR ± ---°		SEE CHART			SDAE-3003-N*	SHEET NO.
		DRAFT WHERE APPLICABLE MUST REMAIN WITHIN DIMENSIONS		SIZE B		THIS DRAWING CONTAINS INFORMATION THAT IS PROPRIETARY TO MOLEX INCORPORATED AND SHOULD NOT BE USED WITHOUT WRITTEN PERMISSION		

9 8 7 6 5 4 3 2 1