

Excellent Integrated System Limited

Stocking Distributor

Click to view price, real time Inventory, Delivery & Lifecycle Information:

[Panduit](#)
[ICFX3EI-X](#)

For any questions, you can email us directly:
sales@integrated-circuit.com

THIS COPY IS PROVIDED ON A RESTRICTED BASIS AND IS NOT TO BE USED IN ANY WAY DETRIMENTAL TO THE INTERESTS OF PANDUIT CORP.

PANDUIT PART NO.	WEIGHT
ICFX3	2.1 LB/100 PCS (935 g/100 PCS)

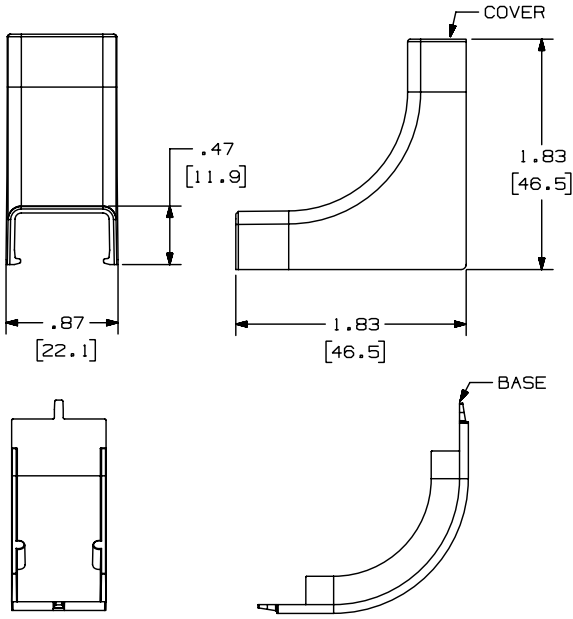

- NOTES:
- SEE CURRENT CATALOG FOR ADDITIONAL PART NUMBER SUFFIXES TO INDICATE COLOR AND OR PACKAGE QUANTITY.
 - THIS PRODUCT IS INTENDED TO BE USED WITH PANDUIT TYPE LD3, LDP3, AND LDS3 RACEWAY.
 - NOMINAL WALL THICKNESSES:
 BASE = .070(1.8)
 COVER = .055(1.4)
 - THIS PRODUCT IS FEATURED WITH THE TIA/EIA COMPLIANT BEND RADIUS.
 - DIMENSIONS IN PARENTHESIS ARE IN METRIC.

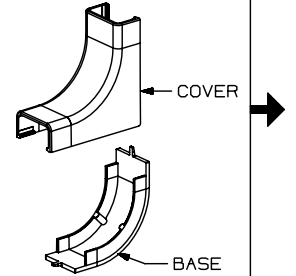

CAD FILENAME/LAYERS D35541CK_LD_ICFX3_02.PRT

PANDUIT CORP. TINLEY PARK, ILLINOIS
 INSIDE CORNER FITTING BASE AND COVER (ICFX3)
 CUSTOMER DRAWING

UNLESS OTHERWISE SPECIFIED, DIMENSIONAL TOLERANCES ARE:
 (.X) ± (.XXX) ±.015 (.4)
 (.XX) ±.03 (.8) ANGLES ±

UNLESS OTHERWISE SPECIFIED, ALL DIMENSIONS ARE GIVEN IN INCHES, THIRD ANGLE PROJECTION.

REV	DATE	BY	CHK	DESCRIPTION	ECN	CHK	CUST	SUP	DRAWN BY	DATE	CHECKED BY	MAT'L:	SCALE	DRAWING NO.	DWG SIZE
2	03-10-04	JHEP	RGRO	C. REMOVED CD3 FROM NOTE 2	35541-37	RGRO	RGRO		JBA	09-23-96	CEF	PVC	NONE	35541-37	A
1	07-06-99	DW	HIW	B. CORRECTED PART GEOMETRY. A. REVISED PICTURE TO SHOW 2D VIEWS.	35541-37	HIW	HIW		JBA	09-23-96	CEF	PVC	NONE	35541-37	A
R	09-23-96	JBA	CEF	RELEASED TO PRODUCTION	35541-37	CEF	CEF		JBA	09-23-96	CEF	PVC	NONE	35541-37	A