

Excellent Integrated System Limited

Stocking Distributor

Click to view price, real time Inventory, Delivery & Lifecycle Information:

[Harting](#)

[09242206824](#)

For any questions, you can email us directly:

sales@integrated-circuit.com

Alle Rechte vorbehalten. All rights reserved.

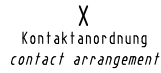
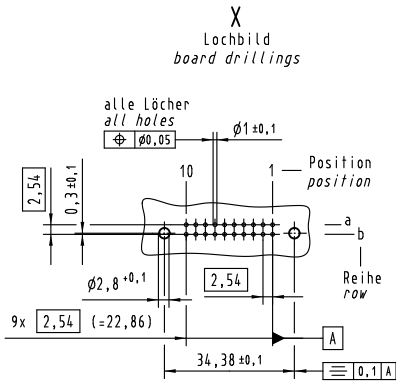

20 Einlötlöt Kontakte
20 solder contacts

- ☒ = Einlötlöt Kontakt
= solder contact
- ☐ = Kontaktposition nicht belegt
= position without contact

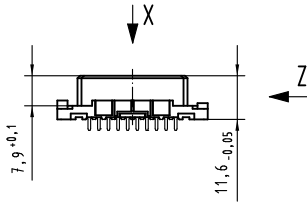

Z (2:1)

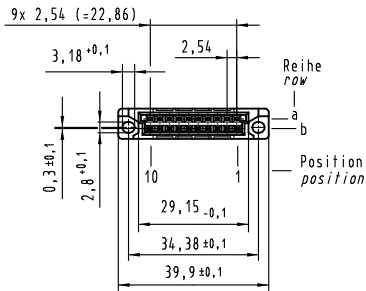
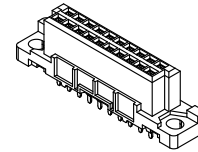
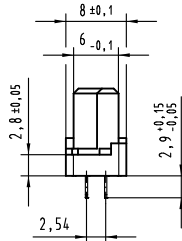

① weitere Informationen siehe: DS 09 03 210 00 01
further information see: DS 09 03 210 00 01

09 24 220 6824	2
Bestell-Nr. part-no.	Anforderungsstufe performance level ①

All Dimensions in mm Original Size DIN A 3			Techn. Character.		Nicht tolerierte Maß/Free size tolerances IEC 60603-2	
Mod.	Dat.	Name	Def.	Name	Maßstab/Scale	
36370	21.07.11	HL.	Defail.	03.02.09 MS	1:1	har-bus 3B Federleiste Einlötlöt 2,9, 20-polig har-bus 3B female connector solder 2,9, 20-pole
35603			Insp.	03.02.09 RA		
			Stand.			
HARTING Electronics GmbH & Co. KG D-32339 ESPELKAMP			HARTING		TB 09 24 220 x824	
						Blatt/page