

Excellent Integrated System Limited

Stocking Distributor

Click to view price, real time Inventory, Delivery & Lifecycle Information:

[Molex Connector Corporation](#)
[0194350814](#)

For any questions, you can email us directly:

sales@integrated-circuit.com

MATERIAL NUMBER	WIRE GAGE	GASKET	KEYING OPTION	COLOR
194350811	16-14	YES	A	BLACK
194350812	22-18	YES	A	BLACK
194350813	16-14	NO	A	BLACK
194350814	22-18	NO	A	BLACK
194350816	16-14	YES	B	GRAY
194350817	22-18	YES	B	GRAY
194350818	16-14	NO	B	GRAY
194350819	22-18	NO	B	GRAY
194350821	16-14	YES	C	BROWN
194350822	22-18	YES	C	BROWN
194350823	16-14	NO	C	BROWN
194350824	22-18	NO	C	BROWN
194350826	16-14	YES	D	GREEN
194350827	22-18	YES	D	GREEN
194350828	16-14	NO	D	GREEN
194350829	22-18	NO	D	GREEN

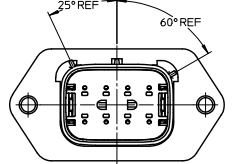
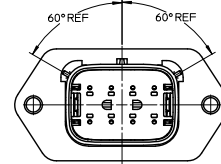
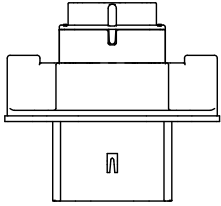
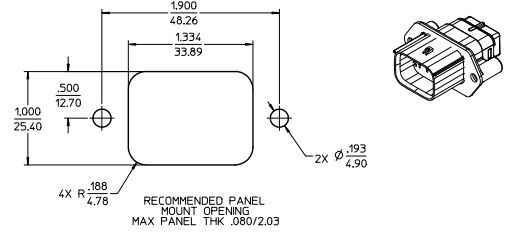

KEY A

KEY B

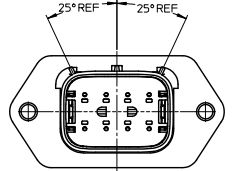
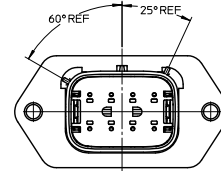
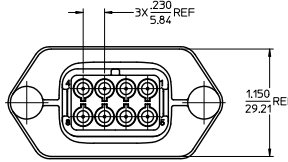
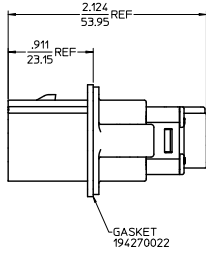
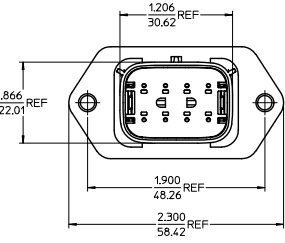

KEY C

KEY D

NOTES:

- MATERIALS:
HOUSING: POLYESTER (PB1), GLASS FILLED, UL94 V-0,
COLOR: SEE CHART
SEAL: SILICONE RUBBER
GASKET: EPDM RUBBER
- PRODUCT SPECIFICATION: PS-19417-001
- PACKAGING SPECIFICATION: PK-19435-001
GASKETS, IF REQUIRED FOR THE ASSEMBLIES,
ARE BULK PACKAGED IN A SEPARATE BAG.
- MATES WITH: 19418 SERIES RECEPTACLE ASSEMBLIES.
- USE CONNECTOR WITH MALE CRIMP TERMINAL, SERIES 19417.
- RECOMMENDED MOUNTING HARDWARE: 12x10 X .62/15.8 LONG PLASTIC
THREAD CUTTING SCREWS, RECOMMENDED TORQUE 15-17 IN.-LBS.
SUGGESTED SOURCE: ITW SHAKEPROOF INDUSTRIAL BOSSCREW OR EQUIVALENT.

QUALITY SYMBOLS	GENERAL TOLERANCES (UNLESS SPECIFIED)		DIMENSION STYLE		SCALE	DESIGN UNITS	THIRD ANGLE PROJECTION
	mm	INCH	IN/MM	INCH			
▽=0	4 PLACES	± .015	JPAWLICKI	DATE	2:1	INCH	8 WAY SEALED PLUG PANEL MOUNT ASSEMBLY, 22-14 AWG, A-D POLARIZATION
▽=0	3 PLACES	± .015	JPAWLICKI	DATE			
	2 PLACES	± 0.38		DATE			
	1 PLACE	± .005		DATE			
	ANGULAR ± 2 °		RDERSOS	DATE			
	DRAFT WHERE APPLICABLE MUST REMAIN WITHIN DIMENSIONS		SEE CHART				
			MOLEX INCORPORATED				
			SD-19435-008				
			1 OF 1				